

FOR LEASE

6731 Collamer Road (NYS Rt. 298) E. Syracuse, NY

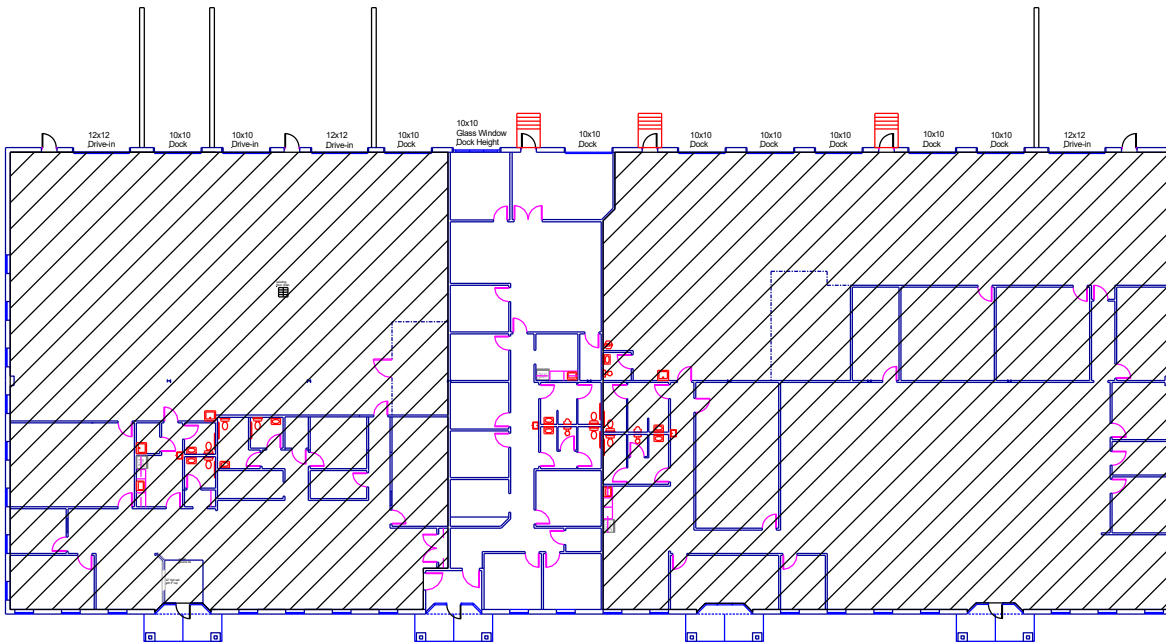

- 3,330 SF Office/Storage/Warehouse Space
- Mostly Office Space Currently
- Two (2) Dock Height Doors
- High Traffic/Retail Exposure



6724 Thompson Road • Syracuse, NY 13211

For more info contact:
Ed Rogers
Phone: 315-463-8684
Cell: 315-427-8510
E-mail: Ed@olivaco.com
www.olivaco.com

All information is believed to be accurate. We are not responsible for misstatements of facts, errors or omissions, prior sales, and changes of price or withdrawal from the market without notice.