



FOR LEASE

Industrial Building

497 Highway 99
Eugene OR 97402

WITH COMMISSARY | WAREHOUSE | OFFICE

- 5,040 square feet plus 625 square feet finished second floor with restroom
- Commissary Room
 - Food grade washable walls
 - HVAC
 - Floor drain
- Warehouse area with 12' x 14' grade loading door
- Abundant power
- Zoned C-2 Community Commercial
- \$8.70 per square foot annual triple net (\$1.50 per square foot annual triple nets)

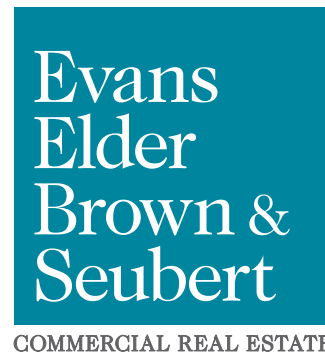

Jeff Elder
jeff@eebcre.com

541.345.4860

Licensed in the State of Oregon.

Overview

497 Highway 99 | Eugene OR 97402

Evans
Elder
Brown &
Seubert

COMMERCIAL REAL ESTATE

CONTACT

Jeff
Elder

jeff@eebcre.com

541.345.4860

Licensed in the
State of Oregon.

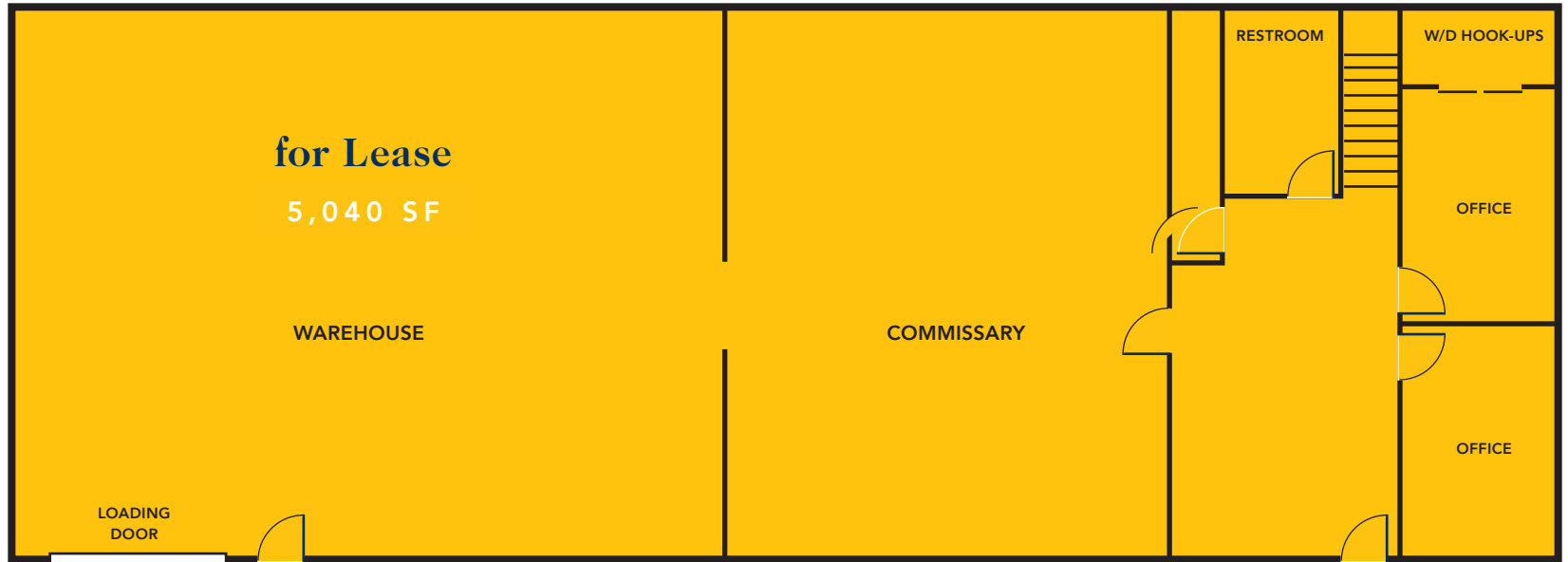

5,040 SQUARE FEET

- WAREHOUSE AREA with 12'x14' loading door
- COMMISSARY ROOM with food grade washable walls, HVAC and floor drain

+ 625 SQUARE FEET

- 2ND FLOOR finished area with restroom



Photographs

497 Highway 99 | Eugene OR 97402

Evans
Elder
Brown &
Seubert

COMMERCIAL REAL ESTATE

CONTACT

Jeff
Elder

jeff@eebcre.com

541.345.4860

Licensed in the
State of Oregon.



Location

497 Highway 99 | Eugene OR 97402

HIGHWAY 99 ACCESIBILITY

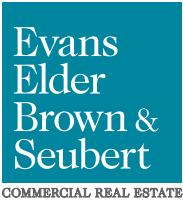
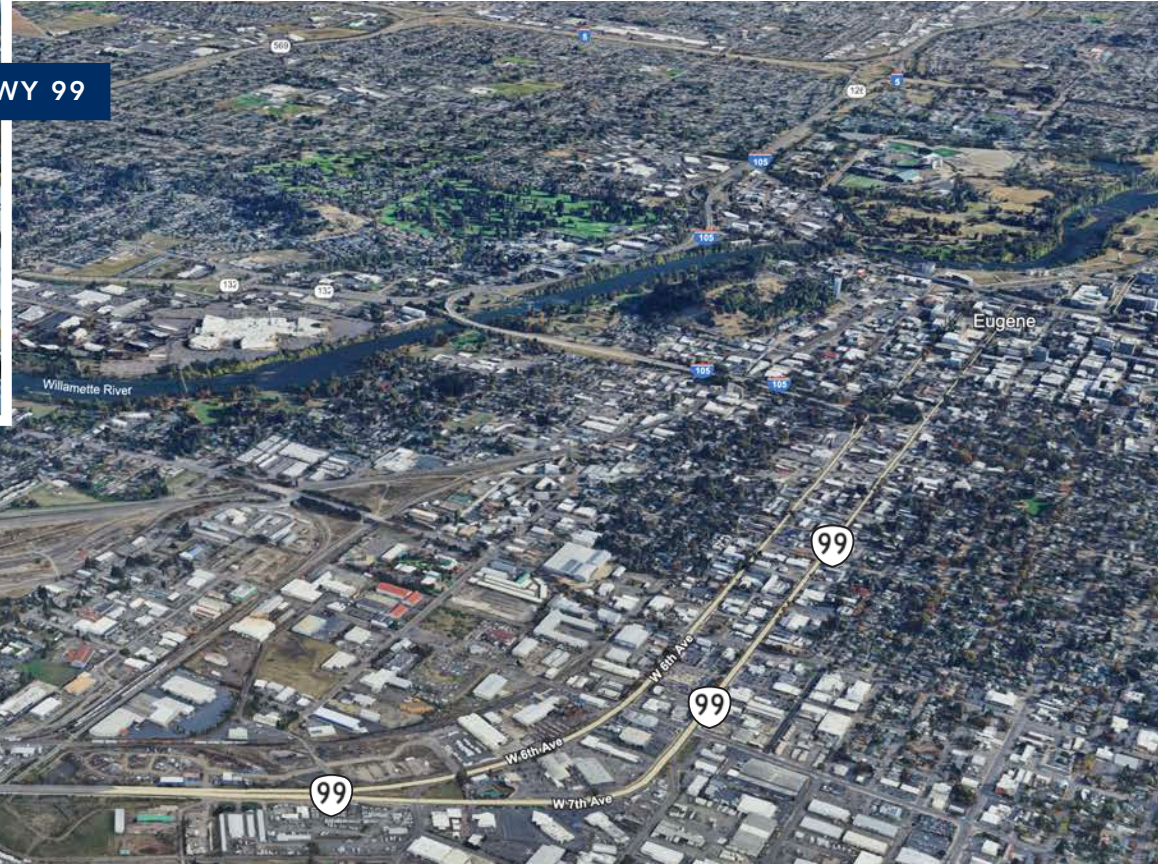

CONTACT

541.345.4860

Jeff Elder

jeff@eebcre.com