

FOR LEASE

250 Diamond Avenue

Spruce Grove, AB



FLEXIBLE OPTIONS TO RECONFIGURE TO SUIT
APPROX. 0.9 ACRES OF FENCED & GATED YARD AVAILABLE

Grant Ranslam
Principal
780.702.5853
grant.ranslam@avisonyoung.com

Bryce Williamson
Principal
587.984.6199
bryce.williamson@avisonyoung.com

**AVISON
YOUNG**

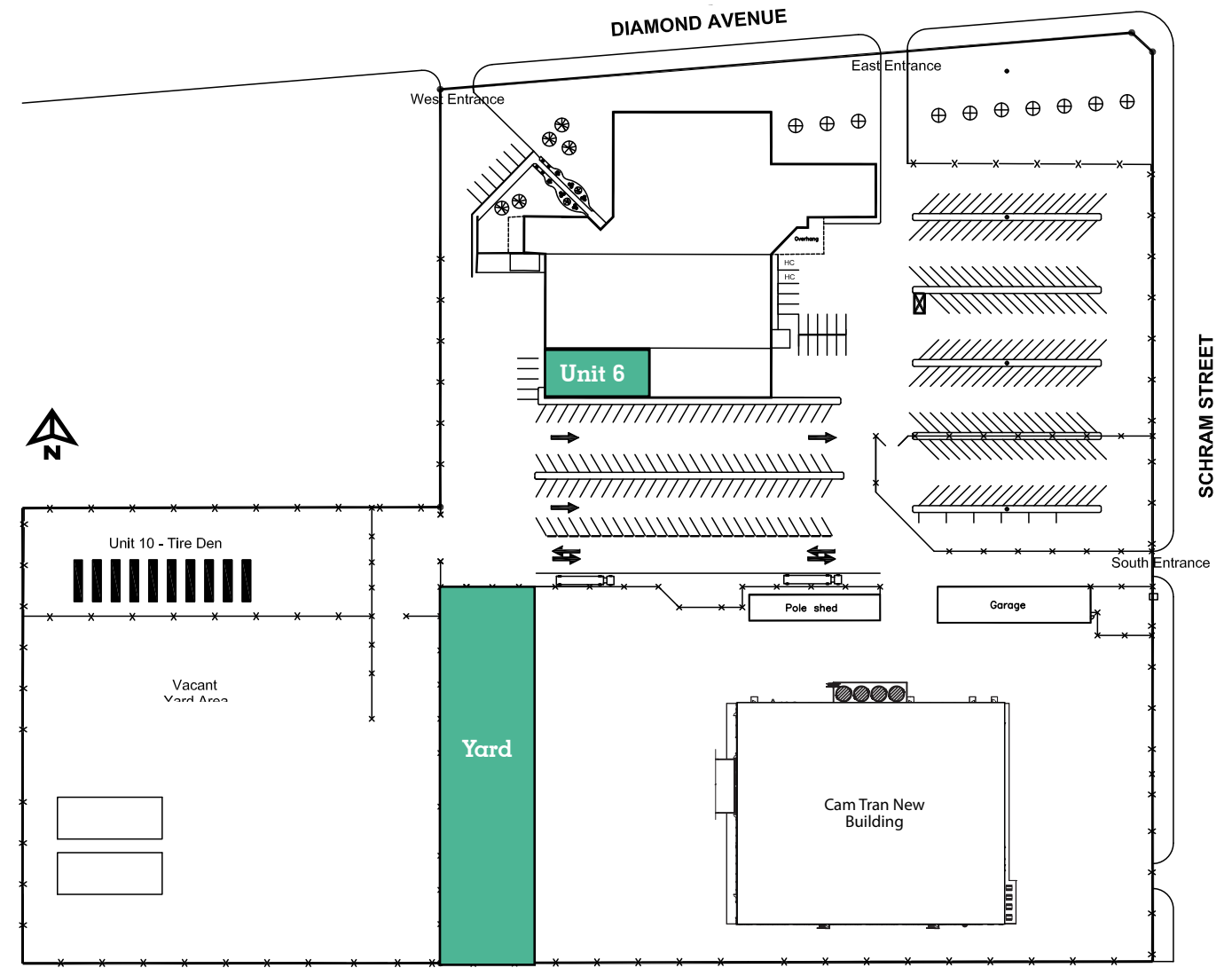
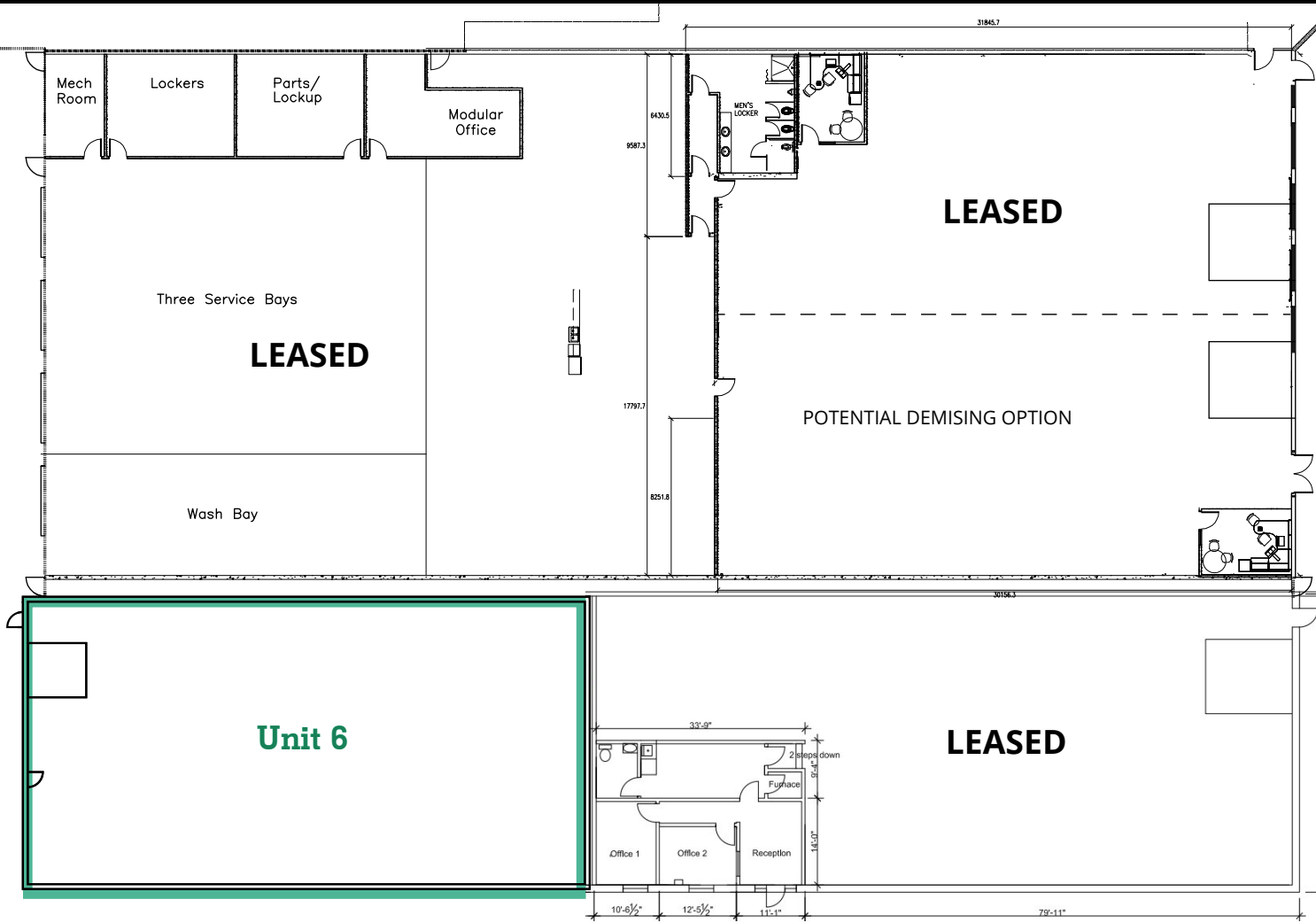

Unit 6

Area Available:	4,900 sf
Zoning:	M1 - General Industrial
Loading:	Grade (1 - 12'x14')
Lease Rate:	\$11.00 psf
Operating Costs:	\$5.60 psf (Common Area)



Grade loading



Competitive land cost base allows for below market lease rates



Excellent access to Diamond Avenue with close proximity to Golden Spike Road, Century Road and Highway 16A

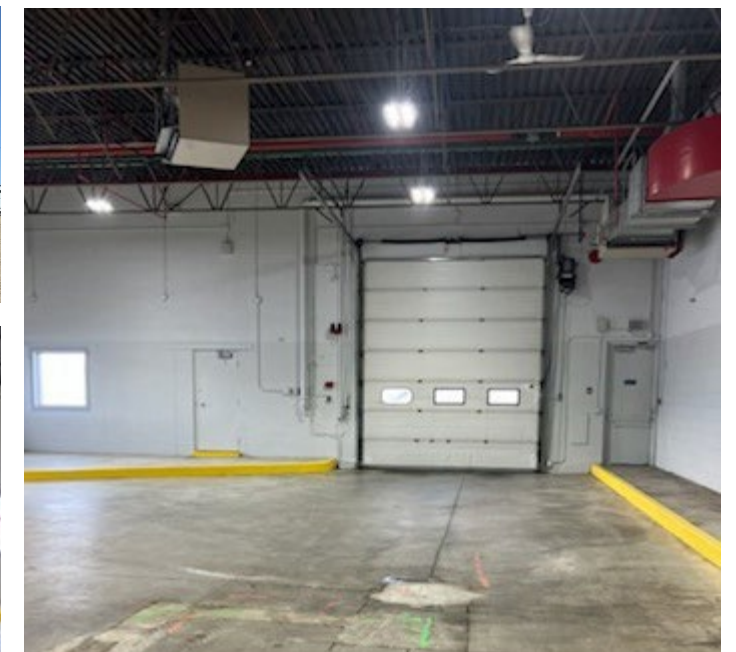

FOR LEASE

250 Diamond Avenue
Spruce Grove, AB



**Get more
information**

Grant Ranslam
Principal
780.702.5853
grant.ranslam@avisonyoung.com

Bryce Williamson
Principal
587.984.6199
bryce.williamson@avisonyoung.com

**AVISON
YOUNG**