

FOR LEASE

# Modern retail/ medical units

18 Inglewood Drive,  
St. Albert, AB



**Arlyn Stoik**  
Principal  
+1 780 429 7552  
arlyn.stoik@avisonyoung.com

**Alison Hansen-Carlson**  
Associate  
+1 780 702 0692  
alison.hansen-carlson@avisonyoung.com

**AVISON  
YOUNG**

# For Lease

18 Inglewood Drive, St. Albert, AB

## Property Details

Modern retail/professional units ranging from 1,200 sf bays to 8,780 sf. The unique design and finishings of Inglewood Drive will provide tenants a premier retail and professional option in St. Albert.

Conveniently located just off of busy St. Albert Trail, the arterial road through St. Albert, with traffic counts of over 23,000 vehicles per day (2019).

## Available Summer 2025



Population  
**54,351**



Median age  
**42.1**



Vehicles per day  
**23,639** (St. Albert Trail)



Average household income  
**\$168,233**

*Demographics: Within 3km, Sitewise  
Traffic: 2019 Average Daily Volume, City of St. Albert*

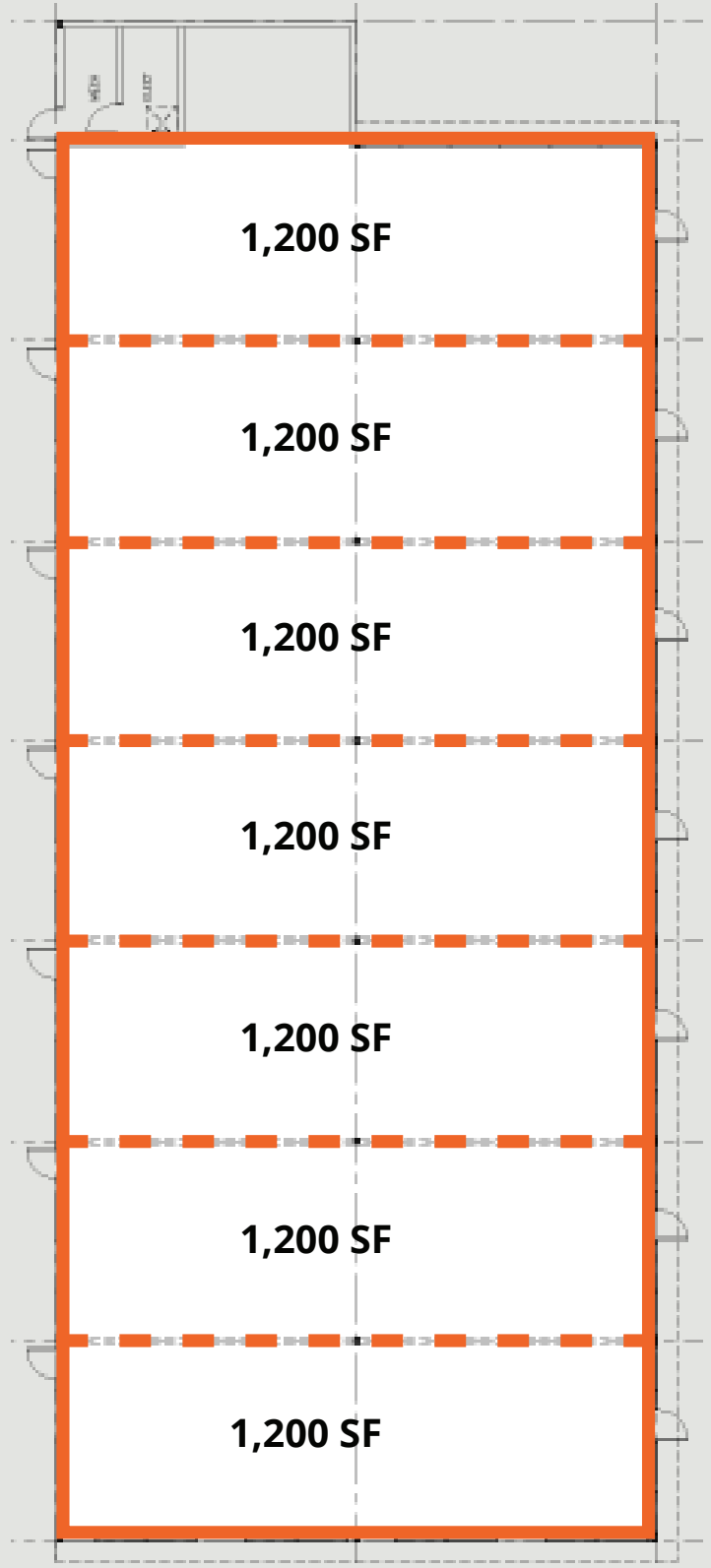
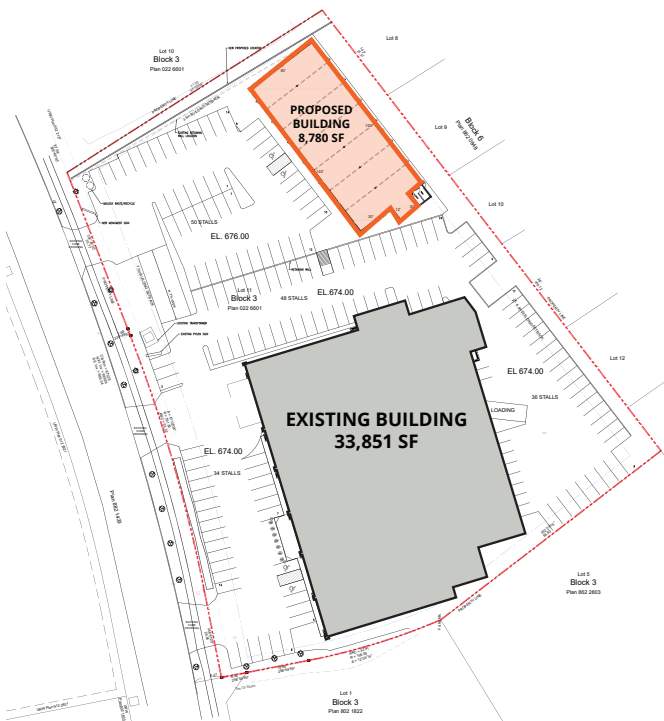

For Lease

18 Inglewood Drive, St. Albert, AB



For Lease

18 Inglewood Drive, St. Albert, AB

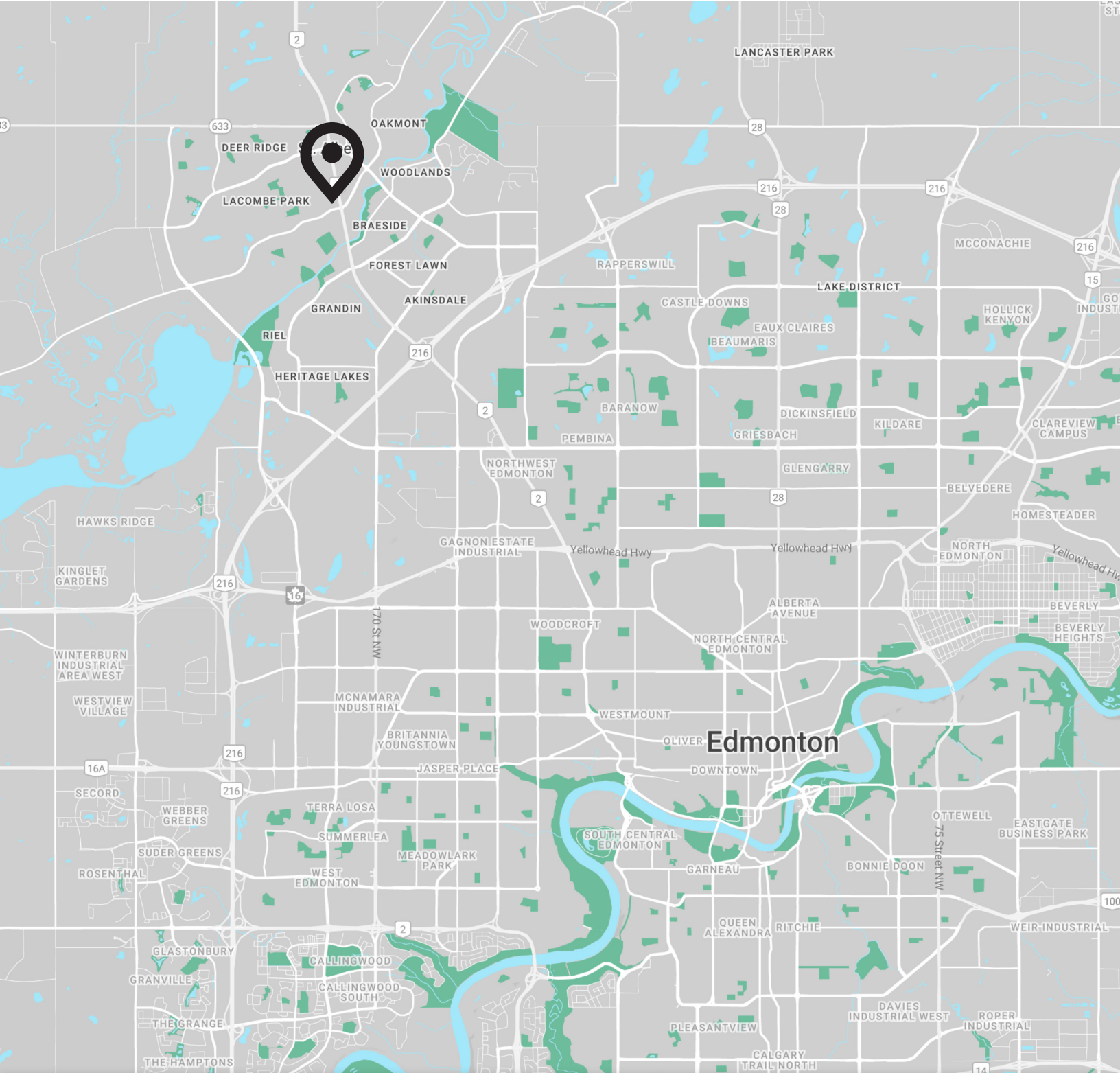

**Get more  
information**

**Arlyn Stoik**  
Principal  
+1 780 429 7552  
arlyn.stoik@avisonyoung.com

**Alison Hansen-Carlson**  
Associate  
+1 780 702 0692  
alison.hansen-carlson@avisonyoung.com

**AVISON  
YOUNG**