

INDUSTRIAL SPACE  
FOR LEASE

# I-25 Corporate Center

460 EAST 76TH AVENUE, BUILDING 4 | DENVER, CO 80229

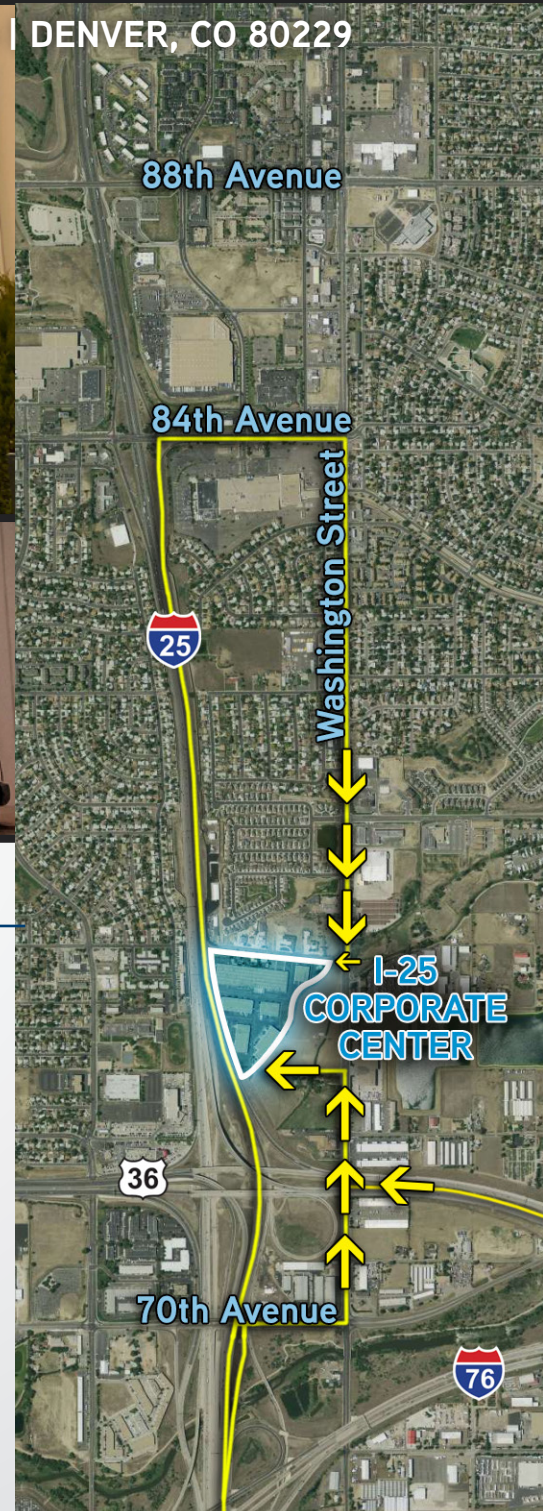

## Building Information

- > Size: Unit B – 19,503 SF
- > Loading: Three (3) Dock High  
One (1) Drive-In (14' x 16')
- > Clear Height: 18'
- > Access: I-25, Boulder Turnpike and US-270
- > Rate: \$10.25/SF NNN
- > 2025 Est. Expenses: \$4.07/SF
- > Electrical: 800 Amps, 120/208V, 3-Phase
- > Zoning: I-2, Unincorporated Adams County  
(Enterprise Zone)
- > Sprinkler: Yes (General Duty)
- > Available Date: Immediately

T.J. SMITH, SIOR  
303 283 4576  
tj.smith@colliers.com

DAVID HAZLETT  
303 283 4573  
david.hazlett@colliers.com

I-25 Corporate Center  
 460 East 76th Avenue  
 Building 4  
 Denver, CO 80229

## Contact Us

4643 South Ulster Street  
 Suite 1000  
 Denver, CO 80237  
 MAIN +1 303 745 5800  
 FAX +1 303 745 5888  
[www.colliers.com/denver](http://www.colliers.com/denver)

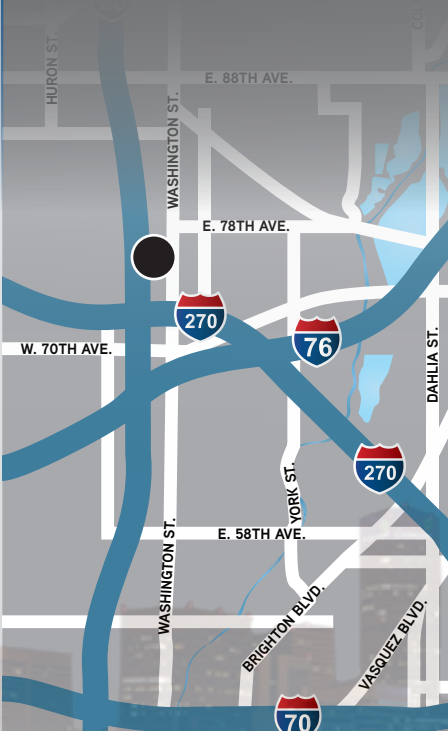
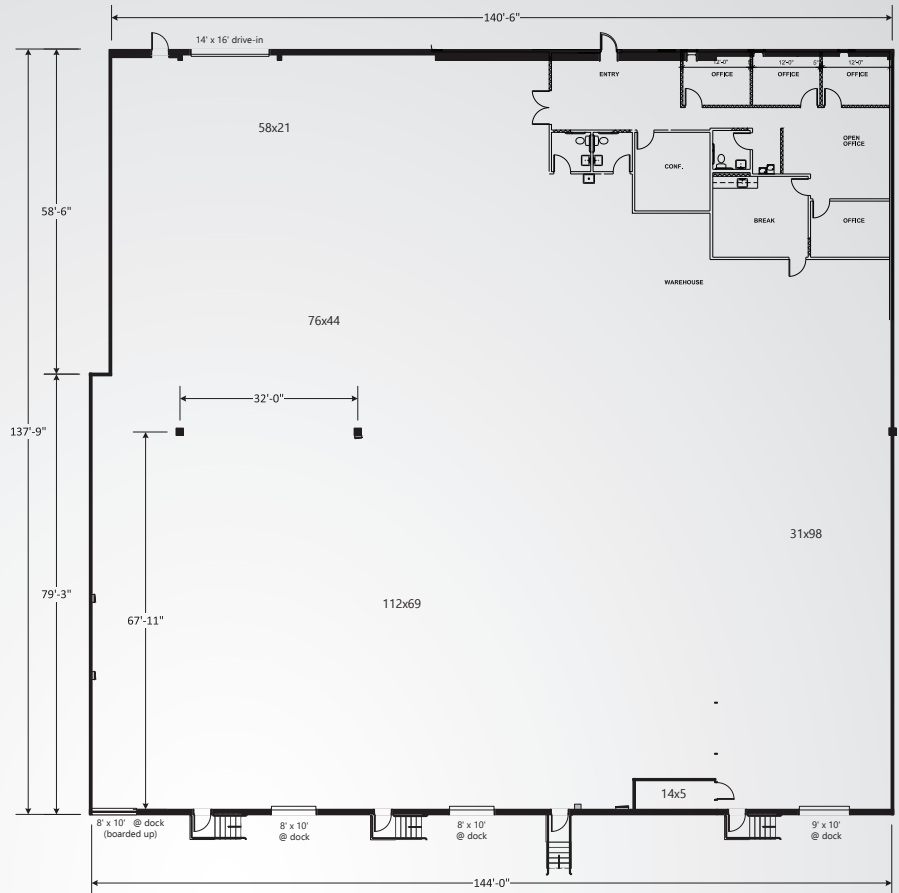

## SITE PLAN

