

FOR LEASE

ALBERNI STREET RESTAURANT/RETAIL OPPORTUNITY

1150 ALBERNI STREET, VANCOUVER, BC



CONTACT US

MARIO NEGRIS PREC
EXECUTIVE VICE PRESIDENT
URBAN PROPERTIES GROUP
+1 604 662 3000
mario.negris@cbre.com

MARTIN MORIARTY
VICE PRESIDENT
URBAN PROPERTIES GROUP
+1 604 662 5123
martin.moriarty@cbre.com

CBRE

WEST GEORGIA STREET



ALBERNI STREET

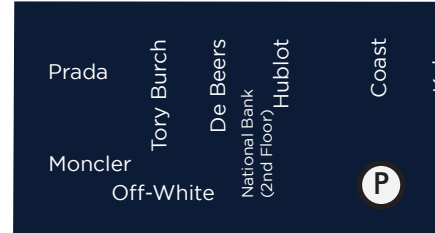
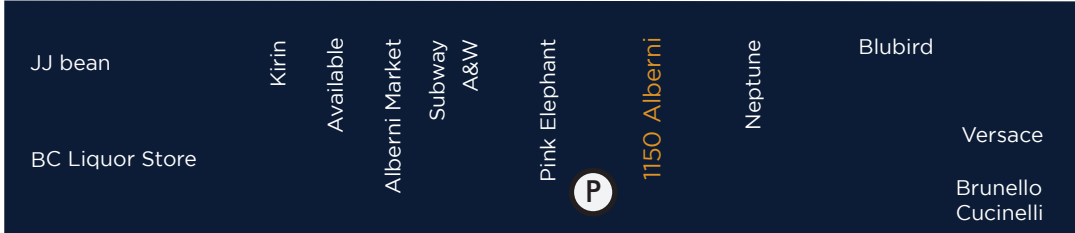

EIHU LANE

LOCATION OVERVIEW

Situated along Alberni Street between Thurlow and Bute Streets, this unit offers prime exposure to pedestrian and vehicular traffic year round. Alberni Street, also known as Vancouver's luxury row, is home to high end fashion retailers such as Rolex, Burberry, Versace, Prada, Moncler, Tiffany & Co., De Beers, Hublot, Van Cleef and many more leading luxury brands.

Robson Street is just one block south. Here you will find most of the major North American fashion brands, along with a lively mix of sporting goods, accessories, homewares, beauty and wellness purveyors.



PROPERTY OVERVIEW

LEASE RATE

\$90.00 per sq. ft.

SIZE*

5,500 sq. ft.

ADDITIONAL RENT*

\$27.00 per sq. ft (estimate)

ZONING**

DD

AVAILABLE

January 1, 2021

FLOOR PLAN

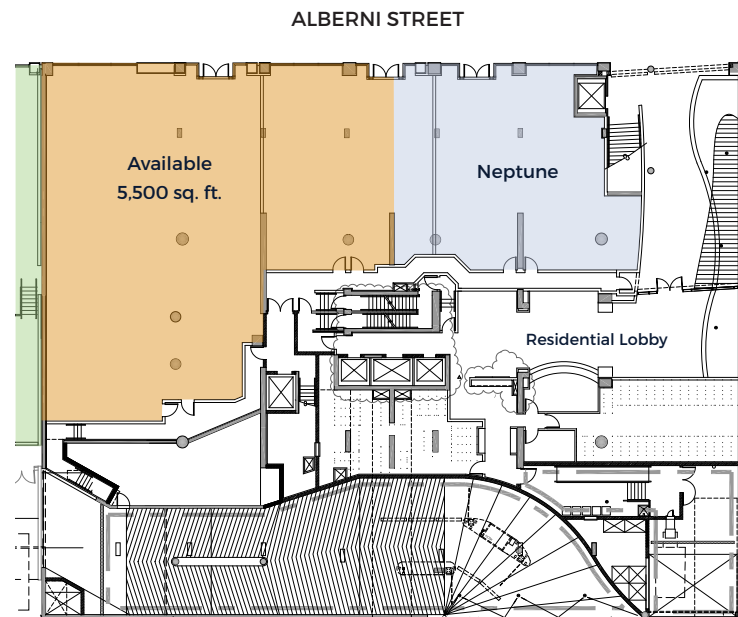

*Approximate and subject to confirmation.

**Tenant is responsible for verifying permissible uses as per the zoning.