

LINDSAY SHELTON
#25068

THIS DOCUMENT IS NOT INTENDED
FOR BIDDING, REGULATORY
APPROVAL, OR CONSTRUCTION

ARCHITECT
SHELTON ARCHITECTURE | DALLAS, LLC
4325 POMONA RD.
DALLAS, TX 75209

Line Table			Curve Table				
Line #	Length	Bearing	Curve #	Length	Radius	Delta	Chord
L1	120.49'	N88°52'26"W	C1	120.15'	435.00'	15°49'29"	N80°57'41"W, 119.76'
L2	104.27'	N73°09'07"W	C2	138.85'	506.00'	15°43'19"	N81°00'46"W, 138.41'
L3	10.06'	S65°39'48"W	C3	154.17'	288.84'	30°34'53"	S78°17'03"W, 152.35'
L4	32.00'	S01°32'59"W	C4	159.92'	321.25'	26°31'20"	N72°16'14"W, 158.28'
L5	49.65'	S24°08'41"E	C5	88.25'	435.00'	11°37'24"	N67°14'14"W, 88.09'
L6	103.49'	S24°09'45"E	C6	207.71'	371.25'	32°03'23"	S74°06'24"E, 205.01'
			C7	103.10'	338.84'	17°26'00"	N84°42'24"E, 102.70'
			C8	75.60'	338.84'	12°47'03"	N69°35'52"E, 75.45'

ZONING DESIGNATION LEGEND

- TRACT 3: PD-B2 - 3.973 ACRES
- TRACT 4: PD-MF & B2 - 11.627 ACRES
- TRACT 5: PD-TH - 6.095 ACRES
- TRACT 6: PD-B2 - 1.05 ACRES

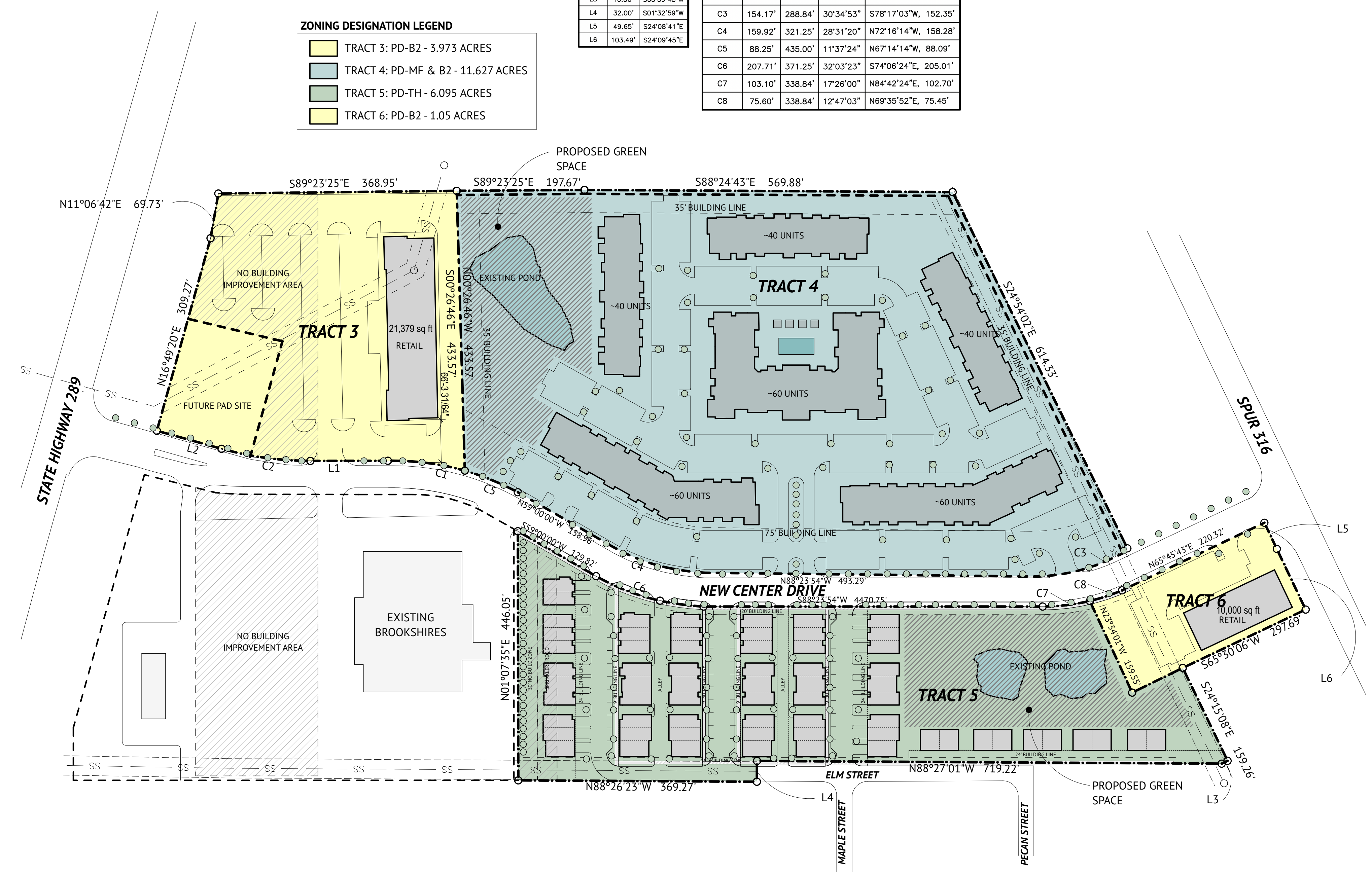

1 SITE PLAN -Conceptual
SCALE: 1" = 100'

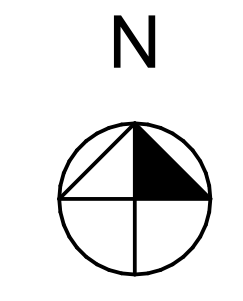

SITE PLAN

NEW CENTER DEVELOPMENT
New Center Drive
Pottsboro, Texas

P&Z SUBMITTAL (2.4.21)

