

Property



**Property Address:** 337 Broadway  
**Municipality:** City of kingston  
**Tax ID:** 56.34-4-16

Summary

SWIS 510800  
 Status Active  
 Roll Section Taxable  
 Property Class 431 - Auto dealer  
 Ownership Code  
 In Ag District No  
 Zoning T5MS - T5 Main Street  
 Neighborhood 8005 Midtown  
 School District KINGSTON CONSOLIDA  
 Property Description 335-337  
 Total Acreage/Size 55 x 100  
 Deed Book 7507  
 Deed Page 70  
 Grid East 630103  
 Grid North 1126810



09/08/2011 - Photo 2011

Owners

[Daniel C. Lewis, Jr](#)  
 P.O. Box 1774  
 Kingston, NY 12401

Valuation

Assessed Year	2026	2025	2024
Equalization Rate	47.00%	47.00%	57.00%
Land Assessment	\$30,000	\$30,000	\$30,000
<b>Total Assessment</b>	<b>\$129,000</b>	<b>\$129,000</b>	<b>\$129,000</b>
Full Market Value	\$274,468	\$274,468	\$226,316

Special Districts

Year	Description	Type	Units	Percent	Value
	LB008 - Kingston library		0	0%	\$0
	LB009 - Kingston Libry Debt		0	0%	\$0
2025	LB008 - Kingston library		0	0%	\$0
2025	LB009 - Kingston Libry Debt		0	0%	\$0
2024	LB008 - Kingston library		0	0%	\$0
2024	LB009 - Kingston Libry Debt		0	0%	\$0

Land

Site	Land Type	Size
Com 1	Primary	55 x 100

Sales

Sale Date	Sale Price	Property Class	Sale Type	Current Owner	Value Usable	Arms Length	Addl. Parcels	Deed Book/Page
6/27/2025	\$150,000	431 - Auto dealer	Land & Building	Lewis, Jr , Daniel C	No	No	No	7507 / 70
1/26/2021	\$0	431 - Auto dealer	Land & Building	Perry, as Trustee, Debra	No	No	No	6768 / 260
5/29/2012	\$10	431 - Auto dealer	Land & Building	Perry, Debra L	No	No	No	5331 / 6
4/5/2006	\$1	431 - Auto dealer	Land & Building	Perry, Vincent J Sr	No	No	No	4243 / 317
3/8/2002	\$1	312 - Vac w/imprv	Land & Building	Perry, Fred	No	No	No	03319 / 00221
11/9/2001	\$10,500	312 - Vac w/imprv	Land & Building	Perry, Fred F	No	No	No	03253 / 00306
12/30/2000	\$1	431 - Auto dealer	Land & Building		No	No	Yes	03116 / 00308

## Historic Deed

Book/Page	Prior Printkey
7507 / 70	
6768 / 260	
5331 / 6	
4243 / 317	
03319 / 00221	118514000

## Inventory

Site	Com 1	Overall Grade	Average
Overall EFF Year Built	2002	Overall Desirability	Superior
Overall Condition	Normal		

## Commercial Buildings

Site	Com 1	Eff Year Built	
Air Cond. %	0	Condition	Normal
Sprinkler %	0	Quality	Average
Alarm %	0	Gross Floor Area	404
Elevators	0	Stories	1
Basement Type		Nbr Identical Bldgs	1
Year Built	2002		

## Utilities

Site	Com 1	Water Supply	Comm/public
Sewer Type	Comm/public	Utilities	Gas & elec

## Site Uses

Site	Use	Rentable Area	Total Units
Com 1	Usd-car sale	404	0

## Historical Tax Summary

Tax Year	Tax Type	Original Bill	Total Assessed Value	Full Market Value	Uniform %	Roll Section
2026	County	\$2,921.10	\$129,000.00	\$274,468.00	47.00%	1
2025	School	\$5,092.95	\$129,000.00	\$274,468.00	47.00%	1
2025	County	\$2,651.92	\$129,000.00	\$226,316.00	57.00%	1
2024	School	\$4,565.40	\$129,000.00	\$226,316.00	57.00%	1
2024	County	\$2,429.93	\$129,000.00	\$211,475.00	61.00%	1
2023	School	\$4,405.00	\$129,000.00	\$211,475.00	61.00%	1
2023	County	\$2,411.14	\$129,000.00	\$184,286.00	70.00%	1
2022	School	\$4,237.46	\$129,000.00	\$184,286.00	70.00%	1
2022	County	\$2,480.68	\$129,000.00	\$159,259.00	81.00%	1
2021	School	\$4,155.01	\$129,000.00	\$159,259.00	81.00%	1
2021	County	\$2,465.80	\$129,000.00	\$143,333.00	90.00%	1
2020	School	\$4,079.47	\$129,000.00	\$143,333.00	90.00%	1
2020	County	\$2,447.71	\$129,000.00	\$129,000.00	100.00%	1
2019	School	\$3,884.73	\$129,000.00	\$129,000.00	100.00%	1
2019	County	\$2,401.70	\$117,000.00	\$117,000.00	100.00%	1
2018	School	\$3,700.92	\$117,000.00	\$117,000.00	100.00%	1
2018	County	\$2,633.15	\$117,000.00	\$117,000.00	100.00%	1
2017	School	\$3,758.54	\$117,000.00	\$117,000.00	100.00%	1
2017	County	\$2,725.66	\$117,000.00	\$117,000.00	100.00%	1
2016	School	\$3,745.03	\$117,000.00	\$117,000.00	100.00%	1
2016	County	\$2,748.52	\$117,000.00	\$117,000.00	100.00%	1
2015	School	\$3,678.55	\$117,000.00	\$117,000.00	100.00%	1
2015	County	\$2,674.37	\$117,000.00	\$117,000.00	100.00%	1
2014	School	\$3,585.26	\$117,000.00	\$117,000.00	100.00%	1
2014	County	\$2,591.01	\$117,000.00	\$117,000.00	100.00%	1

Taxes reflect exemptions, but may not include recent changes in assessment.

## Taxable Values

Tax Year	2025	2024
County Taxable	\$129,000	\$129,000
County Taxable Exemptions	\$0	\$0
Municipality Taxable	\$129,000	\$129,000
Municipality Taxable Exemptions	\$0	\$0
Village Taxable		
Village Taxable Exemptions		
School Taxable	\$129,000	\$129,000
School Taxable Exemptions	\$0	\$0

## Documents

Property Record Card (PDF)

## Photos



09/08/2011 - Photo 2011

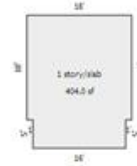

Sketch by Acon Viteira™

07/28/2008 - Sketch

## Real Property Transfer Application

RP-5217 Form

No data available for the following modules: Comparable Search (Res), Residential Buildings, Improvements, Exemptions.

Ulster County has compiled the data and images contained on this site for the sole purpose of assessing property for taxation. The information contained on this site is generated from various sources and is a reflection of the information submitted to Ulster County Assessment Office. All information contained on this site constitutes public records and is otherwise available to the public pursuant to freedom of information laws.  
[User Privacy Policy](#) | [GDPR Privacy Notice](#)  
 Last Data Upload: 6/3/2026, 8:52:55 PM

Contact Us

Developed by  
 **SCHNEIDER**  
 GEOSPATIAL