

The Colliers logo consists of the word "Colliers" in a white serif font, centered within a blue rectangular box. Below the text are three horizontal stripes in yellow, red, and blue.A large, modern industrial building with a light gray facade and dark window frames. The building has a flat roof with several security cameras. In front of the building is a paved parking lot with several cars parked. A sign in the foreground reads "3451 UNICORN".

For Lease | +/- 15,299 SF - 29,699 SF
**Highway Frontage Industrial
Distribution Center**

3451 Unicorn Rd | Bakersfield, CA 93308

Contact Us:

David A. Williams, SIOR
Senior Vice President | Principal
License No. 00855489
+1 661 631 3816
david.a.williams@colliers.com

Marco Petrini
Vice President
License No. 02167974
+1 661 631 3826
marco.petrini@colliers.com

Colliers International
10000 Stockdale Hwy, Suite 102
Bakersfield, CA 93311
+1 661 631 3800
www.colliers.com/bakersfield

Property Information

3451 Unicorn Rd. is a +/- 29,699 square foot, dual-tenant industrial building made of concrete tilt-up construction, situated on approximately 2.32 acres. The property offers excellent visibility and access along Highway 65, with convenient connectivity to both northbound and southbound Highway 99. Strategically located within the prestigious Bakersfield Airport Business Center, the site benefits from its prime position between Meadows Field Airport and Highway 99.

Available:

Lease Rate:

Suite 100: +/- 15,299 SF - 29,699 SF \$1.15/SF, Industrial Gross

Property Highlights:

- Approx. 15,299 SF - 29,699 SF of office/ warehouse building
- Column Spacing: 24' x 40'
- Concrete tilt-up construction with wood roof
- Zoning- Medium Industrial (M2-PD H), County of Kern
- Clear Height- 16'-18'
- Eight (8) 12'x14' Recessed Truck Dock Doors
- Three (3) 12'x14' Grade level Doors (more may be added)
- Easy Freeway Access and ample loading/driveway
- Fire Sprinklers
- Freeway/Highway signage available
- Warehouse Lighting: T-5 and Skylights
- Restrooms: Four (4)
- Parking: 45 parking spaces
- Fully Alarmed
- Utilities:
 - Sewer: North of the River Municipal Water District
 - Water: Oildale Mutual Water Co.
 - Electric: PG&E 200/400 Amps, 120/208-volt, 3 Phase, 4 Wire
 - Gas: SoCal Gas Co.



Floor Plan

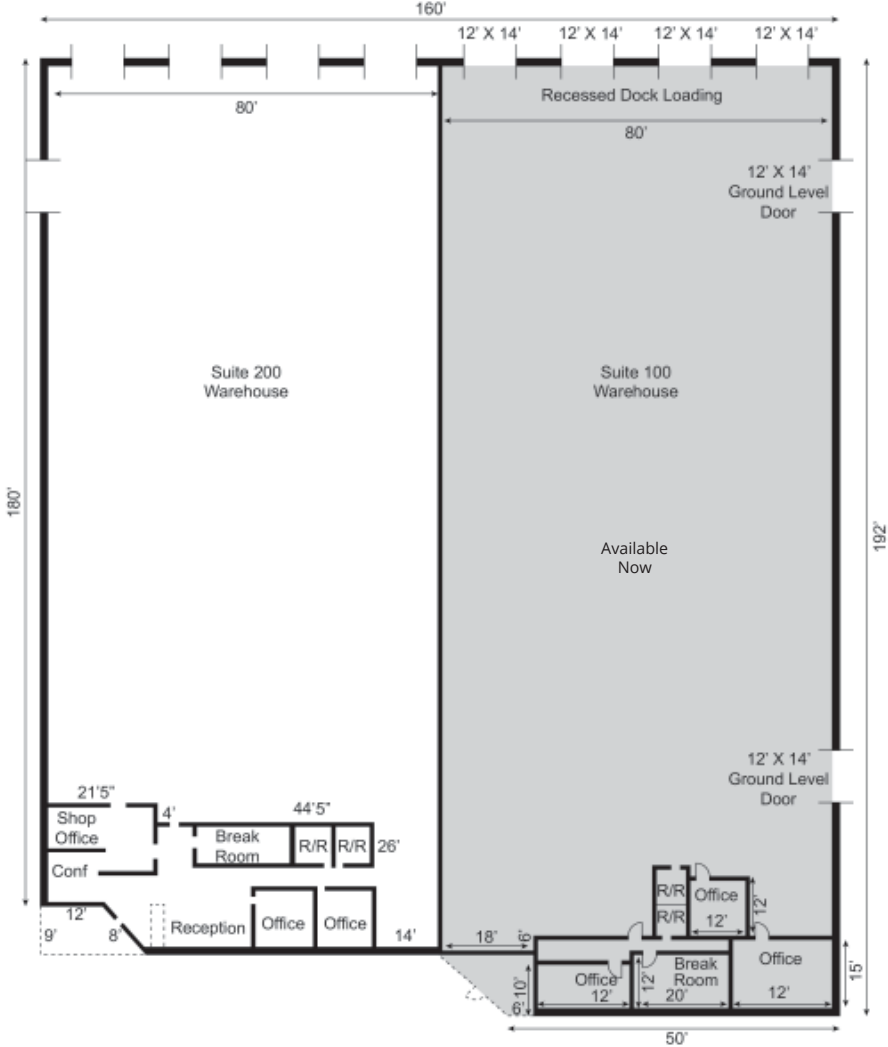

This is drawing of approximate size

This document/email has been prepared by Colliers for advertising and general information only. Colliers makes no guarantees, representations or warranties of any kind, expressed or implied, regarding the information including, but not limited to, warranties of content, accuracy and reliability. Any interested party should undertake their own inquiries as to the accuracy of the information. Colliers excludes unequivocally all inferred or implied terms, conditions and warranties arising out of this document and excludes all liability for loss and damages arising there from. This publication is the copyrighted property of Colliers and /or its licensor(s). © 2026. All rights reserved. This communication is not intended to cause or induce breach of an existing listing agreement

Site Plan



This document/email has been prepared by Colliers for advertising and general information only. Colliers makes no guarantees, representations or warranties of any kind, expressed or implied, regarding the information including, but not limited to, warranties of content, accuracy and reliability. Any interested party should undertake their own inquiries as to the accuracy of the information. Colliers excludes unequivocally all inferred or implied terms, conditions and warranties arising out of this document and excludes all liability for loss and damages arising there from. This publication is the copyrighted property of Colliers and /or its licensor(s). © 2026. All rights reserved. This communication is not intended to cause or induce breach of an existing listing agreement



