



FOR
LEASE

Jonathan Kohn
+1 847 698 8279
jonathan.kohn@colliers.com

Lucas Denney
+1 312 952 2888
lucas.deeney@colliers.com

6250 N River Road
Suite 11-100
Rosemont, IL 60018
colliers.com

825 Veterans Parkway Bolingbrook, IL

256,372 SF Available
(Divisible to 148,019 SF & 108,353 SF)

- Great access to I-55 via full interchange at Route 53 and Weber Road.
- Institutionally owned and operated
- Low Will County taxes

Copyright © 2026 Colliers International. Information herein has been obtained from sources deemed reliable, however its accuracy cannot be guaranteed. The user is required to conduct their own due diligence and verification.

For Lease

Property Specifications

Address:	825 Veterans Parkway, Bolingbrook, IL
Available:	256,372 SF (Divisible to 148,019 SF and 108,353 SF)
Total Building:	256,372 SF
Office:	3,380 SF
Site Area:	15 acres
Clear Height:	36'
Loading:	36 Exterior Docks (Expandable) 2 Drive-in Doors
Car Parking:	189 Stalls
Truck Parking:	57 Stalls
Trailer Court:	185' Concrete
Bay Size:	52' x 50'
Speed Bay:	52' x 60'
Lighting:	LED
Sprinkler:	ESFR



Location Map



For Lease

Floor Plan

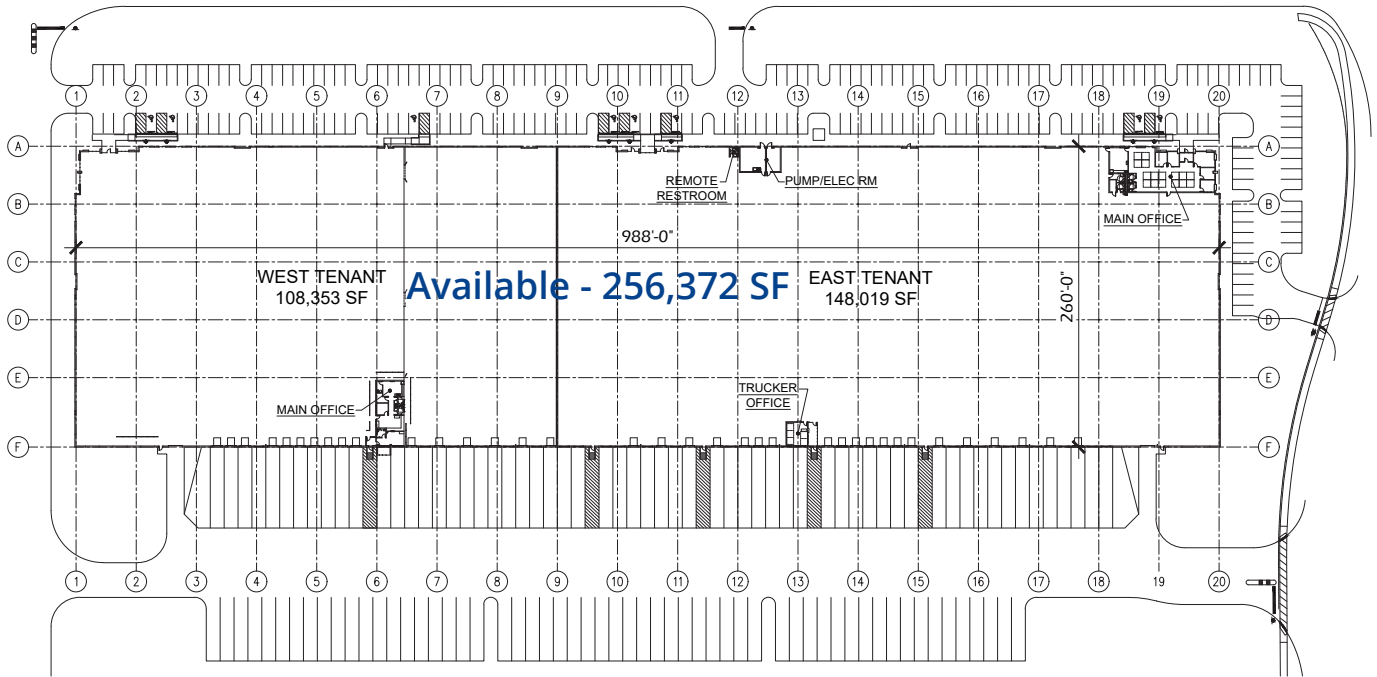

Office Plan

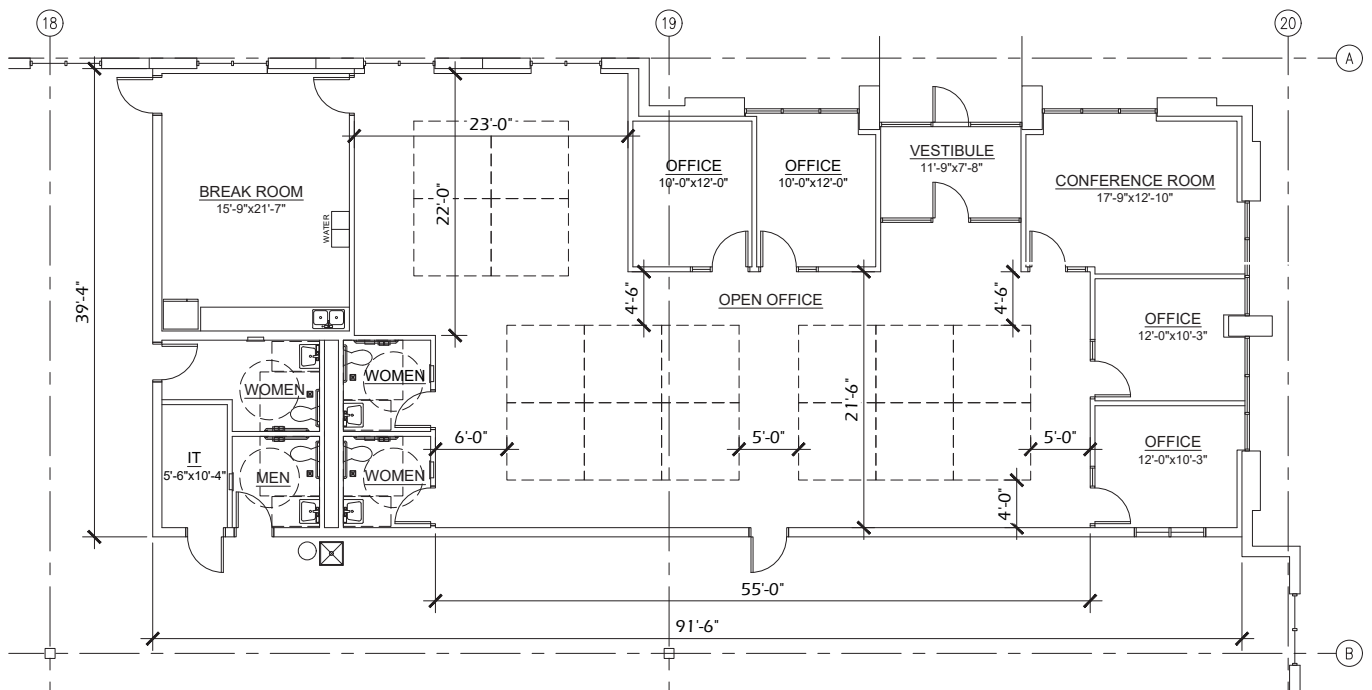

For Lease

KEY DISTANCES

I-55	0.4 miles
I-355	6.3 miles
I-80	16.0 miles
I-88	17.0 miles
Chicago Midway International Airport	24.9 miles
O'Hare International Airport	32.3 miles
Downtown Chicago	32.4 miles



Contact us:

Jonathan Kohn

+1 847 698 8279

jonathan.kohn@colliers.com

Lucas Denney

+1 312 952 2888

lucas.denney@colliers.com

Colliers

6250 N River Road

Suite 11-100

Rosemont, IL 60018