

AARDEX · REPOSITIONED  
HISTORIC WAREHOUSE DISTRICT ·  
DOWNTOWN PHOENIX

# One West Madison.

*A century-old building, meticulously repositioned for today's most dynamic retail, food & beverage, and experiential concepts.*

## THE PROPERTY

1 W Madison St · Phoenix, AZ 85003

FOR LEASE · PHOENIX COMMERCIAL  
2026 ADVISORS



NOW LEASING  
±13,500 SF



ENTERTAINMENT DISTRICT  
Madison & Central · Phoenix

A DOWNTOWN ICON, REIMAGINED

# Move-in ready in the heart of the Entertainment District.

One West Madison offers a fully renovated, move-in ready retail and commercial opportunity in the heart of downtown Phoenix's Entertainment District.

Originally constructed more than a century ago, the building has been carefully repositioned by Aardex to deliver modern performance while preserving its historic character. With 13,500 square feet of flexible ground-floor space, the project is designed for today's most dynamic retail, food and beverage, and experiential concepts — all meticulously renovated and ready for your vision.

AVAILABLE	CEILING	FRONTAGE
±13,500 SF	Up to 22'	3 sides

## Highlights

WHY THIS BUILDING, WHY NOW

- Comprehensive renovation with significant investment in new systems and infrastructure — **tenants move in quickly with reduced upfront cost and timeline.**
- Fully upgraded plumbing, electrical, HVAC, and fire and life-safety systems.
- Energy-efficient cooling via the **Cordia chilled water loop.**
- Move-in ready condition with flexible layouts.
- Ceiling heights up to 22 feet with exposed structural elements.
- Storefront glass on three sides — **operable for full indoor-outdoor connectivity or configured as roll-up doors.**
- Patio potential on all three street-facing sides.

**Also available:** GPLET tax savings, dedicated on-site parking, and pre-plumbed infrastructure ready for tenant buildout.

HISTORY, PRESERVED

# A century of character. *Ready for what's next.*

Built more than 100 years ago in what is now the heart of downtown Phoenix, the single-story warehouse was quietly a piece of the city's past until Aardex took it on. The restoration preserves the building's defining features — expansive storefront glass, exposed structure, and generous ceiling heights — while bringing everything behind the walls fully up to modern standard.

The result is a rare downtown asset: a historically distinctive shell with new systems, flexible demising potential, and immediate availability. Plumbing, electrical, HVAC, and fire and life-safety are all in place — **all that's left is your tenant improvement.** Bring your concept, your brand, and your interior vision. We've done the rest.

1910s

ORIGINAL CONSTRUCTION

2026

REPOSITIONING COMPLETE

Historic

WAREHOUSE DISTRICT

Fully

DEMISABLE



CURRENT CONDITION · APRIL 2026



CENTRAL AVENUE FRONTAGE

THE PARCEL

# Corner position on Madison & Central.

The available space sits at the hard corner of the block, fronting both W Madison Street and S Central Avenue with the Valley Metro light rail station steps away. An activated service alley on the south side provides a second patio edge and connection to the proposed future development.

A proposed 262-unit multi-family development wrapping the block (delivery targeted 2028) will deliver new rooftops and a built-in customer base within steps of the front door.

- **±13,500 SF available — can demise.**
- **±24,000 SF future development site** — includes ±7,000 SF multi-family building footprint
- Proposed future retail & multi-family (262 units)

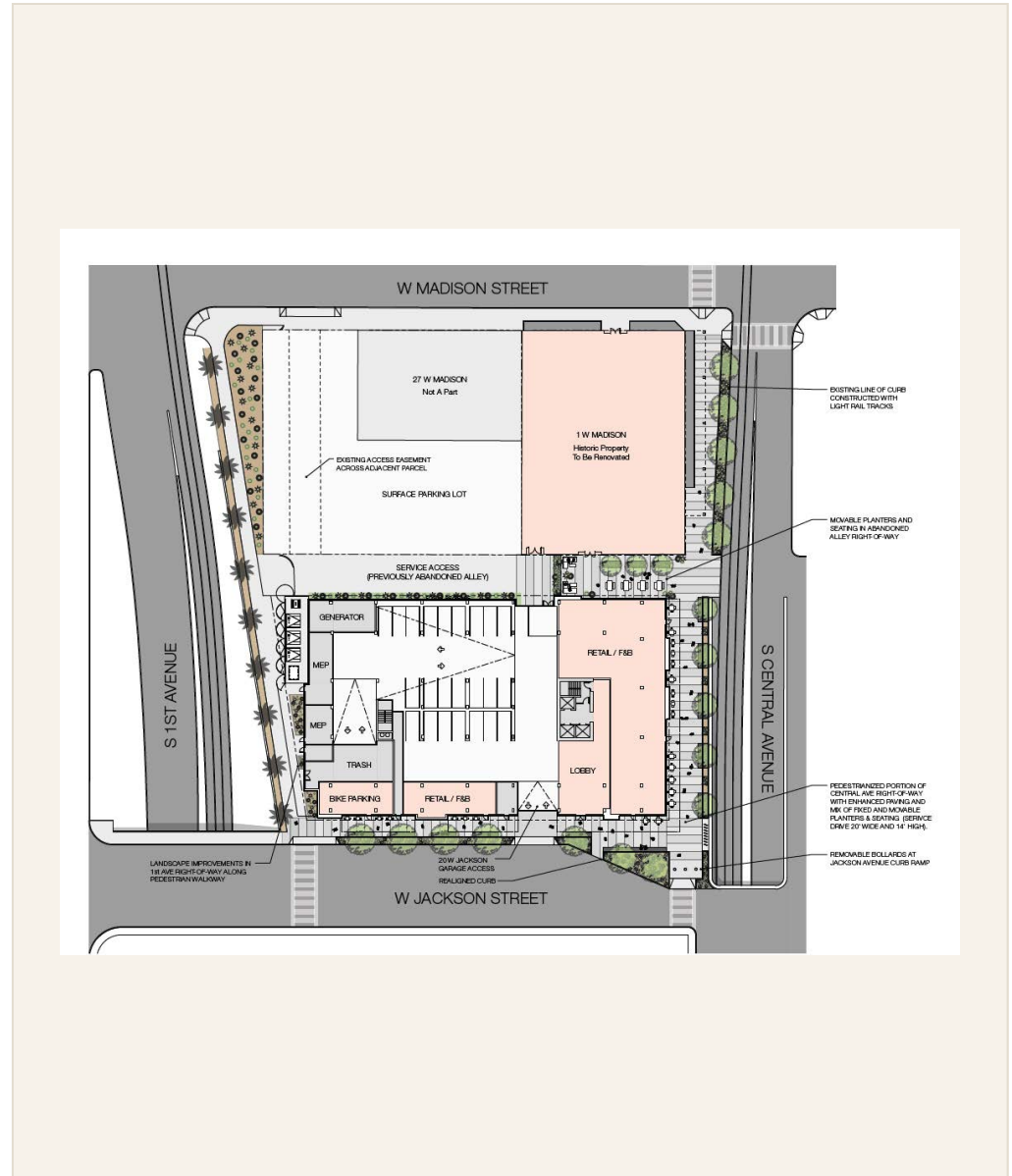

WHAT'S POSSIBLE

# A shell built for *ambition.*

Ground-floor flexibility supports full-service restaurants, beverage-forward concepts, retail, entertainment, and hybrid experiential uses — anchored by ceiling height, storefront glass on three sides, and patio spillout potential.



FULL-SERVICE DINING



CREATIVE DINING



BAR & LOUNGE



ENTERTAINMENT



ACTIVATED PATIO

# A combination that is increasingly difficult to secure *in downtown Phoenix.*

*One West Madison brings together five things the market almost never delivers at once – a building that's move-in ready, a parcel with real parking, and a block positioned to keep growing.*

---

01

## **Dedicated on-site parking**

Surface parking within the block and 953 controlled stalls within a one-block walk.

---

02

## **Immediate availability**

Fully renovated and delivered – shell is complete. Only tenant TI is needed to open the doors.

---

03

## **Historic meets modern**

Original warehouse character paired with fully upgraded mechanical, electrical, and life-safety systems.

---

04

## **Scalable space**

13,500 SF of ground floor plus basement potential – demisable to fit concepts of varying size.

---

05

## **Strong co-tenancy**

Valley Bar, Monroe's, Chico Malo, Blanco, The Duce, and more – already drawing traffic to the block.

BLOCK-LEVEL CAPACITY

# Parking that *actually works.*

One of the most difficult things to secure in downtown Phoenix is real, walkable parking. One West Madison delivers it — structured, surface, and valet, all within a one-block walk of the front door.

**476** STALLS IN THE ADJACENT LUHRS GARAGE

**477** STALLS CONTROLLED BY LAZ (VALET, MONTHLY, EVENT)

**953** TOTAL PARKING STALLS WITHIN A ONE-BLOCK WALK

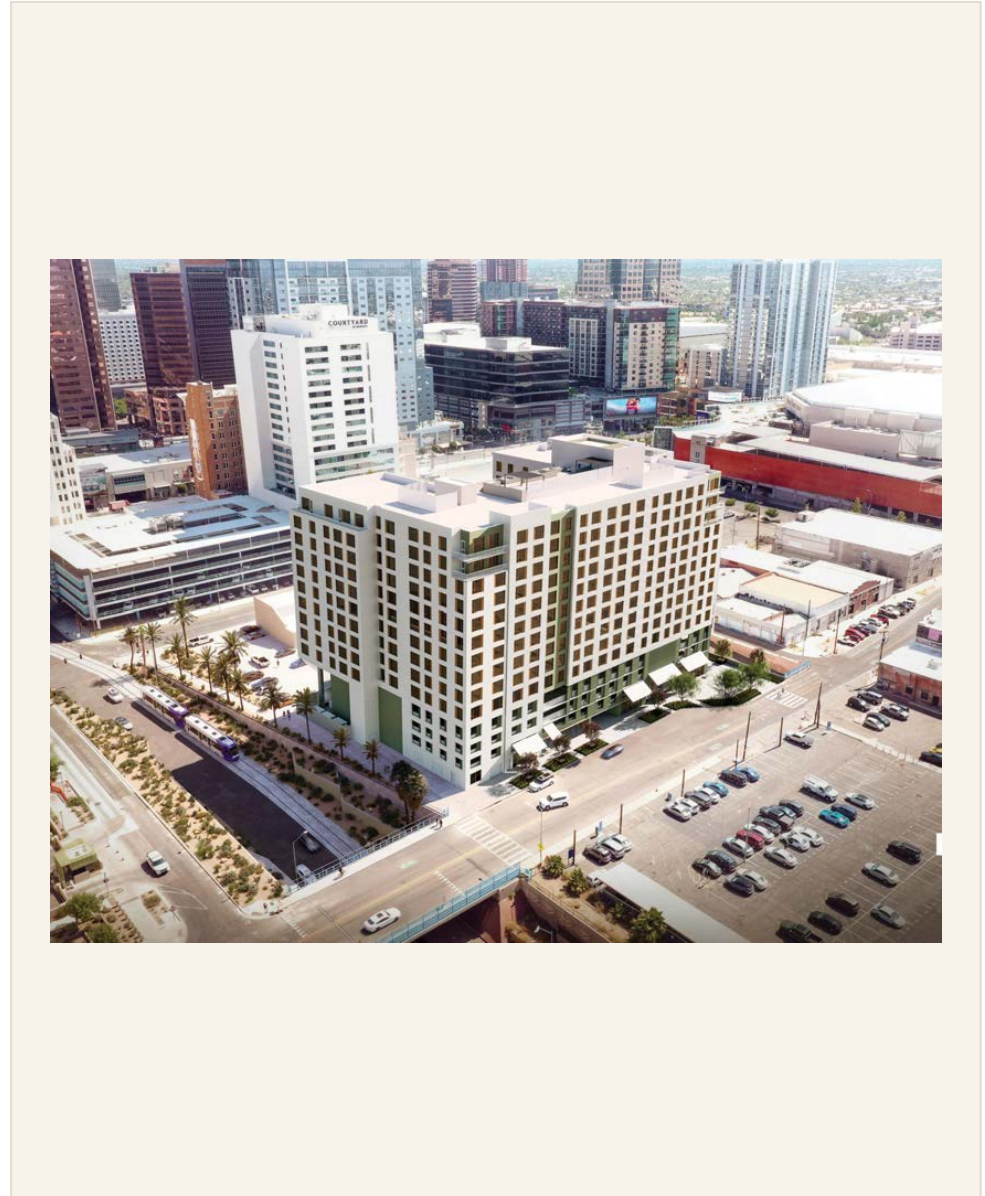

WHERE THE STALLS LIVE

# Six lots. *One block.*

Parking capacity around One West Madison is distributed across the Luhrs Garage, six surface and structured lots, and one LAZ-controlled valet operation — every lot within a one-block walk of the front door.

1 W Madison St	<b>On-site</b>
Luhrs Garage	<b>476 stalls</b>
1 W Jackson	<b>200 stalls</b>
41 E Jefferson	<b>120 stalls</b>
101 S Central	<b>80 stalls</b>
27 W Madison	<b>42 stalls</b>
10 W Jackson	<b>35 stalls</b>

**953** TOTAL PARKING STALLS WITHIN A ONE-BLOCK WALK

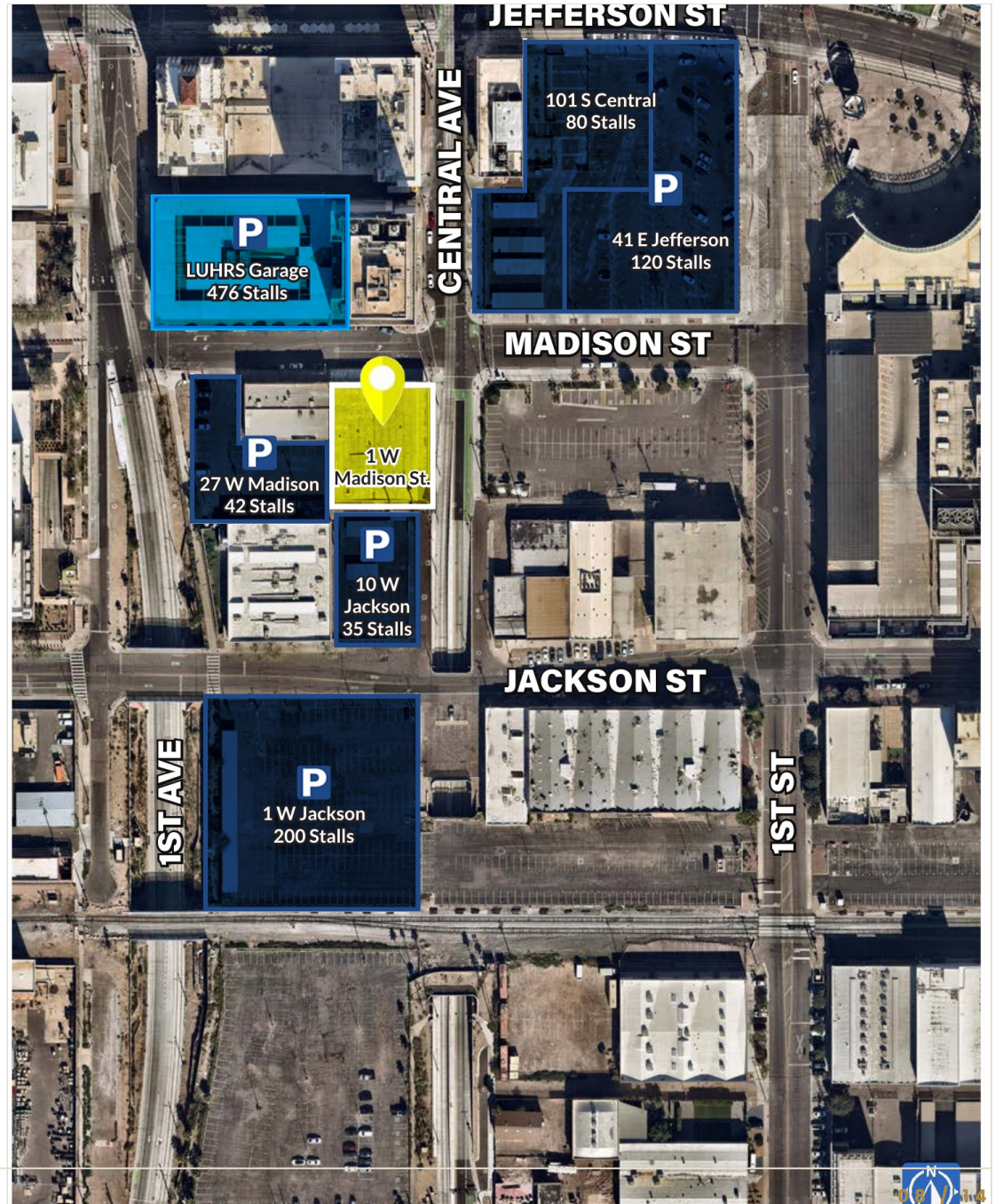

WITHIN WALKING DISTANCE

# Anchored by the city's biggest draws.

- Phoenix Symphony Hall, Herberger Theater, Dodge Theater, and the Orpheum Theater combine for more than 500,000 annual visitors.
- Arizona State University's Downtown Phoenix campus continues its expansion with enrollment approaching 12,000 students.
- The 24-acre Phoenix Convention Center offers more than 900,000 SF of meeting and exhibition space.
- Nearly 3,000 hotel rooms serve tourists, convention attendees, and business travelers – including the 1,000-room Sheraton, Westin Downtown Phoenix, Hyatt Regency, Renaissance Phoenix Downtown, Hotel Palomar, and the 320-room Marriott next door.
- Two blocks from the Mortgage Matchup Center (Phoenix Suns & Phoenix Mercury) and Chase Field (Arizona Diamondbacks) – combined, the venues bring an average of 17,071 fans per Suns game and 1.49 million attendees per Diamondbacks season, alongside concerts, WWE, AMA Supercross, and Monster Jam.

4.4 M

CONVENTION CENTER  
ATTENDEES (5 YR)

699,911

SUNS TICKETS  
2022-2023 SEASON

11,584

ASU DOWNTOWN  
PHOENIX STUDENTS

1.49 M

DIAMONDBACKS  
2023 ATTENDANCE

ON THE BLOCK

## Nearby tenants



Strong co-tenancy within the building and surrounding block – a stack of proven operators already drawing traffic.

AT THE CENTER OF IT ALL

# Walkable, connected, growing.

One West Madison sits at the intersection of downtown Phoenix's densest employment, hospitality, and entertainment nodes – with the Valley Metro light rail at the door and the South Extension now open.

- Mortgage Matchup Center (Phoenix Suns)
- Chase Field (Arizona Diamondbacks)
- Luhrs City Center & garage
- Phoenix Convention Center (N & S halls)
- ASU Downtown Phoenix campus
- Historic City Hall & County Courthouse
- Orpheum Theater & Symphony Hall
- Light rail South Extension (now open)

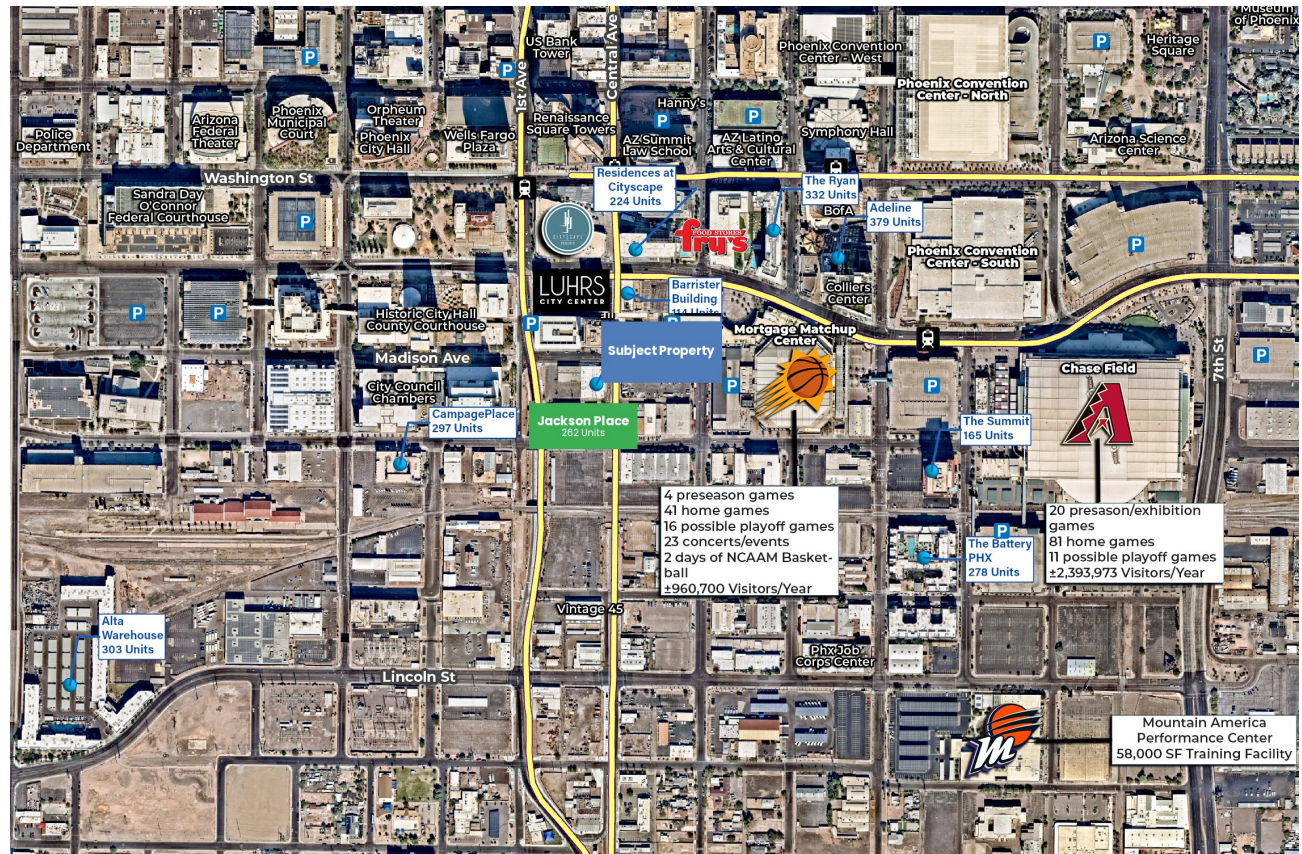

THE CUSTOMER BASE

# A downtown with *real density*.

Downtown Phoenix has grown into one of the country's fastest-changing urban cores — driven by an expanding university campus, a booming convention calendar, a deep hotel stock, and a hard-to-find mix of office workers and full-time residents within walking distance.

---

## 11,584

ASU STUDENTS

Full-time enrollment at ASU's Downtown Phoenix campus, with expansion continuing into 2026.

---

## 225

BARS & RESTAURANTS

Creative concepts and longtime favorites within a five-minute walk. A thriving downtown dining scene.

---

## 245,826

DAYTIME POPULATION

Within a three-mile radius — Phoenix's largest concentration of office workers, residents, and students.

---

## 194,931

OFFICE WORKERS

Within a three-mile radius (U.S. Census 2020 · Esri 2022–2027 forecast).

---

## 12,421

THEATER SEATS

Music and performance woven into the urban fabric — a half-million annual visitors between Symphony Hall, Herberger, Orpheum, and Dodge.

---

## 20,208

FULL-TIME ENROLLMENT

Across ASU Downtown Phoenix (2019) — a fast-paced, pre-professional customer base.

ESRI 2025

# The ring around *the block.*

POPULATION · HOUSEHOLDS · DAYTIME WORKERS · INCOME · HOUSING · BUSINESS

## POPULATION

	1 MI	3 MI	5 MI
2025 total	23,534	100,580	368,359
2030 total	31,899	112,450	386,270

## 2025 DAYTIME POPULATION

	1 MI	3 MI	5 MI
Total	75,143	255,922	561,728
Workers	64,108	206,641	381,545
Residents	11,035	49,281	180,183

## 2025 INCOMES

	1 MI	3 MI	5 MI
Median HH	\$53,078	\$61,068	\$64,099
Average HH	\$91,172	\$92,737	\$92,926
Per capita	\$43,680	\$39,503	\$35,526

## HOUSEHOLDS

	1 MI	3 MI	5 MI
2025 total	11,203	42,439	140,166
2030 total	16,738	50,275	152,243

## 2025 HOUSING UNITS

	1 MI	3 MI	5 MI
Total	13,882	48,836	154,328
Owner occupied	11.2%	33.8%	42.0%
Renter occupied	88.8%	66.2%	58.0%
Vacant	2,679	6,397	14,162

## 2025 BUSINESSES (NAICS)

	1 MI	3 MI	5 MI
Total businesses	2,214	8,399	18,424
Total employees	58,201	180,555	326,586

# One West Madison

● In Const (Under 100 Units)  
Name Planned  
● Planned (Under 100 Units)

**Total Existing Units: 17,159**  
**Total In Const Units: 2,305**  
**MULTI-FAMILY**

**TOTAL UNITS**  
**PLANNED/PROPOSED**  
 1 MILE - 2,374 • 3 MILE - 3,939 • 5 MILE - 6,978

\*INCLUDES EXISTING, UNDER CONSTRUCTION, PLANNED

## THE RESIDENTIAL TIDE

# Rooftops are rising.

Downtown Phoenix is in the middle of its densest multi-family cycle in a generation. Existing, under-construction, and planned unit totals within one, three, and five miles of the property – a customer base being built block by block.

### EXISTING UNITS

1 mile	14,793
3 mile	31,372
5 mile	84,706

### UNDER CONSTRUCTION

1 mile	1,129
3 mile	1,493
5 mile	2,033

### PLANNED / PROPOSED

1 mile	2,374
3 mile	3,939
5 mile	6,978

21,644 TOTAL UNITS WITHIN A 1-MILE RING  
 EXISTING + IN CONSTRUCTION + PLANNED

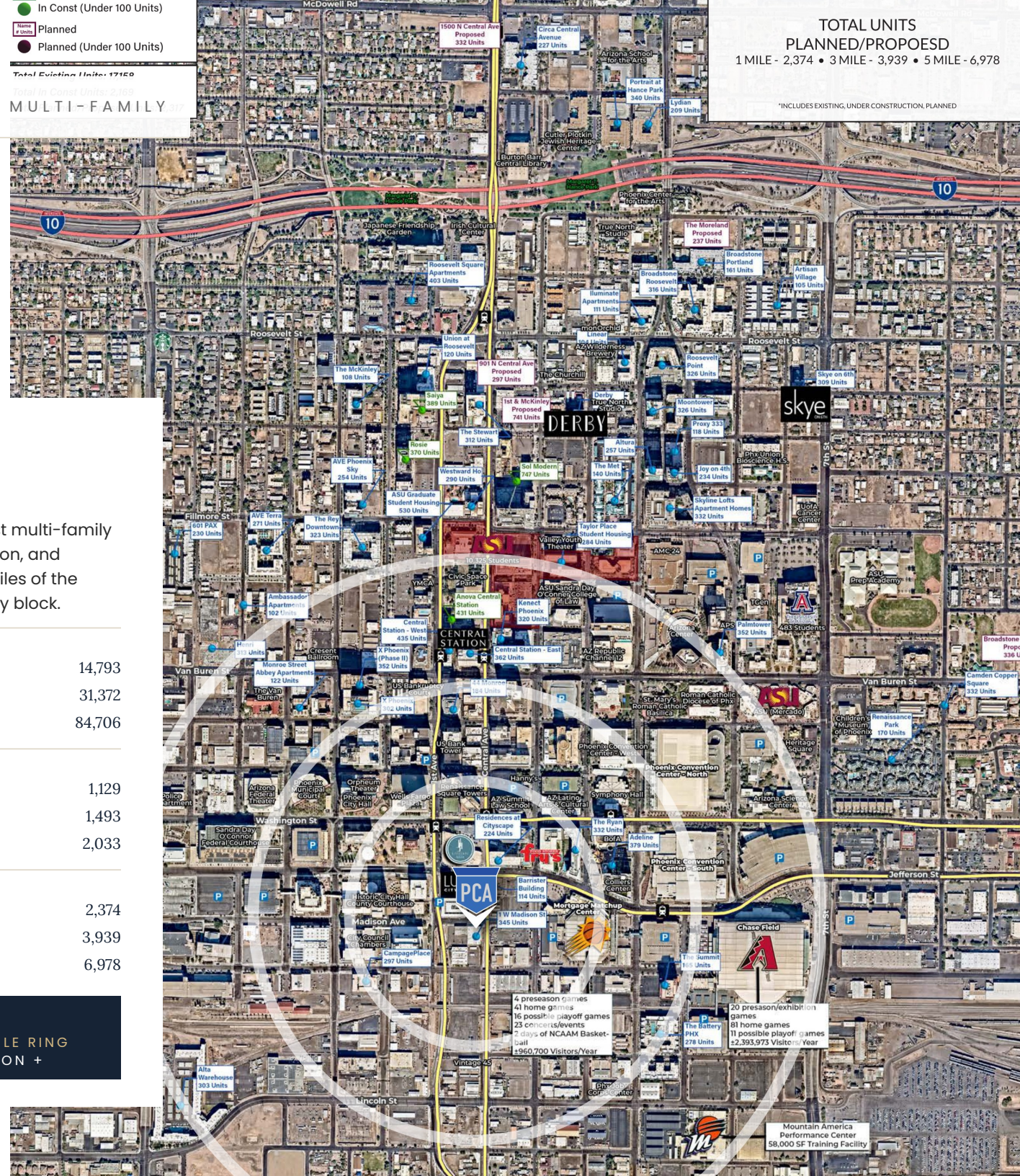

4 preseason games  
 41 home games  
 16 possible playoff games  
 23 concerts/events  
 2 days of NCAA Basketball  
 +960,700 Visitors/Year

20 preseason/exhibition games  
 81 home games  
 11 possible playoff games  
 +2,393,973 Visitors/Year

Mountain America  
 Performance Center  
 58,000 SF Training Facility

START THE CONVERSATION

# Bring your *concept*. We'll bring *the building*.

*One West Madison is ready for the right operator. For tours, floor plans, or a pre-lease conversation, contact the leasing team at Phoenix Commercial Advisors.*

---

## Teale Bloom

ASSOCIATE VICE PRESIDENT

(602) 288-3476

tbloom@pcaemail.com

---

## Courtney Auther Van Loo

ASSOCIATE VICE PRESIDENT

(602) 288-3466

cauther@pcaemail.com

---

## Dillon Young

ASSOCIATE

(602) 288-3474

dyoung@pcaemail.com



PHOENIX COMMERCIAL ADVISORS

Leasing · A member of Chainlinks Retail Advisors

[www.phoenixcommercialadvisors.com](http://www.phoenixcommercialadvisors.com)



OWNER & DEVELOPER

[www.aardex.com](http://www.aardex.com)

---

The information contained herein has been obtained from sources believed reliable. While we do not doubt its accuracy, we have not verified it and make no guarantee, warranty, or representation about it. It is your responsibility to independently confirm its accuracy and completeness. Any projections, opinions, assumptions, or estimates used are for example only and do not represent the current or future performance of the property. The value of this transaction to you depends on tax and other factors which should be evaluated by your tax, financial, and legal advisors. You and your advisors should conduct a careful, independent investigation of the property to determine to your satisfaction the suitability of the property for your needs.