

# 2.8 ACRES FOR SALE

25315 Boerne Stage Rd

Bexar County



## FEATURES:

- Outside City Limits – No Zoning Required
- New City Water & Sewer Main
- No Flood Plain
- 6,000 Vehicles Per Day
- Bldg. 1 Improvements - 2,139 SF
- Bldg. 2 Improvements – 1,719 SF
- \$1,500,000

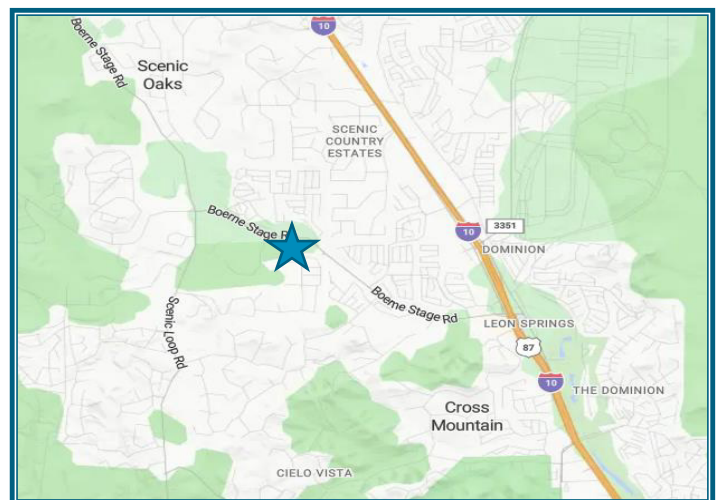

TODD BEEBE, Broker  
Cell: (210) 410-9904  
tbeebe@hoganre.com

**HOGAN**  
COMMERCIAL PARTNERS

1618 Lockhill Selma Rd., San Antonio, TX 78213