

# 7226 Harrisburg Road (10,766.4 sf)

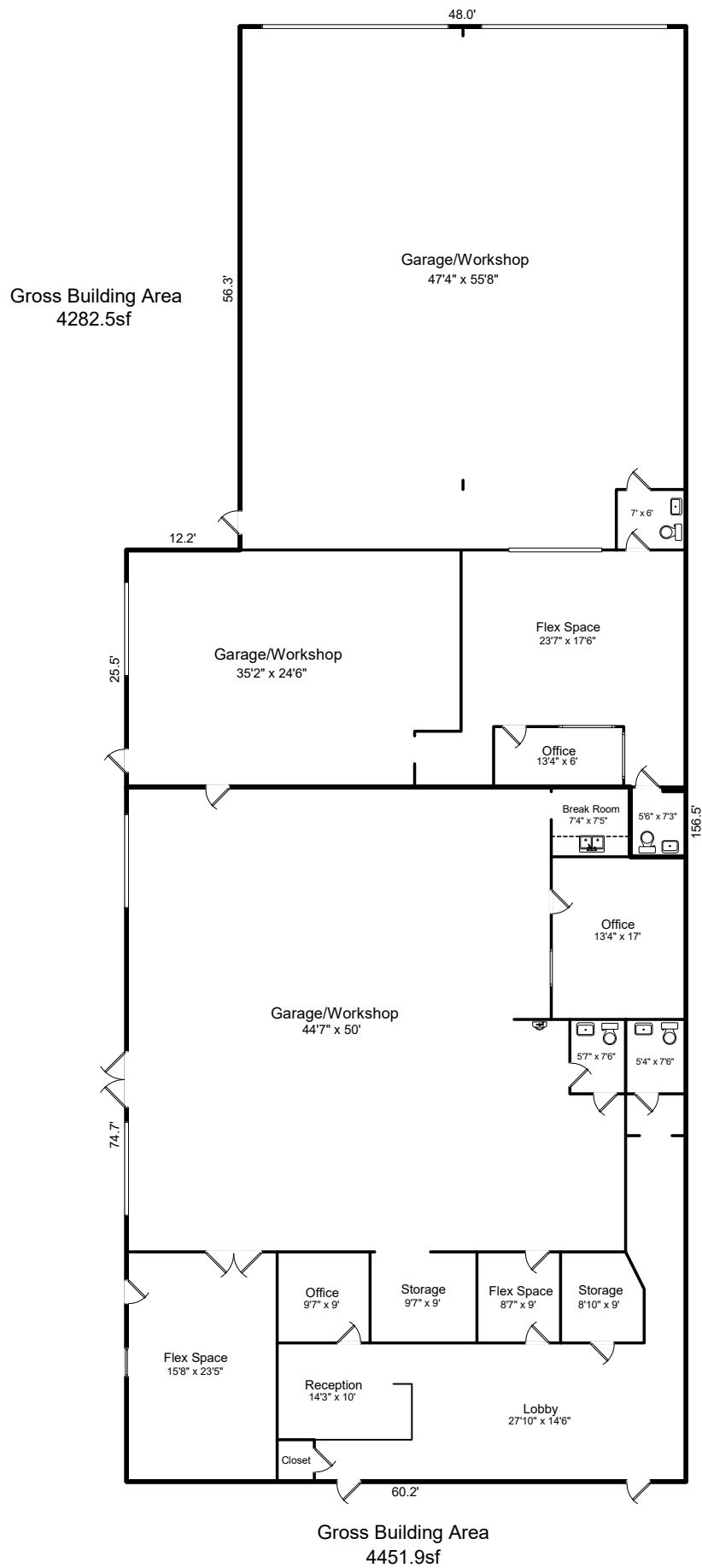

7226 Harrisburg Road (10,766.4 sf)

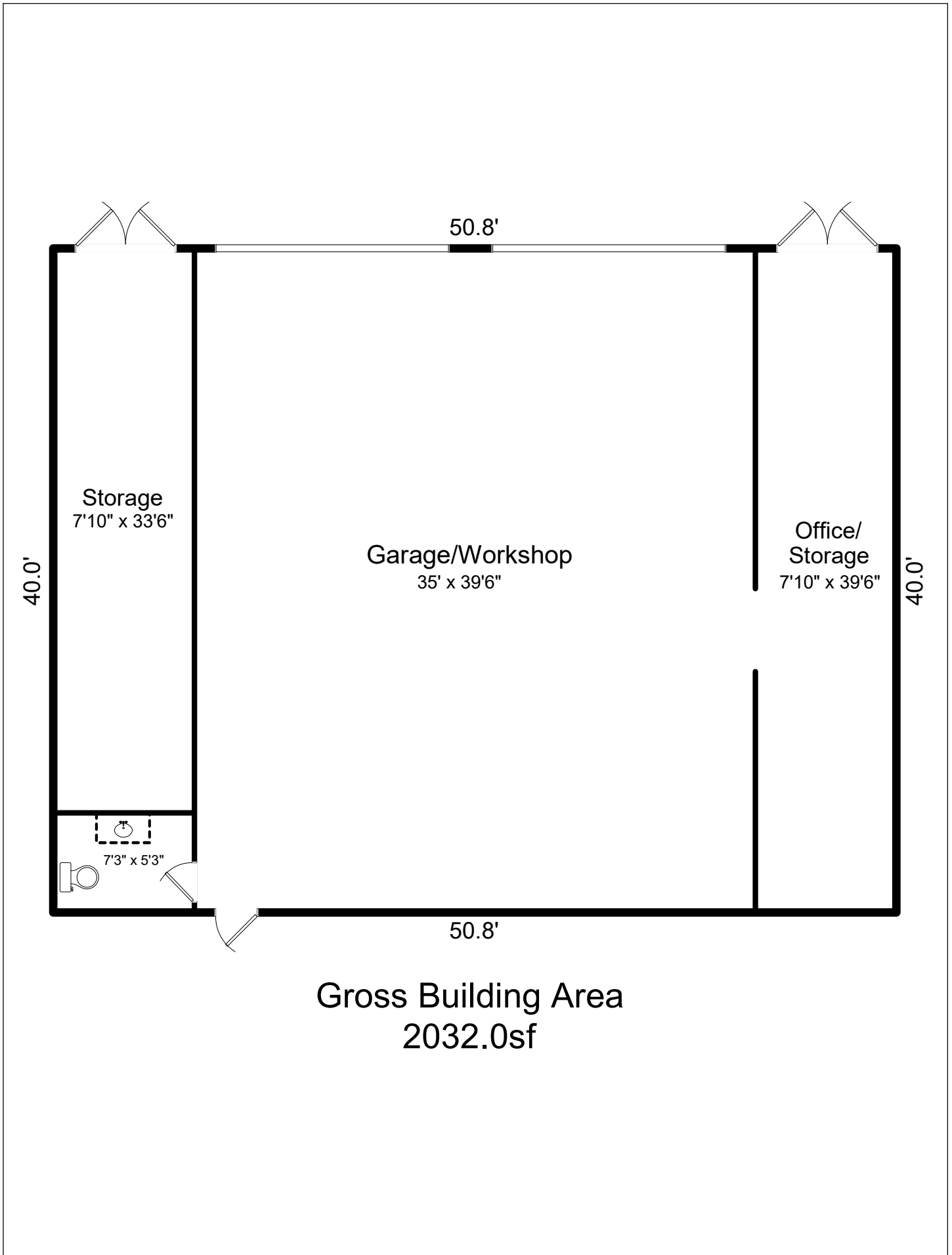

Gross Building Area  
2032.0sf

**SKETCH/AREA TABLE ADDENDUM**

**SUBJECT INFO**

File No.:	Parcel No.:		
Property Address:			
City:	County:	State:	ZipCode:
Owner:			
Client:	Client Address:		
Appraiser Name:	Inspection Date:		

**SKETCH**

Gross Building Area (GBA1)  
60.20 x 25.50 = 1535.10  
56.30 x 48.00 = 2702.40  
7.50 x 6.00 = 45.00

Gross Building Area (GBA1)  
74.70 x 54.20 = 4048.74  
67.20 x 6.00 = 403.20

Gross Building Area (GBA1)  
50.80 x 40.00 = 2032.00