

4720 Boston Way

Fully Leased

Colliers

For Lease

9700 Martin Luther King Jr. Hwy

Available: 4,700 SF

9730 Martin Luther King Jr. Hwy

Fully Leased

Brian Watts

Executive Vice President
+1 410 319 2408
Brian.Watts@colliers.com

Jason Sullivan, SIOR

Executive Vice President
+1 410 319 2409
Jason.Sullivan@colliers.com

Brian Siegel, SIOR

Executive Vice President
+1 410 319 2410
Brian.Siegel@colliers.com

Tom Gentner

Executive Vice President
+1 410 319 2407
Tom.Gentner@colliers.com

Melissa Parrish

Associate Vice President
+1 410 319 2412
Melissa.Parrish@colliers.com

Property Features

4720 Boston Way

Available Space:	Fully Leased
Building Size:	65,100 SF
Built:	1979
Ceiling Height:	15'-17'
Column Spacing:	30' x 30'
Loading:	Dock High
Access:	Located at the intersection of I-495 and Route 50 in Prince George's County



9700 Martin Luther King Jr. Hwy

Available Space:	4,700 SF
Building Size:	43,275 SF
Built:	1980
Ceiling Height:	16'9"
Column Spacing:	40' x 40'
Loading:	Dock High (1)
Access:	Located at the intersection of I-495 and Route 50 in Prince George's County



Property Features

9730 Martin Luther King Jr. Hwy

Available Space:	Fully Leased
Building Size:	30,608 SF
Built:	1980
Ceiling Height:	16'
Column Spacing:	30' x 30'
Loading:	Dock High (1)
Access:	Located at the intersection of I-495 and Route 50 in Prince George's County



Location Map

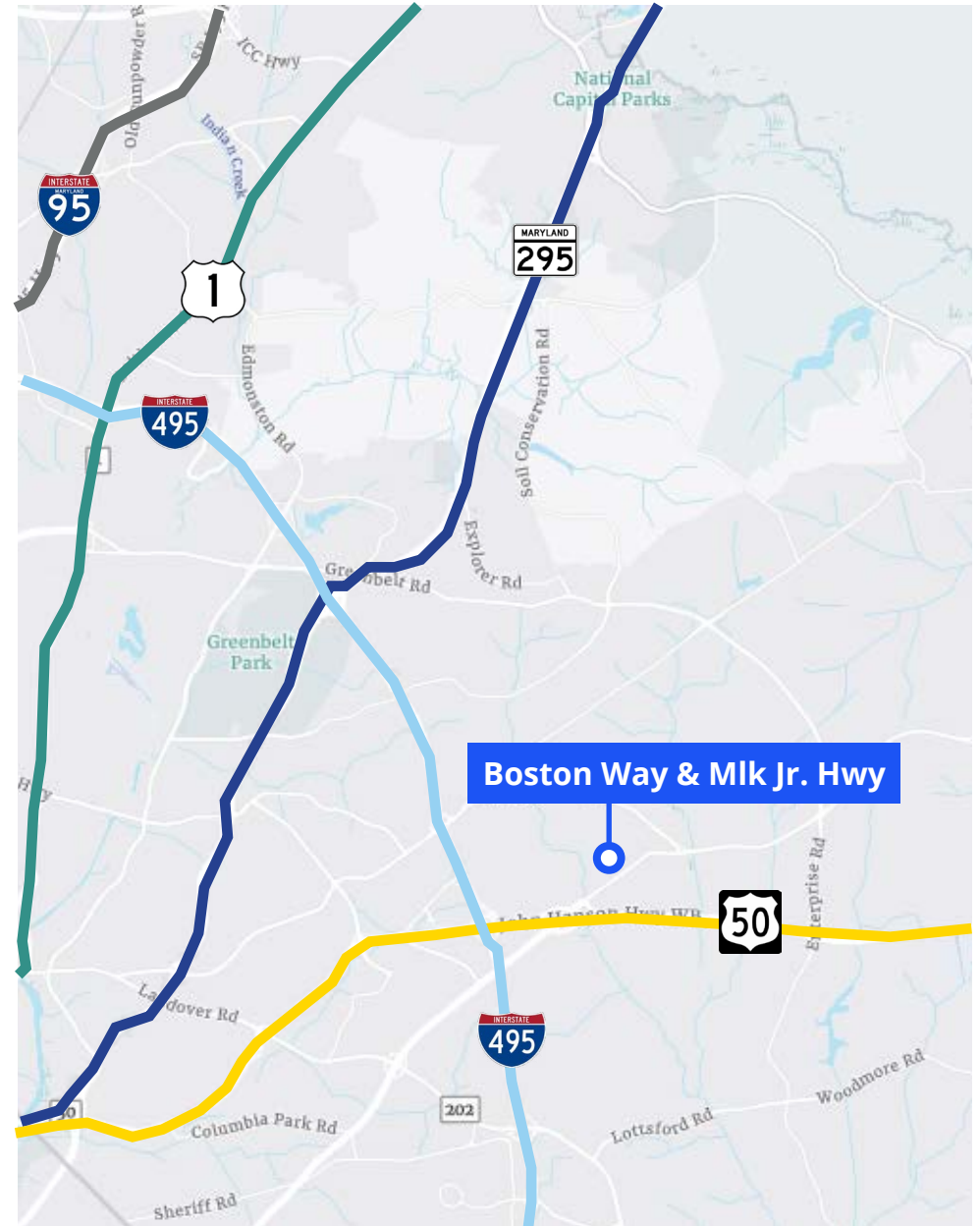

Property Features

Available Space:	Fully Leased
Building Size:	65,100 SF
Built:	1979
Ceiling Height:	15'-17'
Column Spacing:	30' x 30'
Loading:	Dock High
Access:	Located at the intersection of I-495 and Route 50 in Prince George's County

4720 Boston Way



Check back periodically for future availability

Property Features

Available Space:	4,700 SF Suite G
Building Size:	43,275 SF
Year Built:	1980
Ceiling Height:	16' 9"
Column Spacing:	40' x 40'
Loading:	Dock High
Access:	Located at the intersection of I-495 and Route 50 in Prince George's County

Details | Suite G

Available Space:	4,700 SF
Office:	+/- 1,800 SF
Loading:	1 Dock
Notes:	End unit with abundant window line

Space Available Immediately

9700 Martin Luther King Jr. Hwy

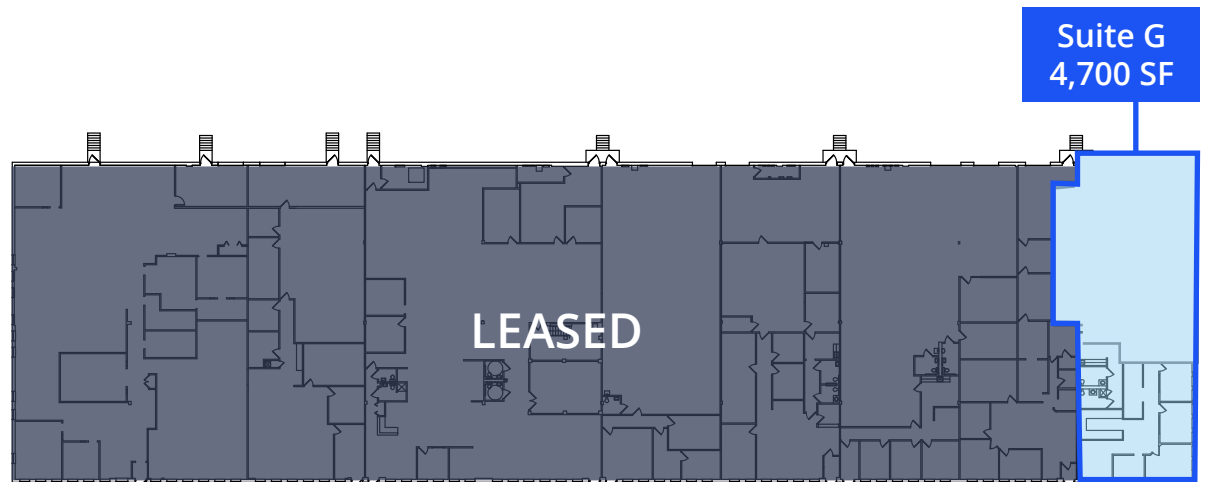

9730 Martin Luther King Jr. Hwy

Property Features

Available Space:	Fully Leased
Building Size:	65,100 SF
Year Built:	1979
Ceiling Height:	15'-17'
Column Spacing:	30' x 30'
Loading:	Dock High
Access:	Located at the intersection of I-495 and Route 50 in Prince George's County

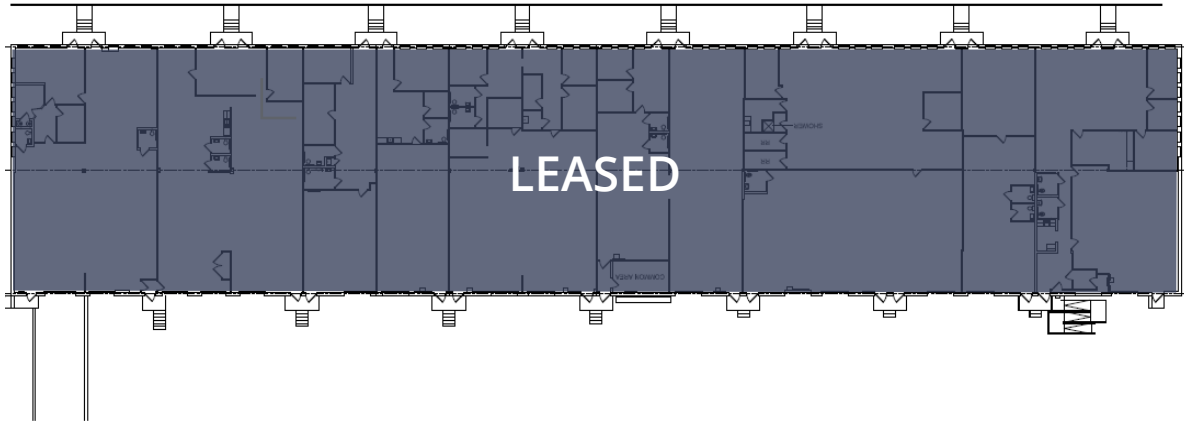

Check back periodically for future availability

Contact

Brian Watts

Executive Vice President
+1 (410) 319-2408
brian.watts@colliers.com

Jason Sullivan, SIOR

Executive Vice President
+1 (410) 319-2409
jason.sullivan@colliers.com

Tom Gentner

Executive Vice President
+1 (410) 319-2407
tom.gentner@colliers.com

Brian Siegel, SIOR

Executive Vice President
+1 (410) 319-2410
brian.siegel@colliers.com

Melissa Parrish

Associate Vice President
+1 (410) 319-2412
melissa.parrish@colliers.com



Colliers

7001 Columbia Gateway Dr
Suite 220
Columbia, MD 21046
+ 1 410 319 2408



4720 Boston Way

Boston Way

Forbes Blvd

Martin Luther King Jr. Hwy

9730 Martin Luther King Jr. Hwy

9700 Martin Luther King Jr. Hwy

This document has been prepared by Colliers for advertising and general information only. Colliers makes no guarantees, representations or warranties of any kind, expressed or implied, regarding the information including, but not limited to, warranties of content, accuracy and reliability. Any interested party should undertake their own inquiries as to the accuracy of the information. Colliers excludes unequivocally all inferred or implied terms, conditions and warranties arising out of this document and excludes all liability for loss and damages arising there from. This publication is the copyrighted property of Colliers and/or its licensor(s). ©2026. All rights reserved.