

± 7,140 SF OFFICE SPACE AVAILABLE FOR LEASE

FALLS TOWER

355 S MAIN ST | GREENVILLE, SC

CBRE



CAMPERDOWN



LOCATED ON 1ST FLOOR OF FALLS TOWER

FALLS TOWER

PROPERTY DETAILS

Overlooking Greenville’s iconic Falls Park and adjacent to the celebrated Peace Center in the heart of downtown, the Camperdown development has elevated Greenville’s Main Street experience to new heights.



LEASE RATE: \$45/SF
FULL SERVICE



COVERED
OUTDOOR PATIO



ACCESS TO ONSITE GYM,
ROOFTOP & CONFERENCE
ROOM



OFFICE AMENITIES



100+ PERSON CONFERENCE ROOM



COMPLETE GYM FACILITIES: EQUIPMENT, LOCKER ROOMS, & SHOWERS

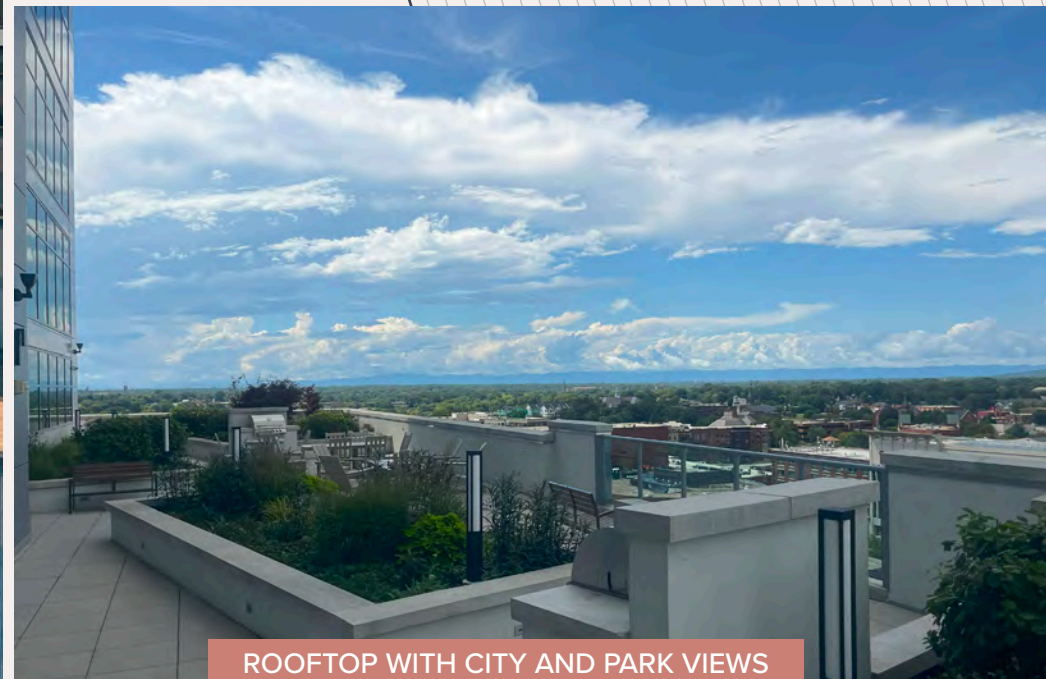

ROOFTOP WITH CITY AND PARK VIEWS

FLOOR PLAN

± 7,140 SF TOTAL AVAILABLE

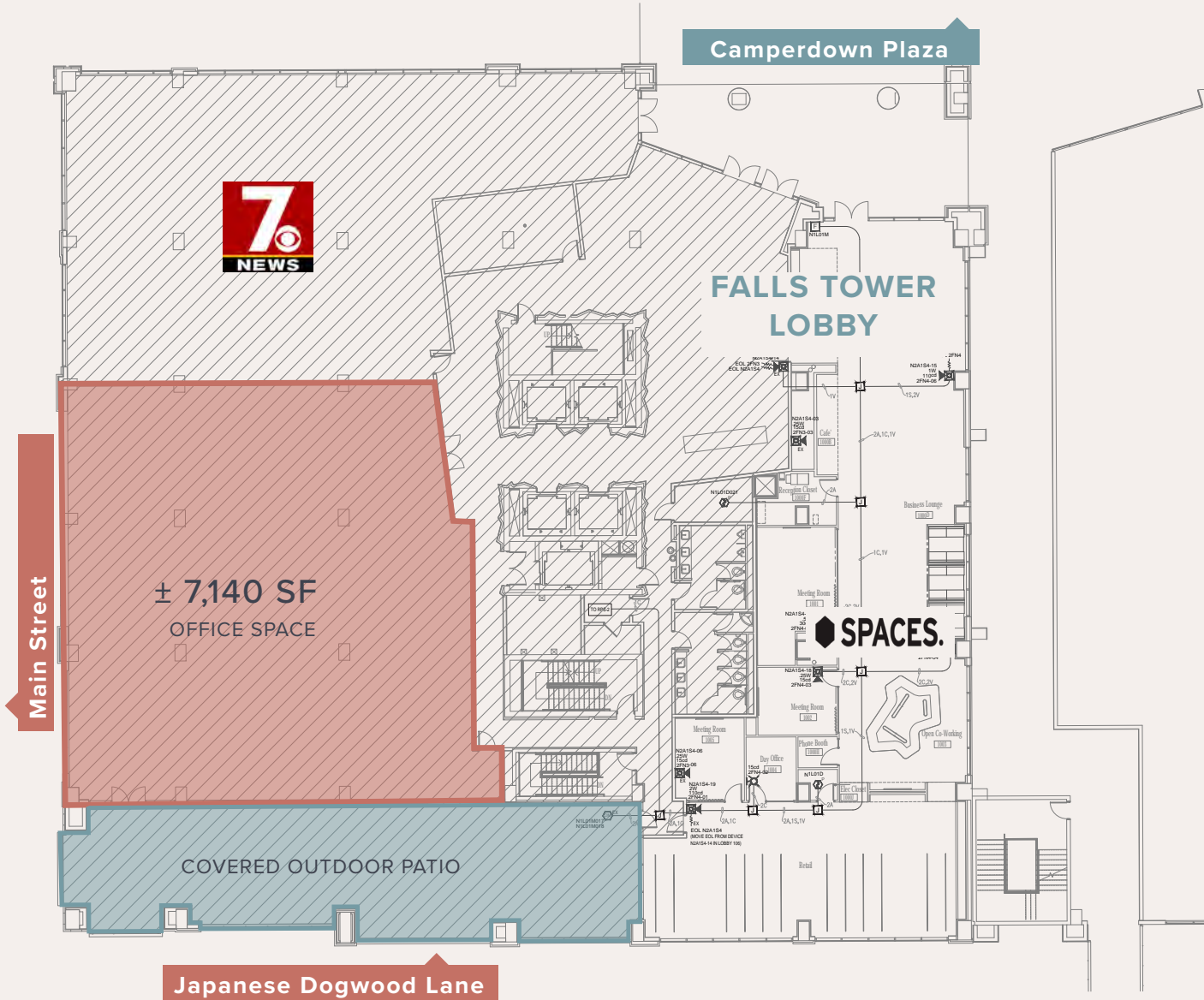

FALLS TOWER

355 S MAIN ST GREENVILLE, SC

CONTACT US

Charles Gouch, CCIM, SIOR
Senior Vice President
+1 864 527 6035
charles.gouch@cbre.com

Blaine Hart, SIOR
Senior Vice President
+1 864 527 6054
blaine.hart@cbre.com

Shelby Dodson, LEED AP
Senior Vice President
+1 864 527 6022
shelby.dodson@cbre.com

© 2025 CBRE, Inc. All rights reserved. This information has been obtained from sources believed reliable, but has not been verified for accuracy or completeness. You should conduct a careful, independent investigation of the property and verify all information. Any reliance on this information is solely at your own risk. CBRE and the CBRE logo are service marks of CBRE, Inc. All other marks displayed on this document are the property of their respective owners, and the use of such logos does not imply any affiliation with or endorsement of CBRE. Photos herein are the property of their respective owners. Use of these images without the express written consent of the owner is prohibited.



CAMPERDOWN

CBRE