

OFFICE BUILDING FOR SALE



651 MAIN ROAD

Tiverton, RI 02878

WHITNEY RUGG

Broker Associate
401.751.3200 x3302
whitney@mgcommercial.com

LEEDS MITCHELL IV, SIOR

Principal Broker, Partner
401.751.3200 x3307
leeds@mgcommercial.com

MG COMMERCIAL

365 Eddy Street, Penthouse Suite
Providence, RI 02903
401.751.3200 | mgcommercial.com

EXECUTIVE SUMMARY



PROPERTY DESCRIPTION

5,699 SF mixed-use building on 0.839 acres. 3 commercial office suites with a 3-br apartment, 1,200 SF detached garage-workshop with overhead door, central A/C, heat, and 1/2 bath. Ample parking with curb cuts on Main Road and Pleasant Avenue, 5/1,000 parking off-street. The property offers significant frontage with signage in a premier location surrounded by thriving local and national businesses.

PROPERTY HIGHLIGHTS

- 5,699 SF building
- 4 units
- 5/1000 parking
- 1,200 SF heated and air-conditioned detached garage with 1/2 bath
- Office, retail, mixed-use or residential development

LOCATION DESCRIPTION

The Paquin Insurance Agency building is being offered for sale in Tiverton at 651 Main Road. Located just minutes from Rt. 24 and I-195, this landmark location is available for the first time in over 75 years. Neighbors include Walgreens, CVS, Brown Health, and Bank Newport, just to name a few.

Tiverton, RI, is a picturesque New England town with a rich history and vibrant local community. With easy access to major highways, Providence, Fall River, and Newport are just a short drive away, offering a mix of urban amenities and coastal allure. This prime location presents an exceptional opportunity for investors seeking to establish a presence in a thriving and captivating area.

OFFERING SUMMARY

Sale Price:	\$995,000
Sale Price Reduced From:	\$1,150,000
Building Size:	5,699 SF
Lot Size:	28,745 SF
Number of Units:	4

WHITNEY RUGG
Broker Associate
401.751.3200 x3302
whitney@mgcommercial.com

LEEDS MITCHELL IV, SIOR
Principal Broker, Partner
401.751.3200 x3307
leeds@mgcommercial.com

365 Eddy Street, Penthouse Suite
Providence, RI 02903
mgcommercial.com



ADDITIONAL PHOTOS

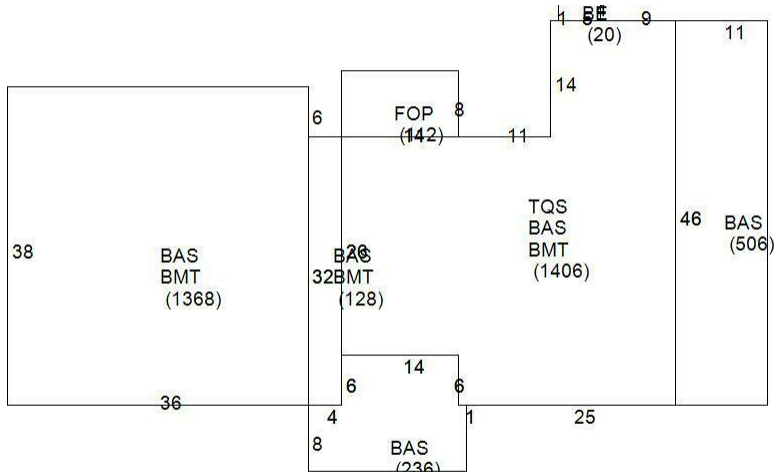

WHITNEY RUGG
 Broker Associate
 401.751.3200 x3302
 whitney@mgcommercial.com

LEEDS MITCHELL IV, SIOR
 Principal Broker, Partner
 401.751.3200 x3307
 leeds@mgcommercial.com

365 Eddy Street, Penthouse Suite
 Providence, RI 02903
 mgcommercial.com



AREA MAP

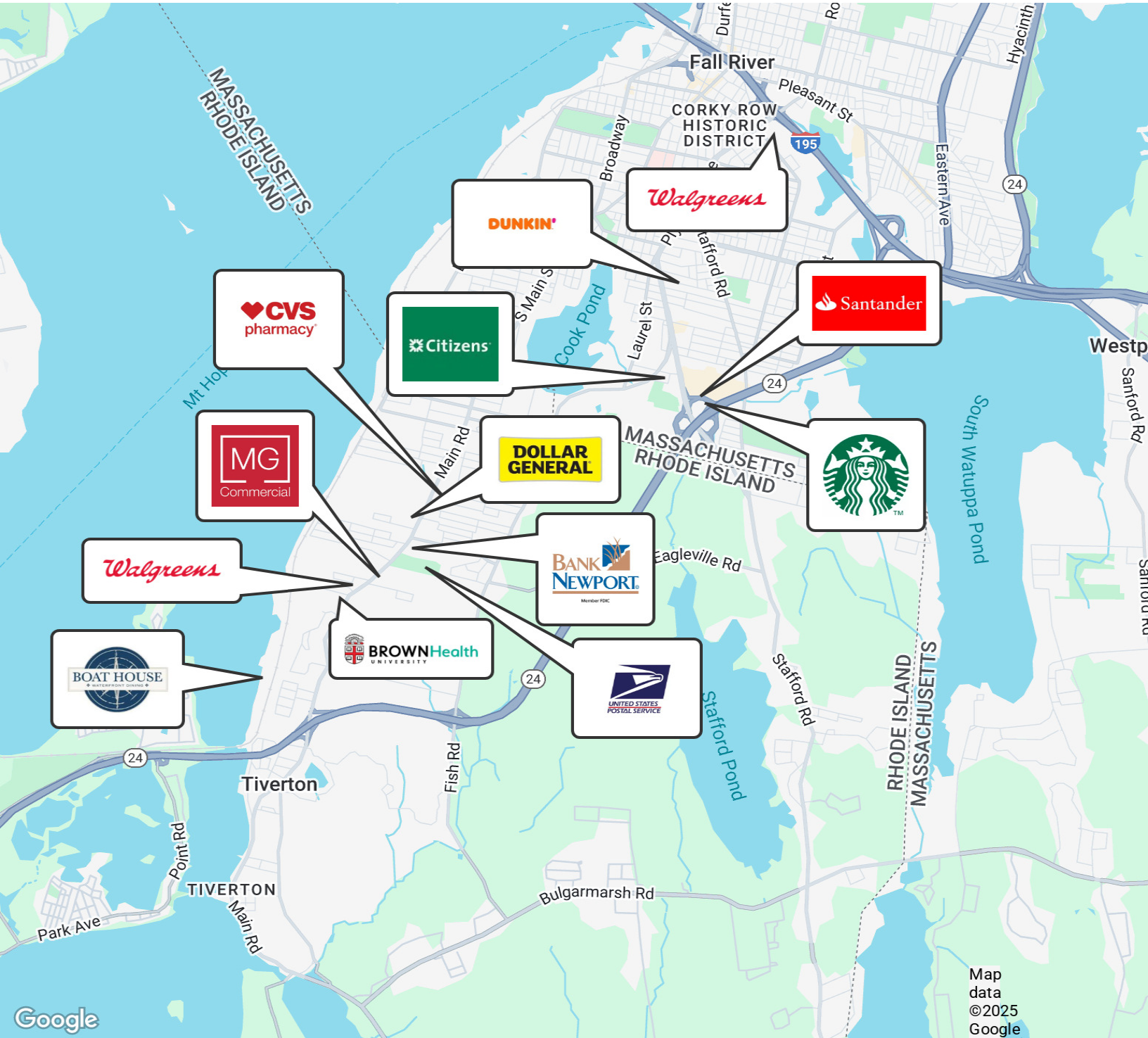

WHITNEY RUGG
 Broker Associate
 401.751.3200 x3302
 whitney@mgcommercial.com

LEEDS MITCHELL IV, SIOR
 Principal Broker, Partner
 401.751.3200 x3307
 leeds@mgcommercial.com

365 Eddy Street, Penthouse Suite
 Providence, RI 02903
 mgcommercial.com

