

SUITE 200 | 2,429 SF

280 SHUMAN BLVD | NAPERVILLE, IL

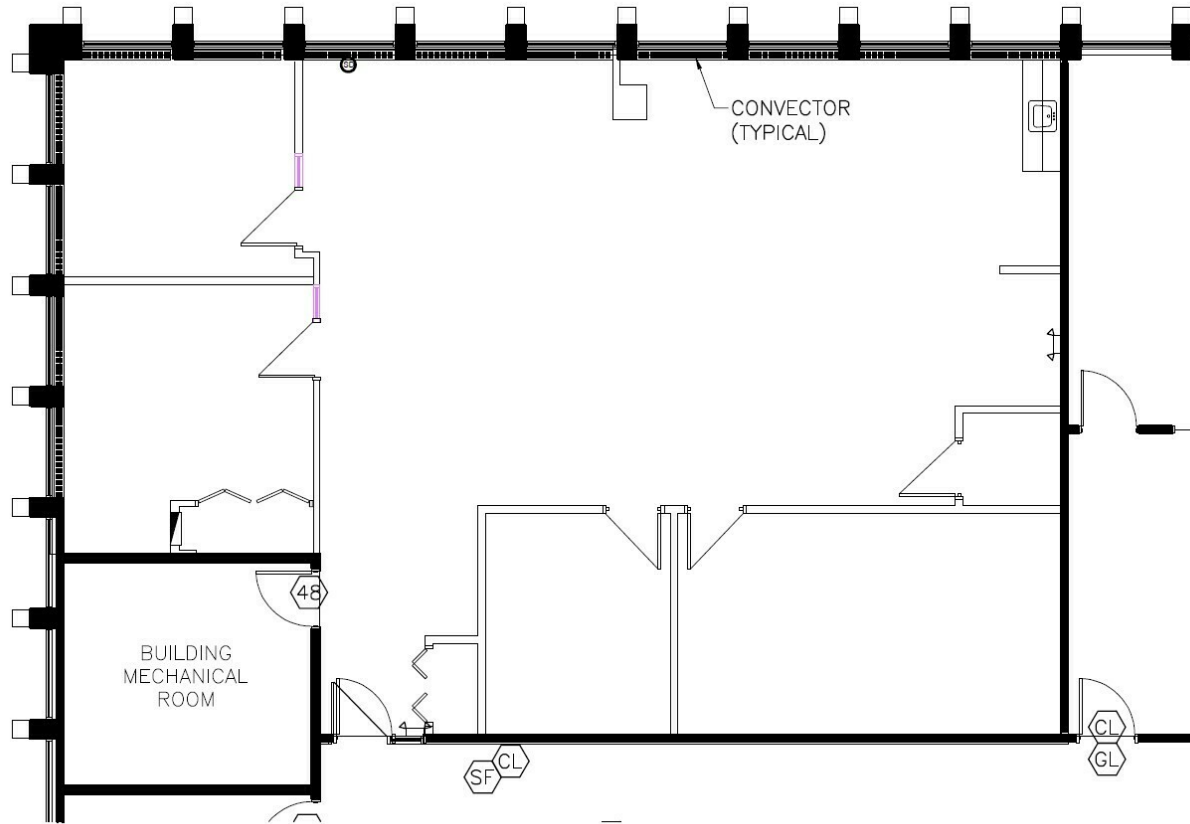

SPACE NOTES

- 3 Private Offices
- Conference Room
- Open Space for Workstation
- Kitchenette
- Floor to Ceiling Windows



RYAN MOEN
630.480.6346
rmoen@versares.com

JOHN MILLNER
630.480.6342
JMillner@VersaRES.com

1 MID AMERICA PLAZA, 3RD FLOOR
OAKBROOK TERRACE, IL 60181
630.480.6413

EXCLUSIVELY LISTED BY

VERSA
REAL ESTATE SERVICES