

9,600 - 23,600 SF
Warehouse Space
Available



1073-1075 HUFF ROAD

AVAILABLE FOR LEASE IN THE UPPER WESTSIDE

1073 HUFF ROAD IS LOCATED IN THE HEART
OF BURGEONING UPPER WESTSIDE NEIGHBORHOOD.

THIS FLEX/SHOWROOM/WAREHOUSE MULTI-TENANT BUILDING
OFFERS MULTIPLE SQUARE FOOTAGE OPTIONS THAT COULD
ACCOMMODATE YOUR CREATIVE WAREHOUSE OR SHOWROOM NEED.



For leasing information contact:
Joseph Rogers // C: 404.550.0817 // jrogers@whnre.com
Jamie Hargather // C: 404.944.4456 // jhargather@whnre.com

SITE PLAN

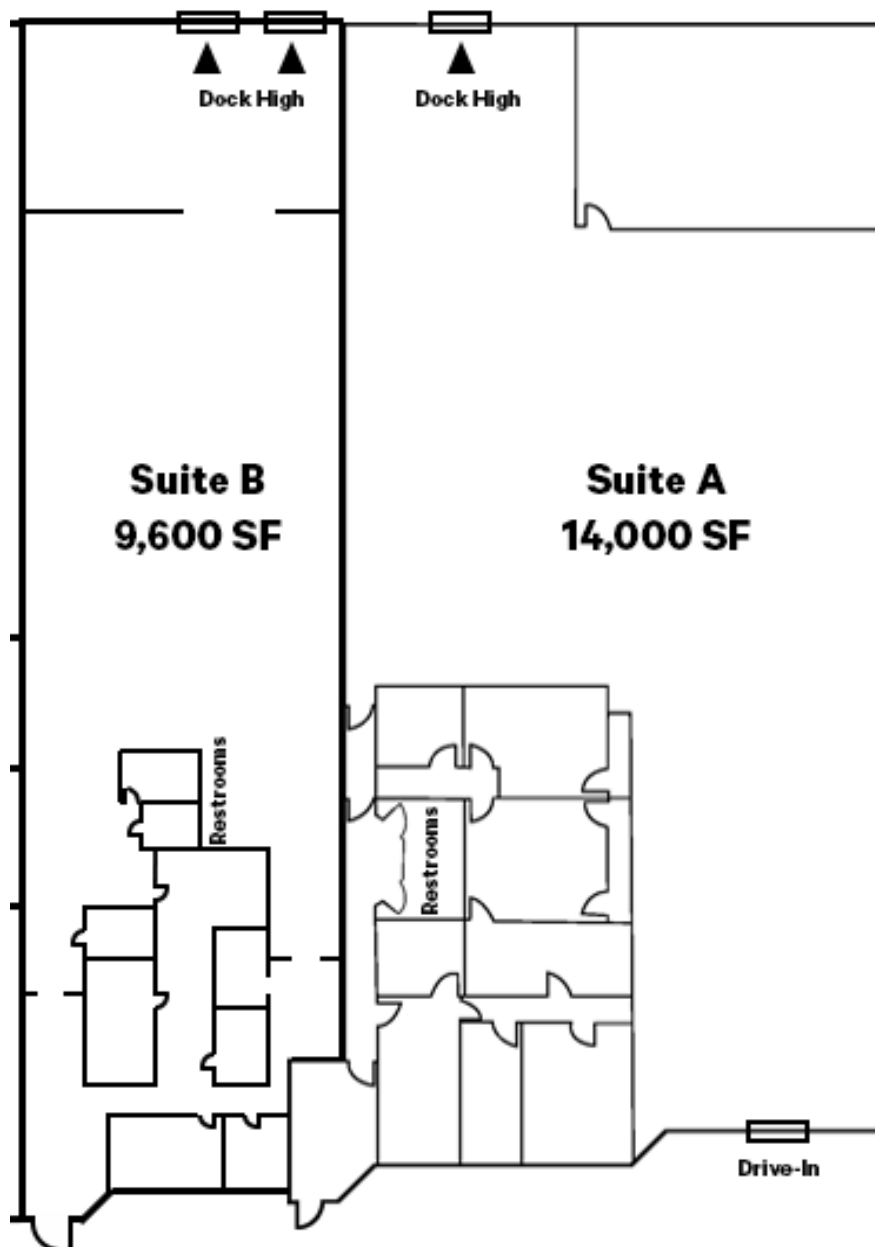

Suite B: 9,600 SF
Office SF: ± 2,000 SF
Loading: 2 DH
Clear Height: 18'

Suite A: 14,000 SF
Office SF: ± 2,500 SF
Loading: 1 DH/1 DI
Clear Height: 18'

