

FOR LEASE

3,850 SF Industrial Unit

1016 S Lawson St | Suite A
City of Industry, CA 91748



Property Highlights

- ±3,850 Sq. Ft. Industrial Unit
- ±2,250 Sq. Ft. of Open Office
- Master Planned Business Park
- One (1) Ground-Level Door (12' x 18')
- Abundant Parking
- Lease rate includes CAM, Water, and Trash Service
- Beautifully Landscaped
- 15' Clear Height

LEASE RATE:

\$1.50 PSF GRS



PROPERTY AERIAL

Pat Bogan

Senior VP | Lic. ID # 01215727

P \\ 909.245.1480

E \\ pbogan@lee-associates.com

Steve Coulter

Senior VP | Lic. ID # 01229849

P \\ 909.287.3488

E \\ scoulter@lee-associates.com

Jamie Scott

Associate | Lic. ID # 02228289

P \\ 714.343.1999

E \\ jscott@lee-associates.com

LEE & ASSOCIATES
COMMERCIAL REAL ESTATE SERVICES

The information contained herein is obtained from sources believed to be reliable. However, we have not verified it and make no guarantees, warranties or representations as to the completeness or accuracy thereof. The presentation of this property is used for example and is submitted subject to errors, omissions, change of price or conditions, and is subject to prior sale, lease or withdrawal without notice.

FOR LEASE

3,850 SF Industrial Unit

1016 S Lawson St | Suite A
City of Industry, CA 91748

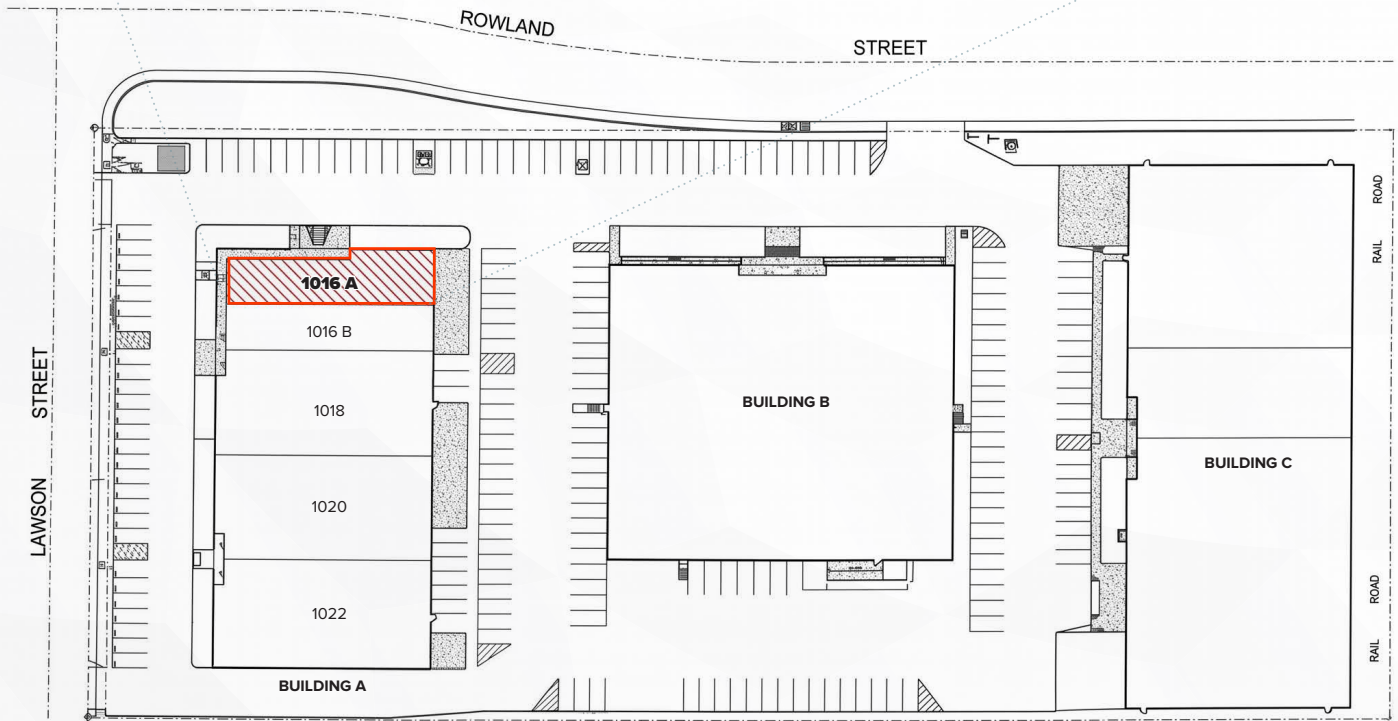
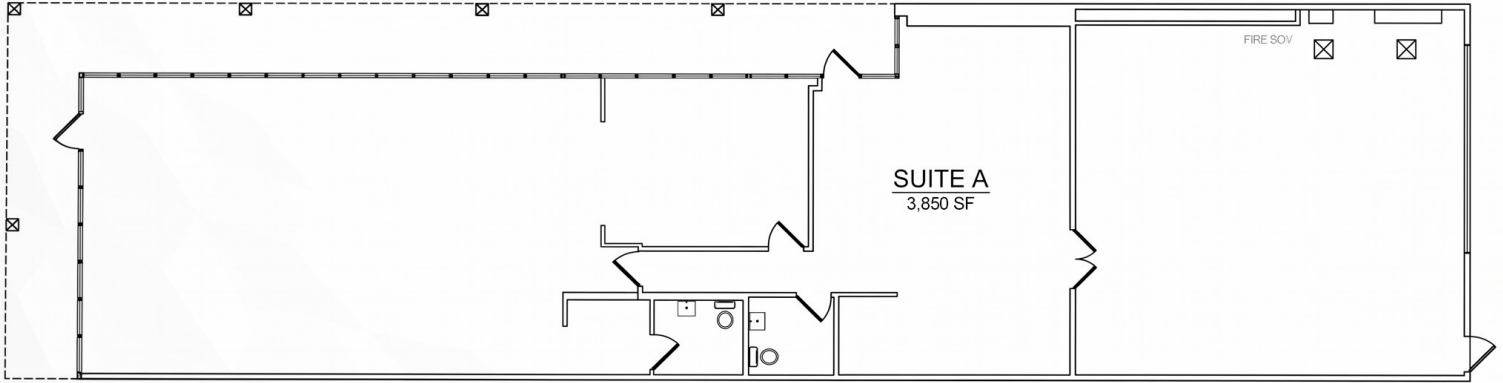

PROPERTY SITE PLAN

Not To Scale/ Not Exact



Pat Bogan

Senior VP | Lic. ID # 01215727

P \\ 909.245.1480

E \\ pbogan@lee-associates.com

Steve Coulter

Senior VP | Lic. ID # 01229849

P \\ 909.287.3488

E \\ scoulter@lee-associates.com

Jamie Scott

Associate | Lic. ID # 02228289

P \\ 714.343.1999

E \\ jscott@lee-associates.com



The information contained herein is obtained from sources believed to be reliable. However, we have not verified it and make no guarantees, warranties or representations as to the completeness or accuracy thereof. The presentation of this property is used for example and is submitted subject to errors, omissions, change of price or conditions, and is subject to prior sale, lease or withdrawal without notice.