



FOR LEASE

2814 Aiello Drive

UNITS B AND C
SAN JOSE, CA 95111

BUILDING SIZE

Unit B - 2,365 SF
Unit C - 2,365 SF
Can be combined for 4,730 SF

LEASE RATE

Unit B - \$1.50 SF/month Gross + \$0.22 SF/month CAM
Unit C - \$1.55 SF/month Gross + \$0.22 SF/month CAM

Property Highlights

Unit B

- 25% HVAC OFFICE
- Reception, Private Office, Open Office Area, File Storage and Copy Area
- Coffee Bar
- +/-300 SF Mezzanine Storage Not Included in Rentable Area
- 14'-16' Clear Height
- Grade-Level Door (10'x12')
- 200 Amps, 208, 3-Phase Power

Unit C

- 25% HVAC OFFICE
- Reception, Private Office, Open Office Area, File Storage and Copy Area
- Coffee Bar
- Temperature and humidity controlled room
- 14'-16' Clear Height
- Grade-Level Door (10'x12')
- 200 Amps, 208, 3-Phase Power

For more information, please contact:

Martin Chiechi

Executive Managing Director
CA RE #00806069
t 408-987-4178
Martin.Chiechi@nmrk.com

3155 Olsen Avenue, Suite 575
San Jose, CA 95117



nmrk.com

NEWMARK

Corporate License #0832933

The information contained herein has been obtained from sources deemed reliable but has not been verified and no guarantee, warranty or representation, either express or implied, is made with respect to such information. Terms of sale or lease and availability are subject to change or withdrawal without notice.

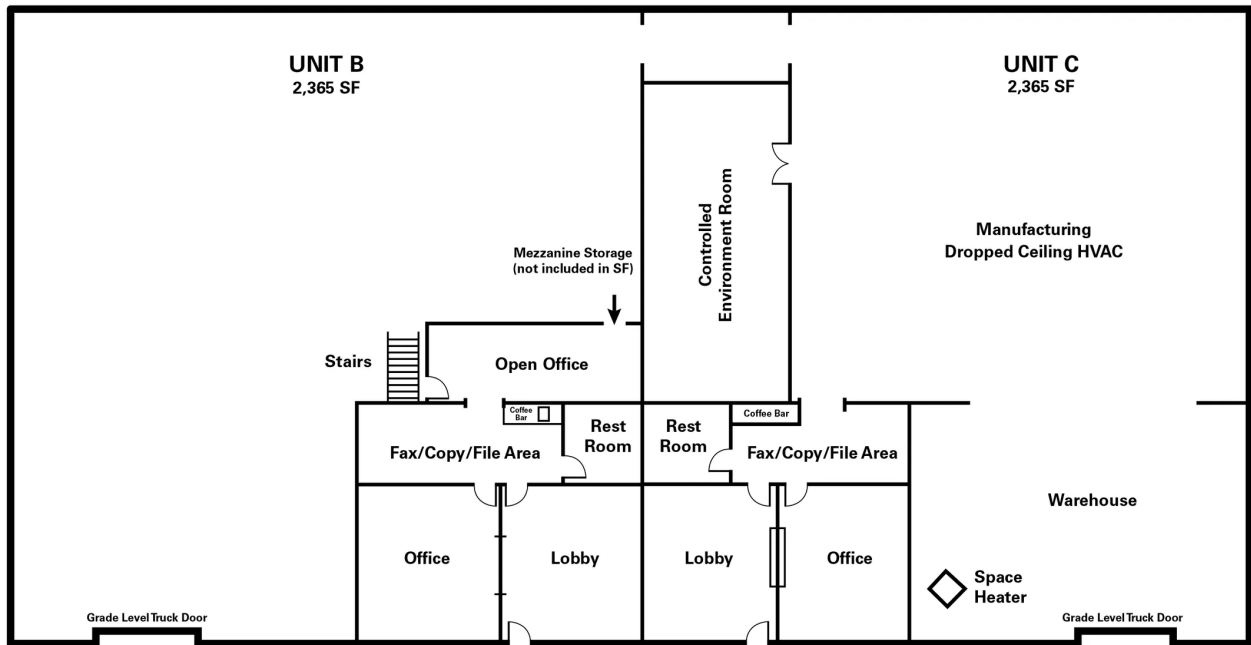

Martin Chiechi

Executive Managing Director

CA RE #00806069

t 408-987-4178

Martin.Chiechi@nmrk.com

2814 AIELLO DRIVE / SAN JOSE, CA 95111

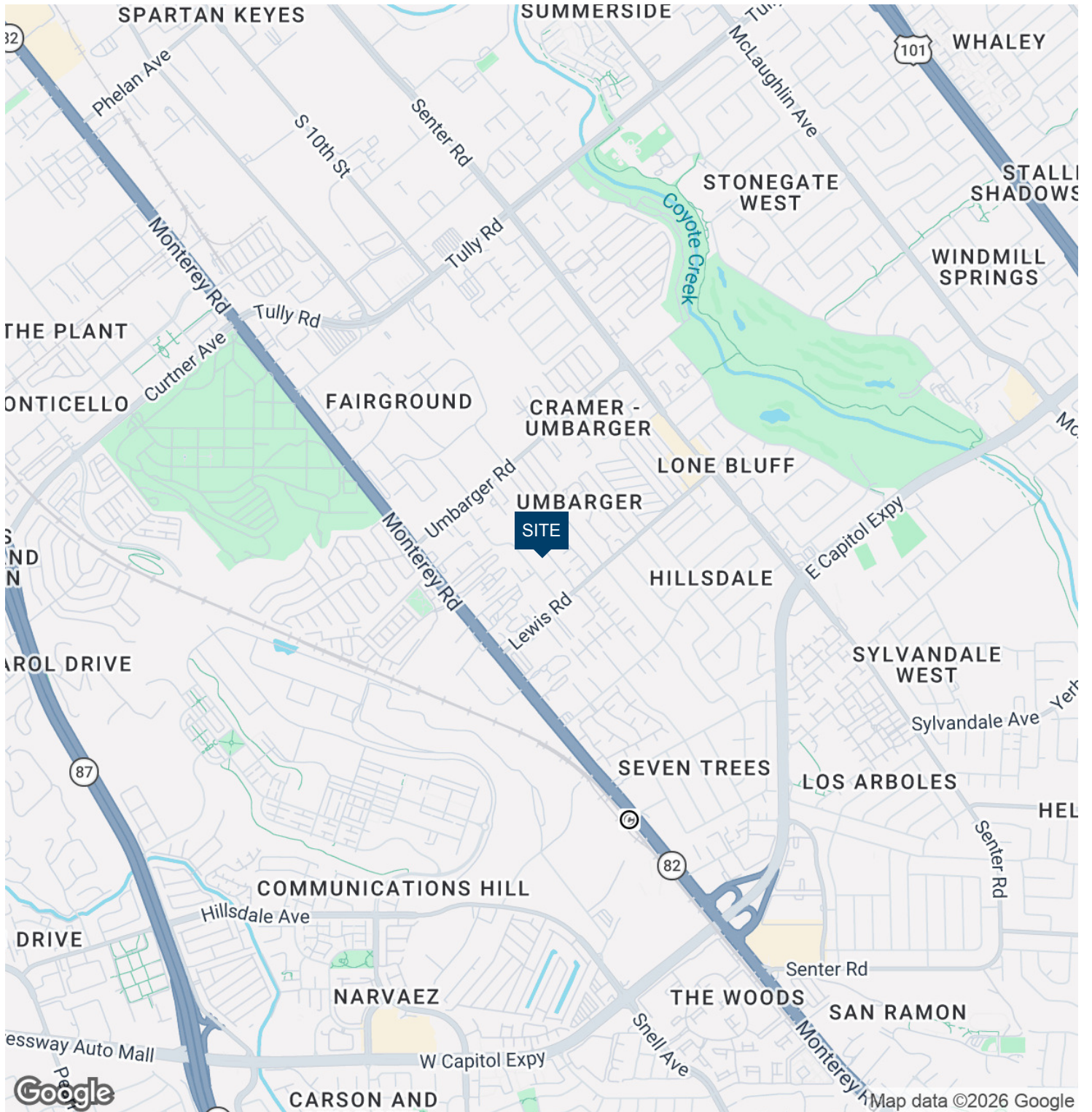

Martin Chiechi

Executive Managing Director

CA RE #00806069

t 408-987-4178

Martin.Chiechi@nrmk.com

