



Property Features

Convenient, high-quality office/warehouse “flex” space available, located in the master-planned 150-acre Chandler Creek Business Park, centered among Round Rock’s premier healthcare, education and retail services.

Building Size: 63,960 Rentable Square Feet

Year Built: 2019

Building Location: Eagles Nest Street near Cypress Boulevard

Parking: 2.04 spaces per 1,000 rentable square feet (rsf)

Notes:

- Easy access to IH-35 and SH-130
- Generous column spacing, 24’ clearance height
- 100% HVAC
- Building Power - 3 phase, 480v/8000a service

Nearby Restaurants: BJ’s, Chick-fil-A, Fuzzy’s Taco Shop, Chipotle, Mighty Fine Burgers, Freebirds World Burrito, Salata, and Zoe’s Kitchen

Contact Information

Rob Marshall

o: (254) 831-9000

m: (254) 421-5757

e: rob@rkmarshall.com

Building K4



Contact Information
Rob Marshall
o: (254) 831-9000
m: (254) 421-5757
e: rob@rkmarshall.com

Suite 420

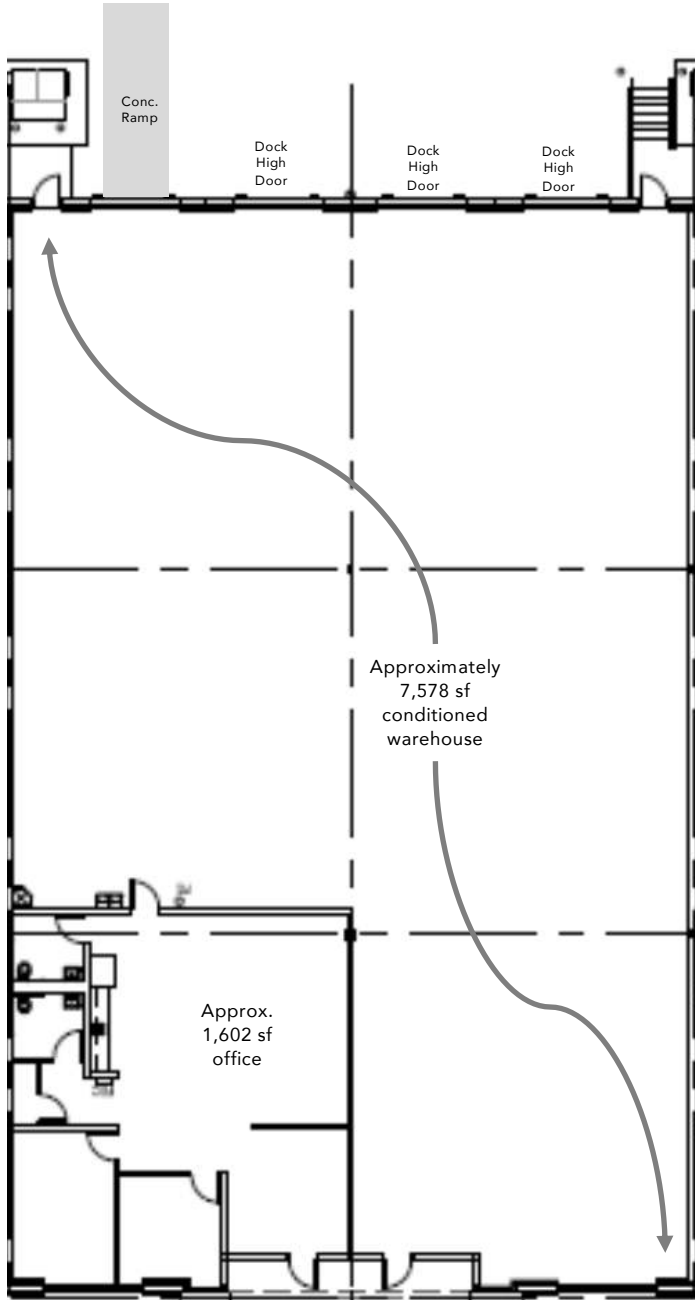
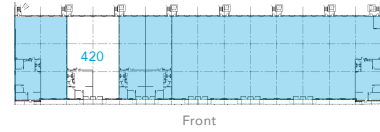

- Available Space:** Suite 420: 9,180 rsf
- Building Type:** Class B Flex
- Space Use:** Flex, industrial (office / warehouse)
- Power:** 400 amp / 480 volt
- Parking Ratio:** 2.04/1,000 Square Feet
- Loading:** 4 Rear load doors, (3 dock high, 1 with concrete ramp)
- Notes:**
 - 100% HVAC
 - Approximately 1,602 sf of office space
 - Generous column spacing, 24' clearance height

Contact Information

Rob Marshall
 o: (254) 831-9000
 m: (254) 421-5757
 e: rob@rkmarshall.com

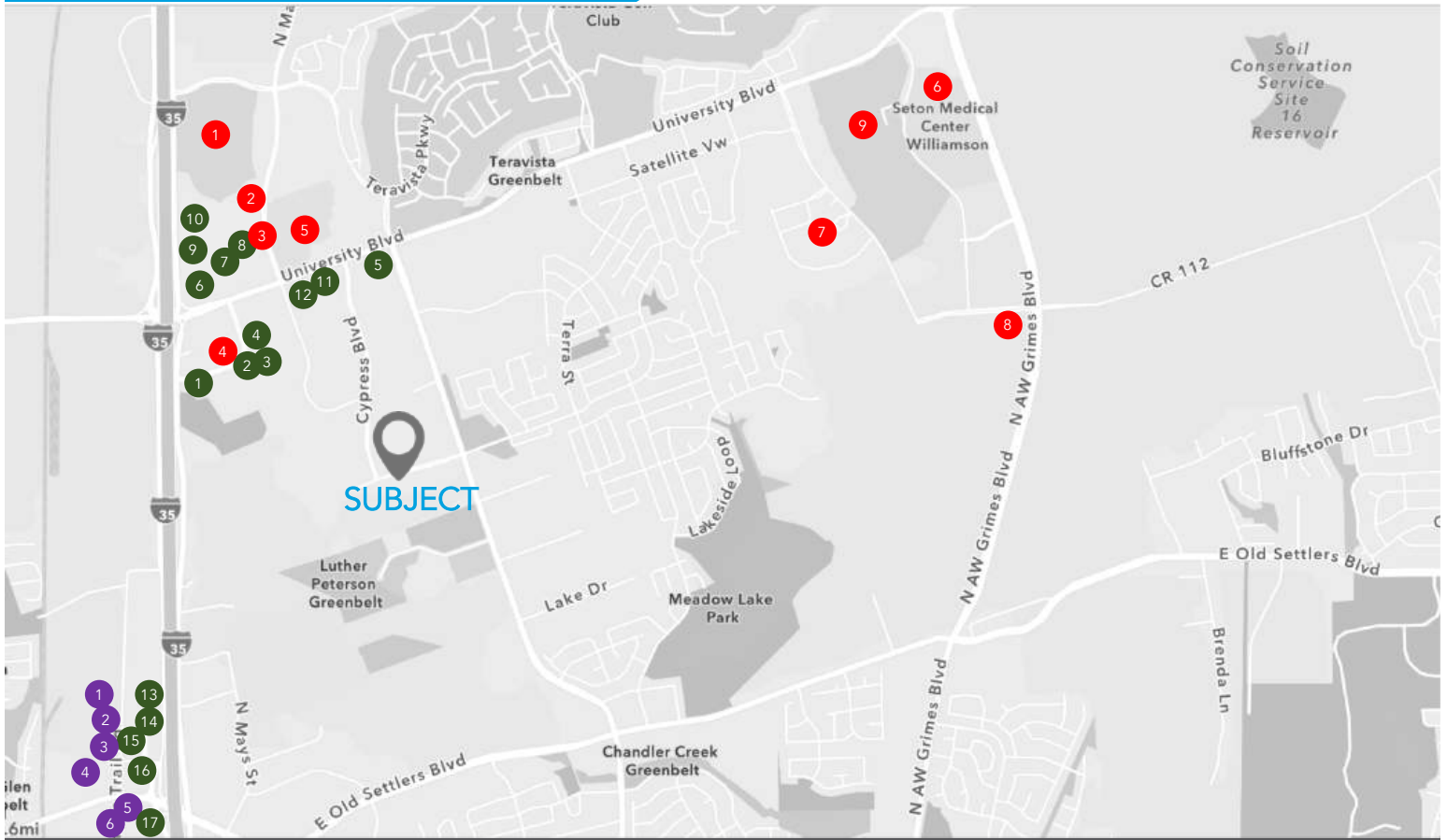

<u>Nearby Restaurants</u>	<u>Points of Interest</u>
1. Panda Express	1. Round Rock Premium Outlets
2. Razoo's	2. Cinemark Movie Theater
3. Chipotle	3. HEB Grocery
4. Raisin Cane's	4. IKEA & University Oaks
5. Starbucks	5. Baylor Scott & White
6. Mimi's Café	6. Seton Medical Center
7. Mooyah Burgers	7. ACC-Round Rock
8. Zoe's Kitchen	8. Texas A&M Health & Sciences
9. BJ's Brewhouse	9. Texas State University-Round Rock
10. In-N-Out Burger	
11. McDonald's	<u>Hotels & Lodging</u>
12. Chick-fil-A	1. Springhill Suites
13. Salt Trader's	2. Tru by Hilton
14. Hopdoddy	3. Courtyard Austin
15. Jack Allen's Kitchen	4. Holiday Inn
16. Rudy's	5. Holiday Inn Express
17. Chuy's	6. Hilton Garden Inn

Drive Times	
IH 35:	3 Minutes
SH 130:	10 Minutes
SH 45:	10 Minutes
Austin Int. Airport:	28 Minutes
Austin CBD:	30 Minutes
San Antonio CBD:	1.75 Hours
Houston CBD:	2.75 Hours
Dallas CBD:	2.50 Hours

Contact Information

Rob Marshall
 o: (254) 831-9000
 m: (254) 421-5757
 e: rob@rkmarshall.com

