

FOR SALE OR LEASE

17,272 SF Available

Former Rite Aid

1325 6TH STREET
NORCO, CA



NEWMARK
PACIFIC

Property Features

- Freestanding Pad Building on almost 2 acres
- Close access to 15 freeway.
- Drive Thru
- Parking: 72 parking stalls (with potential to add additional stalls if drive-thru is removed)
- Monument Signage
- 26,400 Vehicles per day on 6th Street
- 152,000 Vehicles per day on 15 Fwy

 **131-140-0387**
Parcel ID

 **1.76 Acres**
Land Size (Acres)

 **11,440 SF**
Building Size

 **76,665 SF**
Land SF

 **C4**
Zoning



Floor Plan

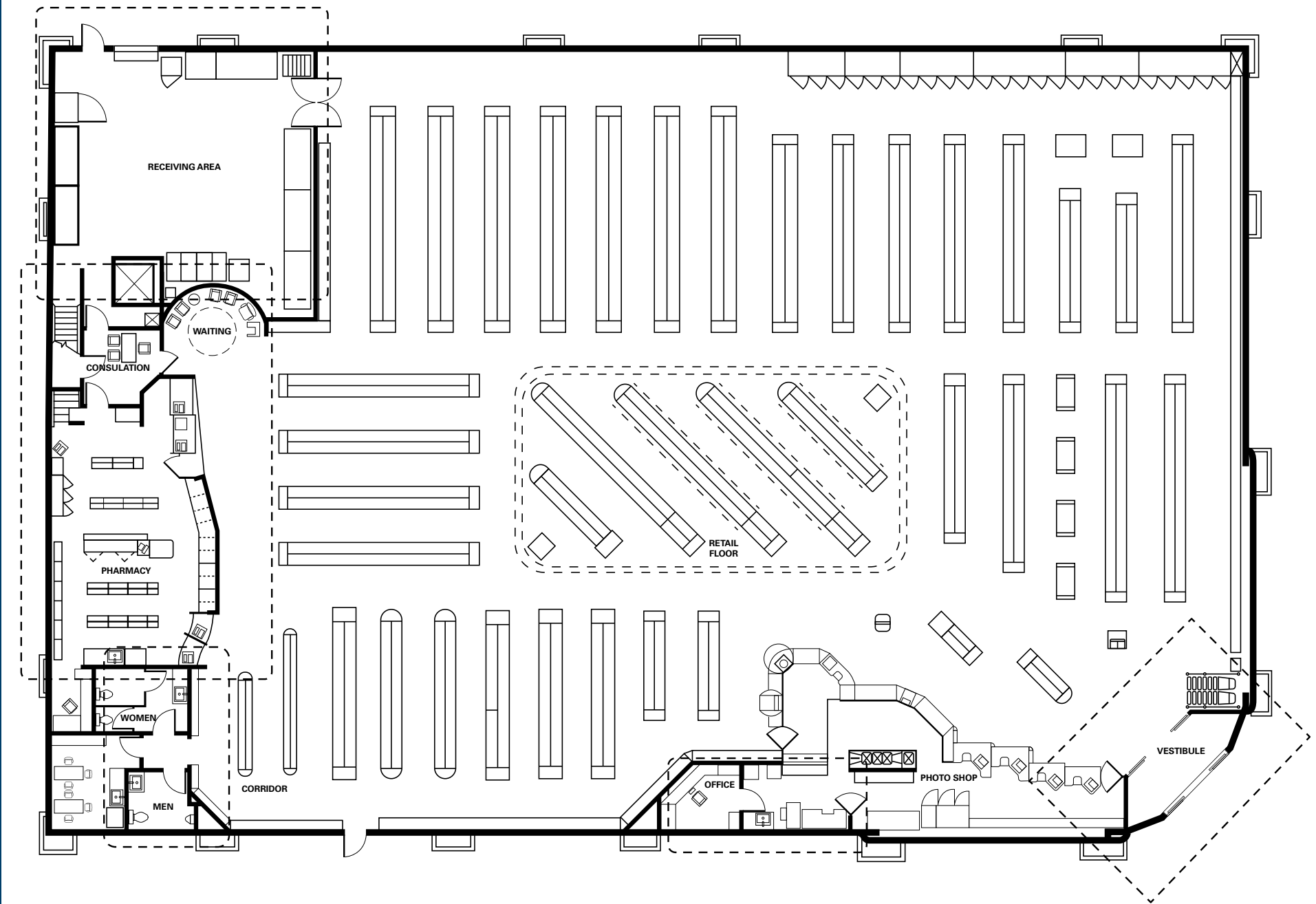



Demographics



POPULATION

1 mile

5,657

3 miles

91,478

5 miles

300,990



EMPLOYEES

1 mile

2,157

3 miles

20,968

5 miles

83,076



HH INCOME

1 mile

\$136,285

3 miles

\$170,606

5 miles

\$137,627



HOUSEHOLDS

1 mile

1,827

3 miles

23,921

5 miles

83,175



Sixth St.

26,400 ADT

Interstate-15

152,000 ADT

Regional Aerial

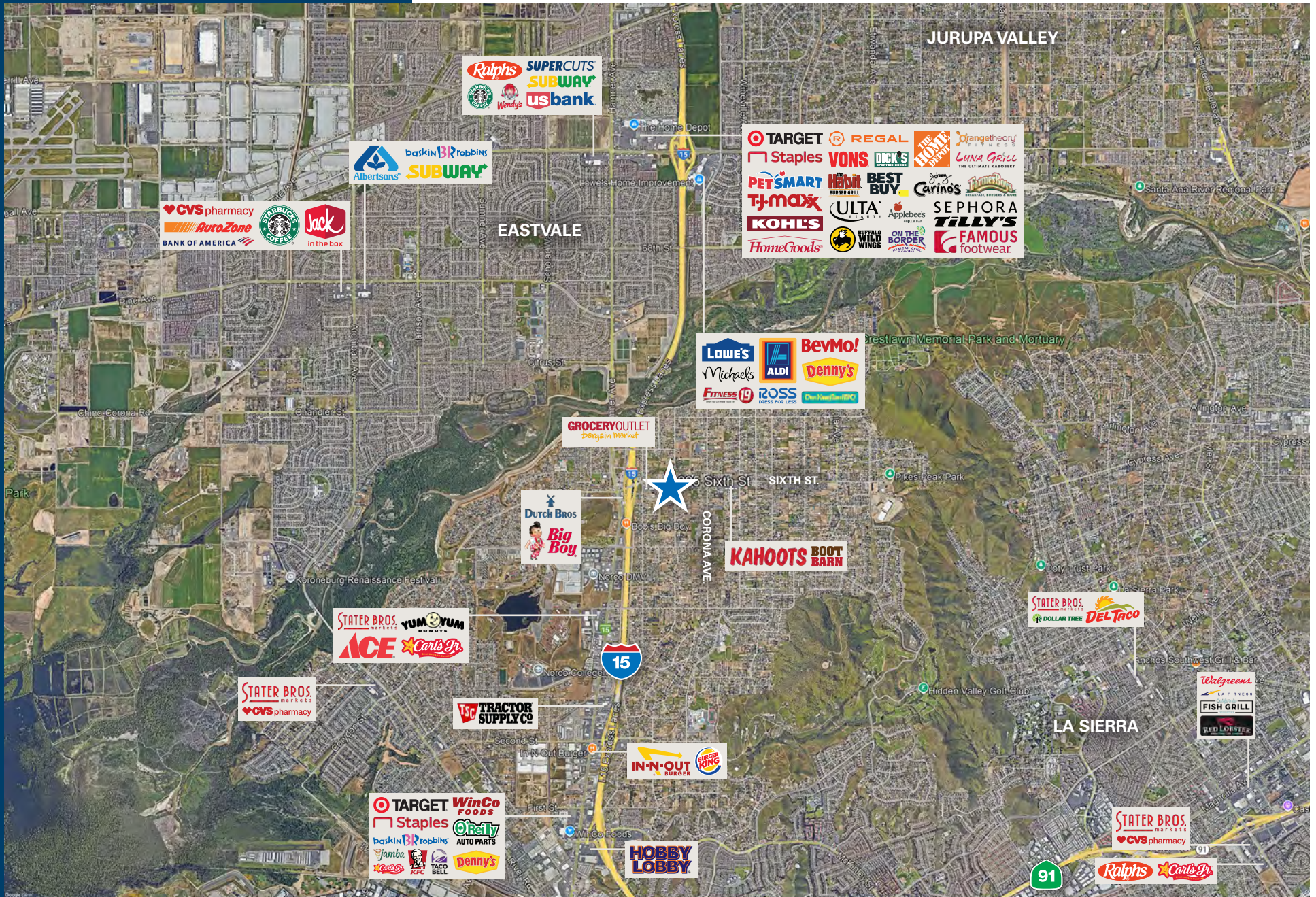

FOR SALE OR LEASE

17,272 SF Available

Former Rite Aid

1325 6TH STREET
NORCO, CA



BRYAN NORCOTT

Executive Managing Director

t 213-298-3595

bryan.norcott@nrmk.com

CA RE Lic. #01200077

STEVE BERNIER

Director

t 310-697-6652

steve.bernier@nrmk.com

CA RE Lic. #02241836

NEWMARK
PACIFIC

CORPORATE LICENSE #01796698

The information contained herein has been obtained from sources deemed reliable but has not been verified and no guarantee, warranty or representation, either express or implied, is made with respect to such information. Terms of sale or lease and availability are subject to change or withdrawal without notice.