

- NOTES:**
- 1.- ALL DOORS 3'-0" X 6'-8" MINWAX GEL SLIM # 602 CLEAR POLYURETHANE (SA
  - 2.- ALL FLOORS CARPETED EXC KITCHENETT WHERE EXISTING CARPET TO BE WILLOW MIST SHAW CARPETS, COLLABORA
  - 3.- ALL WALLS PAINTED ONE CO ONE FINISH COAT SHERWIN #6429
  - 4.- INSTALL 4" VINYL WALL BA COLOR

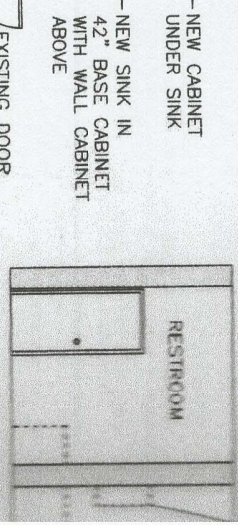

TOTAL FLOOR AREA