

**AVISON
YOUNG**

Maple Hall

For Lease

1522 Polk Street
San Francisco, CA



**Get more
information**

Cameron Baird
415.301.3175
cameron.baird@avisonyoung.com
Re Lic: #01503816

Andrew Rebennack
415.349.3392
andrew.rebennack@avisonyoung.com
Re Lic: #02025935

About Maple Hall

1522 Polk Street
San Francisco, CA
Built 1906

Maple Hall in Polk street was the scene of a delightful party during the last week when the members of the social club of the Native Sons and Daughters of the Golden West held an informal dance. The hall was simply but tastefully arranged with quantities of greens and flowers in the colors of the organization. Among those who attended the affair were:

Miss Cathryn Flint	Miss Frieda Kaiser
Miss Viola Lambert	Miss Sophie Peterson
Miss Marion Nickel	Miss L. Erb
Mr. and Mrs. Carl Eisenschimmel	Miss Mary McGugan
Mr. and Mrs. J. Welsley	Miss Hildebrand
Mr. and Mrs. J. Rose	Miss May Edler
Mr. and Mrs. Mark Noon	Miss A. Himlet
Mr. and Mrs. J. Santer	Miss E. Heuter
Mr. and Mrs. Julius Godeau	Miss C. Rose
Dr. and Mrs. W. Martin	Miss N. B. Mayers
Mr. and Mrs. M. Weiss	W. Bradley
Mr. and Mrs. L. W. Schippler	Louis Erb
Mr. and Mrs. N. Dressler	George Weissel
Miss V. McCreagly	William Martin
Miss M. Starkweather	Herman Quast
	F. Fisher
	W. Eisenschimmel
	Richard Rowen
	Archer Gray
	W. Weiss
	M. Morrell

THE SAN FRANCISCO CALL, SUNDAY, JULY 14, 1912.

Maple Hall is a turn of the century building constructed in 1906 and believed to have been originally owned by prominent real estate investor Henry E. Bothin. The original building was designed by Frank van Trees, known for his fancy Pacific Heights mansions like the Koshland Mansion and Chateau Bleu.

In 1917 and through the mid 60's the ground floor of Maple Hall housed Tarantino & Sons & Poultry, a large supplier of many restaurants and privately-owned grocery stores in and around San Francisco, Oakland, the Peninsula, and the South Bay. Through the middle of the 20th century, the 2nd floor was an attractive jazz and dance hall. Not only did it host music pioneers like Jelly Roll Morton and local legend Vernon Alley, it also held early political rallies.



Source: <https://diva.sfsu.edu/collections/timelineproject/bundles/235642>



Source: <https://diva.sfsu.edu/collections/timelineproject/bundles/235642>

Maple Hall For Lease

1522 Polk Street
San Francisco, CA

Ownership is willing to contribute delivery work and TI for a new tenant, subject to term, credit, and deal terms.

Overview

Size: ±7,216 sf
Available: Immediately
Rent: Negotiable
Zoning: NC-D

Space Highlights



Dramatic ceiling heights



Potential for expanded dramatic ground floor lobby entrance with elevator



Great visibility - on the busy Polk Street corridor between California and Sacramento Street



Potential to punch out additional windows and lighting for second floor



Suitable for a variety of uses including business/professional offices, fitness, education and retail sales



Rendering shows proposed lobby and ground floor entry

Cameron Baird

415.301.3175
cameron.baird@avisonyoung.com
Re Lic: #01503816

Andrew Rebennack

415.349.3392
andrew.rebennack@avisonyoung.com
Re Lic: #02025935

**AVISON
YOUNG**

Maple Hall For Lease

1522 Polk Street
San Francisco, CA

2nd Floor Layout

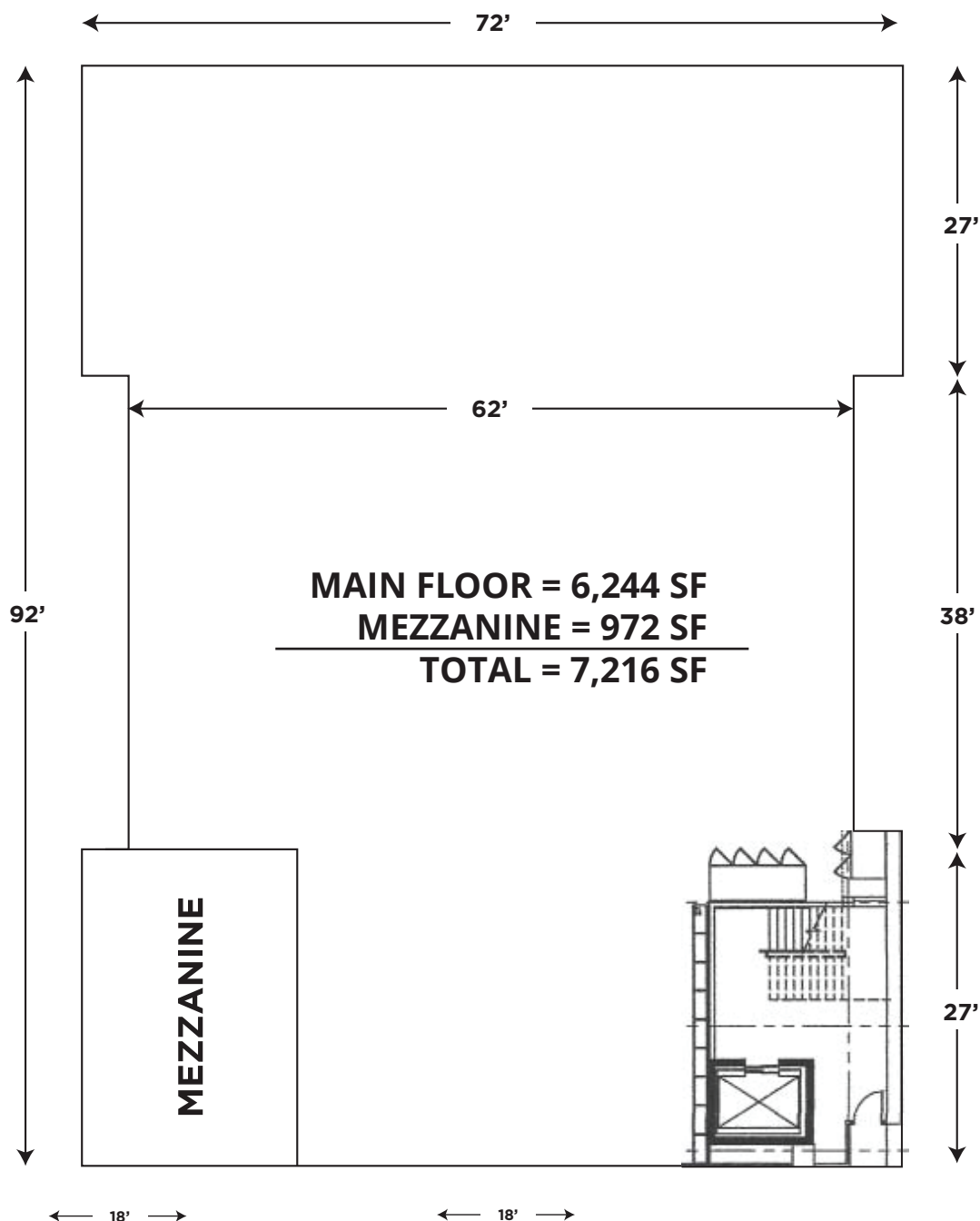

Cameron Baird
415.301.3175
cameron.baird@avisonyoung.com
Re Lic: #01503816

Andrew Rebennack
415.349.3392
andrew.rebennack@avisonyoung.com
Re Lic: #02025935

**AVISON
YOUNG**

Maple Hall For Lease

1522 Polk Street
San Francisco, CA

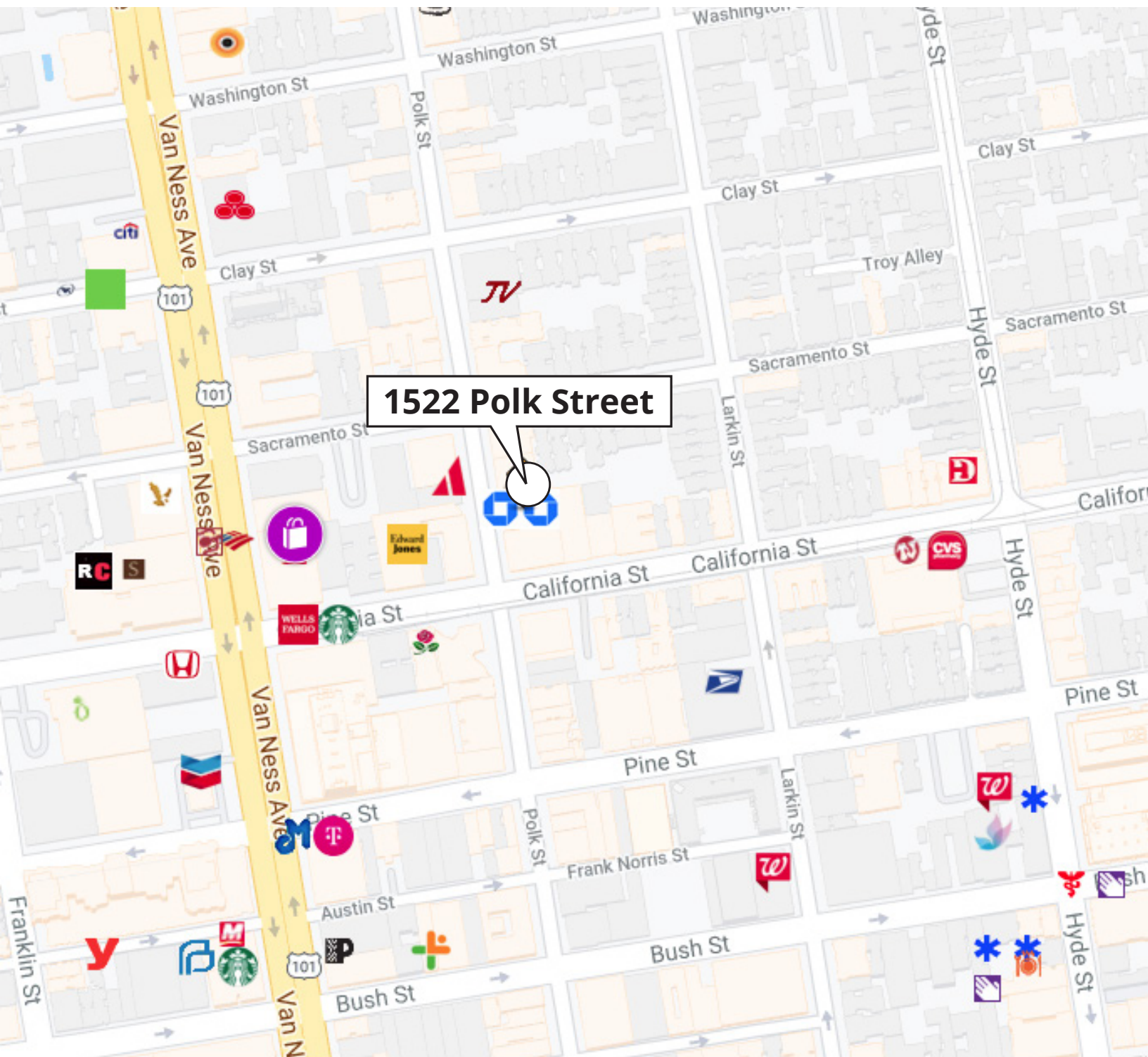

Cameron Baird
415.301.3175
cameron.baird@avisonyoung.com
Re Lic: #01503816

Andrew Rebennack
415.349.3392
andrew.rebennack@avisonyoung.com
Re Lic: #02025935

**AVISON
YOUNG**