

RE/MAX



CRISSMAN
COMMERCIAL SERVICES
LAND LEASING INVESTMENT MANAGEMENT

OFFICE SPACE FOR LEASE AT SUNSET POINTE PLAZA

Flexible Terms & Rent Incentives Available



25129 The Old Road, Stevenson Ranch, CA 91381

+/- 862 to 2,684 SF Available | \$2.80/SF Full Service Gross

VISIT US AT WWW.SUNSETPOINTEPLAZA.COM

CONTACTS:



Aaron Avila

Senior Vice President | DRE #02037778

Office: (661) 295-9300

Cell: (661) 993-9873

Aaron@crissmancommercial.com



Dean Cox

Senior Vice President | DRE #01331788

Office: (661) 295-9300

Cell: (661) 644-6120

Dean@crissmancommercial.com



CRISSMAN
COMMERCIAL SERVICES
LAND LEASING INVESTMENT MANAGEMENT

SUNSET POINTE PLAZA



This information contained herein was obtained from sources deemed to be reliable; however Crissman Commercial Services and RE/MAX of Santa Clarita make no guarantees, warranties or representations as to the completeness or accuracy thereof. | DRE #01013938

RE/MAX of Santa Clarita - Crissman Commercial Services is proud to present the Sunset Pointe Plaza Office Building. Conveniently located just off of the 5 Freeway in Stevenson Ranch, CA. Sunset Pointe Plaza offers newly renovated office spaces in a variety of configurations. Sunset Pointe Plaza has abundant parking and is in close proximity to a wide variety of amenities. Call us to book a tour today. 661-295-9300

SUITE #	SIZE (Rentable SF)	AVAILABLE	ASKING RATE
214	862	30 Days	\$2.80/SF/FSG
305	2,684 SF	Now	\$2.80/SF/FSG





- MOVE IN INCENTIVES AVAILABLE
- NEWLY RENOVATED SUITES, RESTROOMS & COMMON AREAS
- PROFESSIONALLY MANAGED
- CLOSE PROXIMITY TO I-5 FREEWAY
- NEAR A WIDE VARIETY OF AMENITIES
- 24/7 ACCESS
- USPS BOX ON SITE
- SUITES & COMMON AREAS CLEANED DAILY
- SECURITY SYSTEM THROUGHOUT COMMON AREAS
- ABUNDANT PARKING



Suite 214: 2nd Floor

862 Square Feet

- Two Private Offices & Large Bullpen Area
- Large Windows / Natural Light
- Copy/Break Room/Storage Area

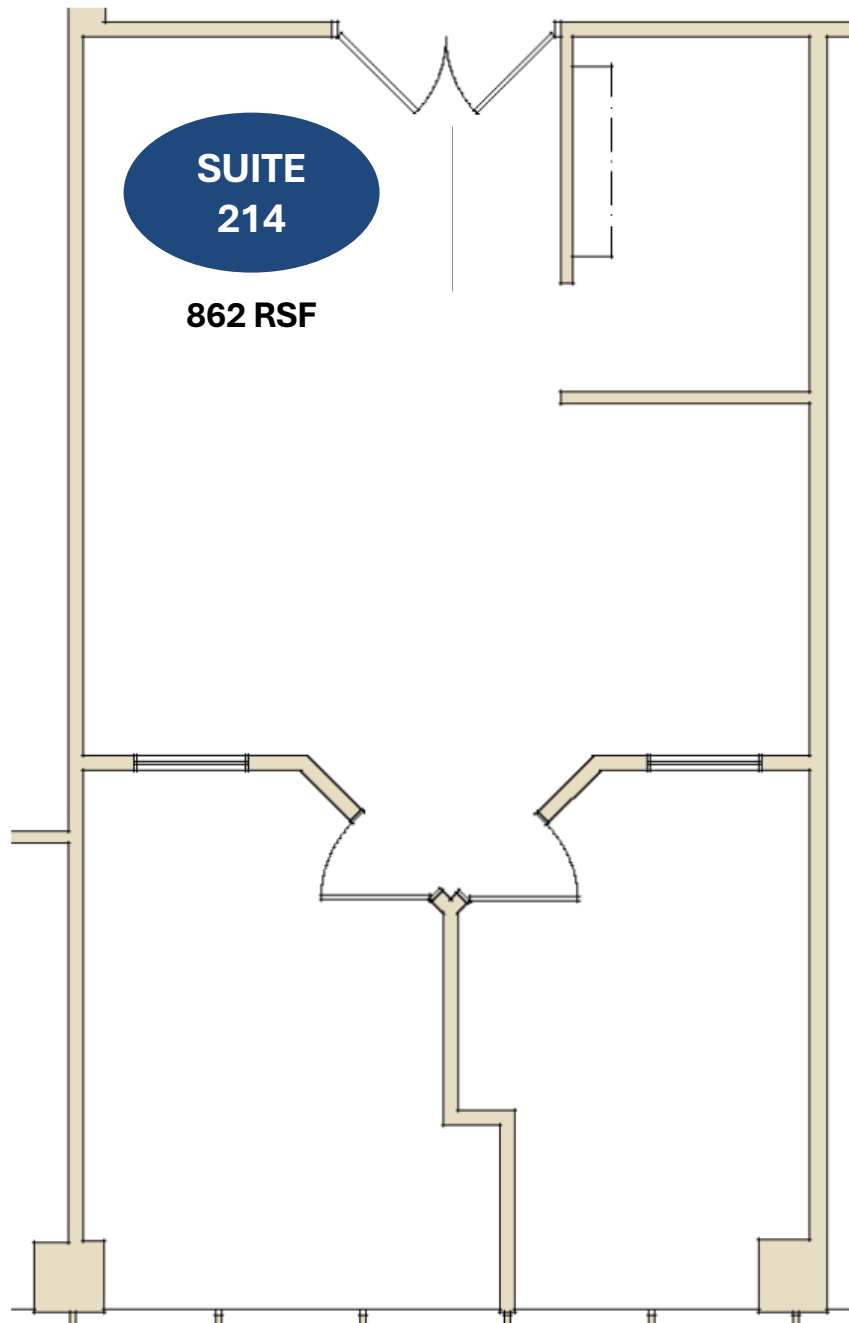



Suite 305: 3rd Floor

2,684 Square Feet

- Four Private Offices & Large Bullpen Area
- Large Windows / Natural Light
- Copy/Break Room + Storage Closet

