



CONTACT

6476 Orchard Lake Rd, STE A
West Bloomfield, MI 48322

P: 248.538.9905 F: 248.538.9905
cmprealestategroup.com

JORDAN JABBORI
jjabbori@cmprealestategroup.com

CHRIS JONNA
cjonna@cmprealestategroup.com

JOIN



**AREA
TENANTS**



1525 MALL RD

Monroe, MI 48162



PROPERTY DESCRIPTION

- Up to 23,904 SF in move-in ready condition located at Mall and Telegraph roads in the heart of the Monroe Shopping District.
- National retailers such as Wal-Mart, Meijer, Lowe's, Kohl's, TJ Maxx and Aldi are operating within the immediate trade area.
- Potential build-to-suit adjacent to the site for up to an additional 10,000 SF.

OFFERING SUMMARY

| | |
|----------------|----------------|
| Lease Rate: | Contact Broker |
| Available SF: | 23,904 SF |
| Building Size: | 23,904 SF |

| DEMOGRAPHICS | 1 MILE | 5 MILES | 10 MILES |
|-------------------|----------|----------|----------|
| Total Households | 1,169 | 24,387 | 40,958 |
| Total Population | 2,820 | 60,867 | 104,682 |
| Average HH Income | \$63,324 | \$59,343 | \$62,239 |

1525 MALL RD

Monroe, MI 48162

Mall Rd

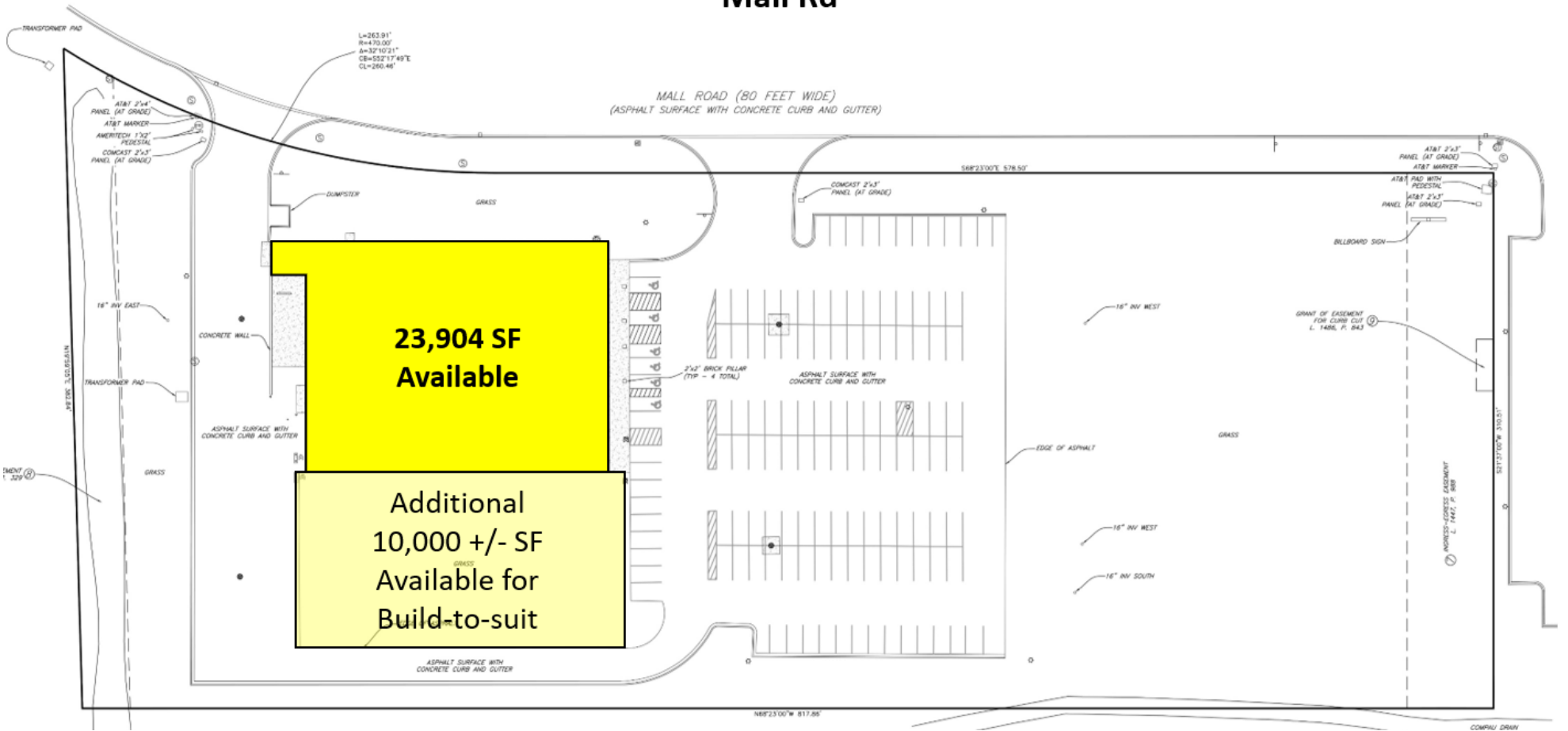

Telegraph Rd

1525 MALL RD

Monroe, MI 48162



1525 MALL RD

Monroe, MI 48162

| POPULATION | 1 MILE | 5 MILES | 10 MILES |
|----------------------|-----------|-----------|-----------|
| Total Population | 2,820 | 60,867 | 104,682 |
| Average Age | 39.8 | 38.8 | 38.8 |
| Average Age (Male) | 38.9 | 37.3 | 37.8 |
| Average Age (Female) | 40.9 | 39.8 | 39.5 |
| HOUSEHOLDS & INCOME | 1 MILE | 5 MILES | 10 MILES |
| Total Households | 1,169 | 24,387 | 40,958 |
| # of Persons per HH | 2.4 | 2.5 | 2.6 |
| Average HH Income | \$63,324 | \$59,343 | \$62,239 |
| Average House Value | \$166,204 | \$133,916 | \$145,390 |

* Demographic data derived from 2010 US Census

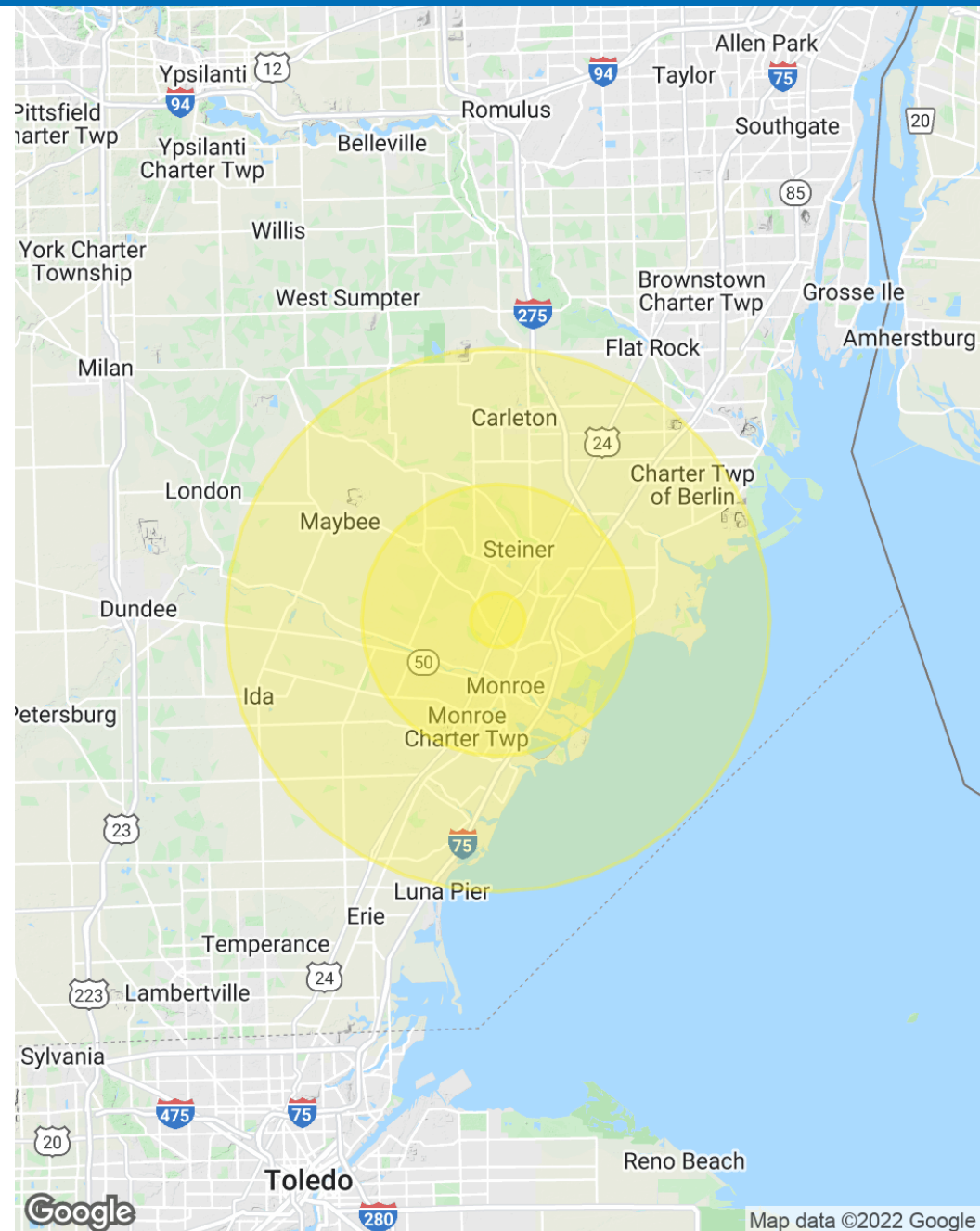



Specializing in retail real estate services, our team is committed to working with each client in to achieve their objectives from assisting with project leasing, site selection, acquisitions/dispositions of income producing properties or property management.

CONTACT

6476 Orchard Lake Road, Suite A
West Bloomfield, Michigan 48322

P: 248 538 2000
F: 248 538 9905

Email: Info@cmprealestategroup.com
Website: www.cmprealestategroup.com

SERVICES

MARKET ANALYSIS

PROPERTY MANAGEMENT

LAND SALES

ACQUISITIONS

TENANT REPRESENTATION

COMMERCIAL LEASING

DISPOSITION

INVESTMENT SALES