

810 Richards Street

Honolulu, HI 96813

AVAILABLE FOR LEASE - SUITE 645

Suite Highlights



- Rental Rate Negotiable
- 983 Square Feet
- Three Open Rooms
- Dual Entrances
- Built-In Cabinetry
- Storage Area

Photos



Available for immediate occupancy, Suite 645 is located on the sixth floor of the tower. This unique office suite has multi-purpose use: reception area with an office and conference room. Or can be arranged for two large office spaces with one reception/waiting area. Front door mail slot and plenty of sunlight enters this suite with Ewa views.

Floor Plan

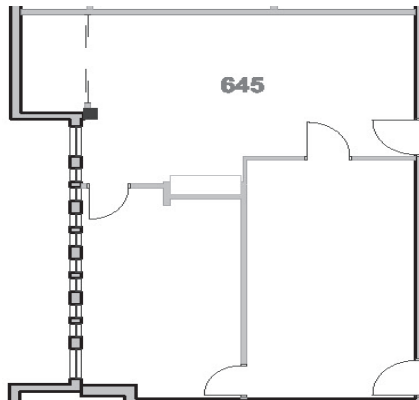

Room 1



Room 2



Room 3

All information contained herein is for advertising and promotional purposes. Data gathered was obtained from sources our brokerage believes to be reliable. Anna International Realty does not guarantee, warrant or represent information is 100% accurate. Interested parties should conduct an independent investigation as to the data provided within this property overview. Facts may be subject to errors, omissions, price changes or other extemporaneous conditions without public notice.



Anna International Realty
Anna Achauer, Principal Broker
+ 1 808 386 7556
info@810Richards.com
www.810Richards.com