

11427 N AR HWY 59 | GRAVETTE, AR 72736

# HWY 59 INDUSTRIAL BUILDING FOR LEASE

BUILDING 2  
22,966 ± SF



# PROPERTY OVERVIEW

**LEASE RATE** \$5.50/SF NNN

**BUILDING SIZE** 22,966 ±SF

- NOTES**
- Fully heated
  - 26' clear height
  - Drive in access located on west side of building
  - 1 dock and 1 drive-in
  - 3-phase power



## AREA DEMOGRAPHICS



**TOTAL POPULATION OF 9,000**



**201 BUSINESSES**



**2,140 EMPLOYEES**



**\$97,162 AVG HOUSEHOLD INCOME**



**2.8 AVG HOUSEHOLD SIZE**



**MEDIAN AGE OF 37.8**

*\*Demographics based on a 5 mile radius. Source: ESRI*

# BUILDING FLOOR PLAN

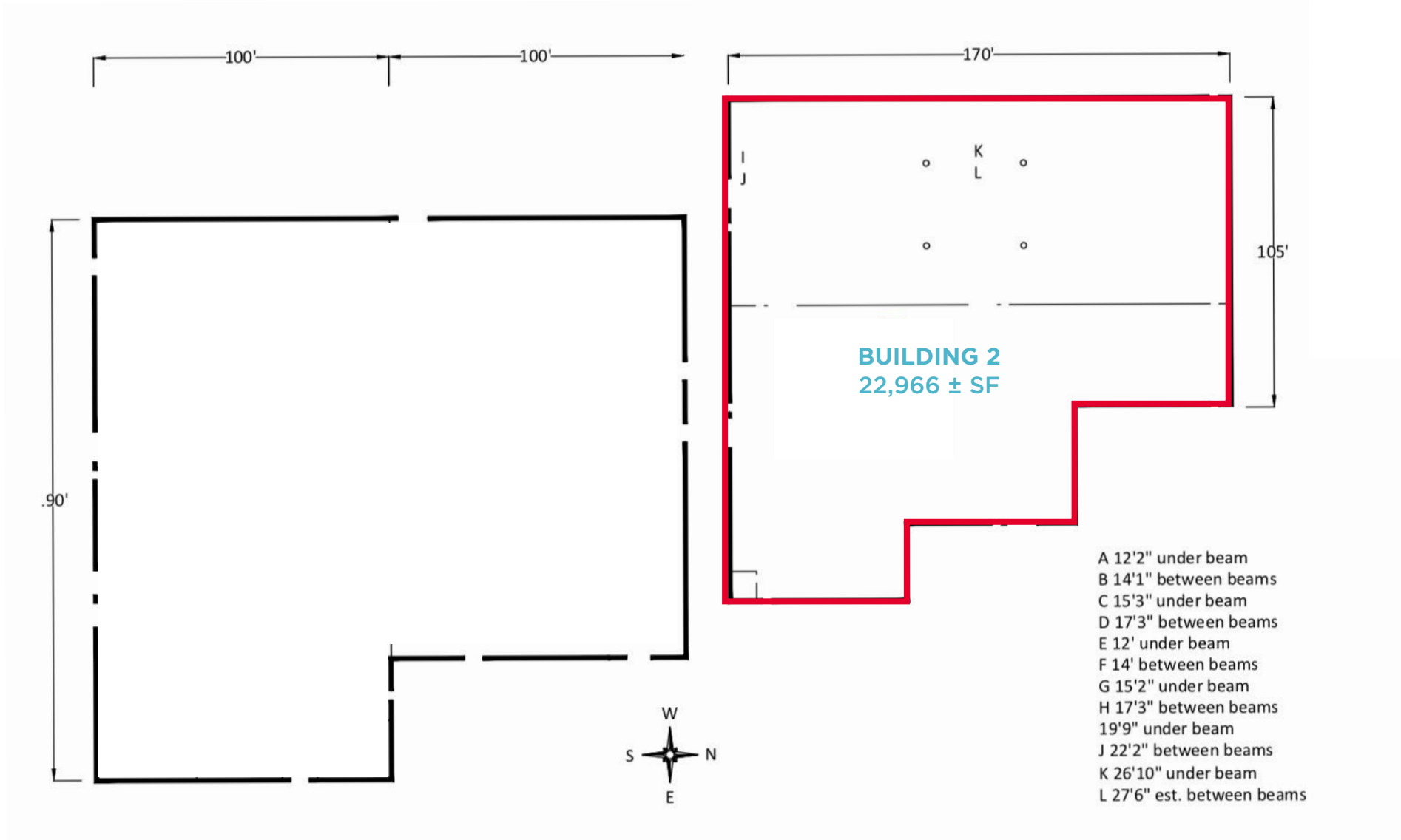



11427 N AR HWY 59 | GRAVETTE, AR 72736

# HWY 59 INDUSTRIAL BUILDING FOR LEASE

BUILDING 2

FOR MORE INFORMATION, PLEASE CONTACT:



**MARSHALL SAVIERS**  
CEO, Principal  
+1 479 422 1620  
mtsaviers@sagepartners.com



**ETHAN FOWLER**  
Associate  
+1 501 590 6544  
efowler@sagepartners.com



**COLBY HOAGLAND**  
Associate  
+1 303 218 8260  
choagland@sagepartners.com

©2024 Cushman & Wakefield. All rights reserved. The material in this presentation has been prepared solely for information purposes, and is strictly confidential. Any disclosure, use, copying or circulation of this presentation (or the information contained within it) is strictly prohibited, unless you have obtained Cushman & Wakefield's prior written consent. The views expressed in this presentation are the views of the author and do not necessarily reflect the views of Cushman & Wakefield. Neither this presentation nor any part of it shall form the basis of, or be relied upon in connection with any offer, or act as an inducement to enter into any contract or commitment whatsoever. NO REPRESENTATION OR WARRANTY IS GIVEN, EXPRESS OR IMPLIED, AS TO THE ACCURACY OF THE INFORMATION CONTAINED WITHIN THIS PRESENTATION, AND CUSHMAN & WAKEFIELD IS UNDER NO OBLIGATION TO SUBSEQUENTLY CORRECT IT IN THE EVENT OF ERRORS.