



4415 SW 29TH STREET | FOR LEASE

OKLAHOMA CITY, OK 73119

**JIM KAREY**

[jkarey@newmarkrp.com](mailto:jkarey@newmarkrp.com)  
O: 405.879.4774 C: 405.203.1303

**NEWMARK**  
ROBINSON PARK

# 4415 SW 29TH STREET | FOR LEASE



## PROPERTY OVERVIEW

Great location with easy access to I-40, I-44, and the Kilpatrick Turnpike. Constructed in 2023, there are multiple bays available, each with 1,912 square feet of space. Each bay includes 144 square feet of air conditioned office space with one space heater in the warehouse area.

Water is included, however, the tenant is responsible for electric and gas.

## DETAILS

Available Bay Size	1,912 SF
Lease Rate per Bay	\$1,900 / Month
Building Size	11,470 SF
Year Built	2023
Zoning	I-2

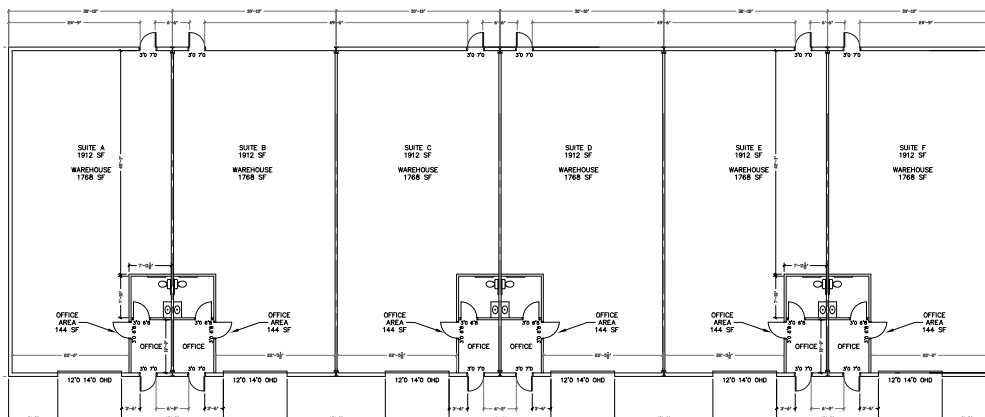

## PROPERTY HIGHLIGHTS

HVAC: office is air conditioned | warehouse has 1 space heater

Office: 144 SF | 1 office and 1 restroom

Grade Level Door: 1 - 12' x 14'

Clear Height: 15'

Electrical: 3-Phase, 200 amps, 220 volts