

2202 MANANA DR | 2202 MANANA DRIVE DALLAS, TX 75220



FOR LEASE



PROPERTY HIGHLIGHTS

Total Contiguous SF: 3,375-6,750 SF

Overhead Doors: Grade Level Loading

Clear Height: 20'

Sprinklered: Fully



GIOVANNI SCARDINO
214.210.6607
giovanni.scardino@streamrealty.com

WILLIAM FAULHABER
214.560.5189
william.faulhaber@streamrealty.com



2202 MANANA DR

2202 MANANA DRIVE
DALLAS, TX 75220

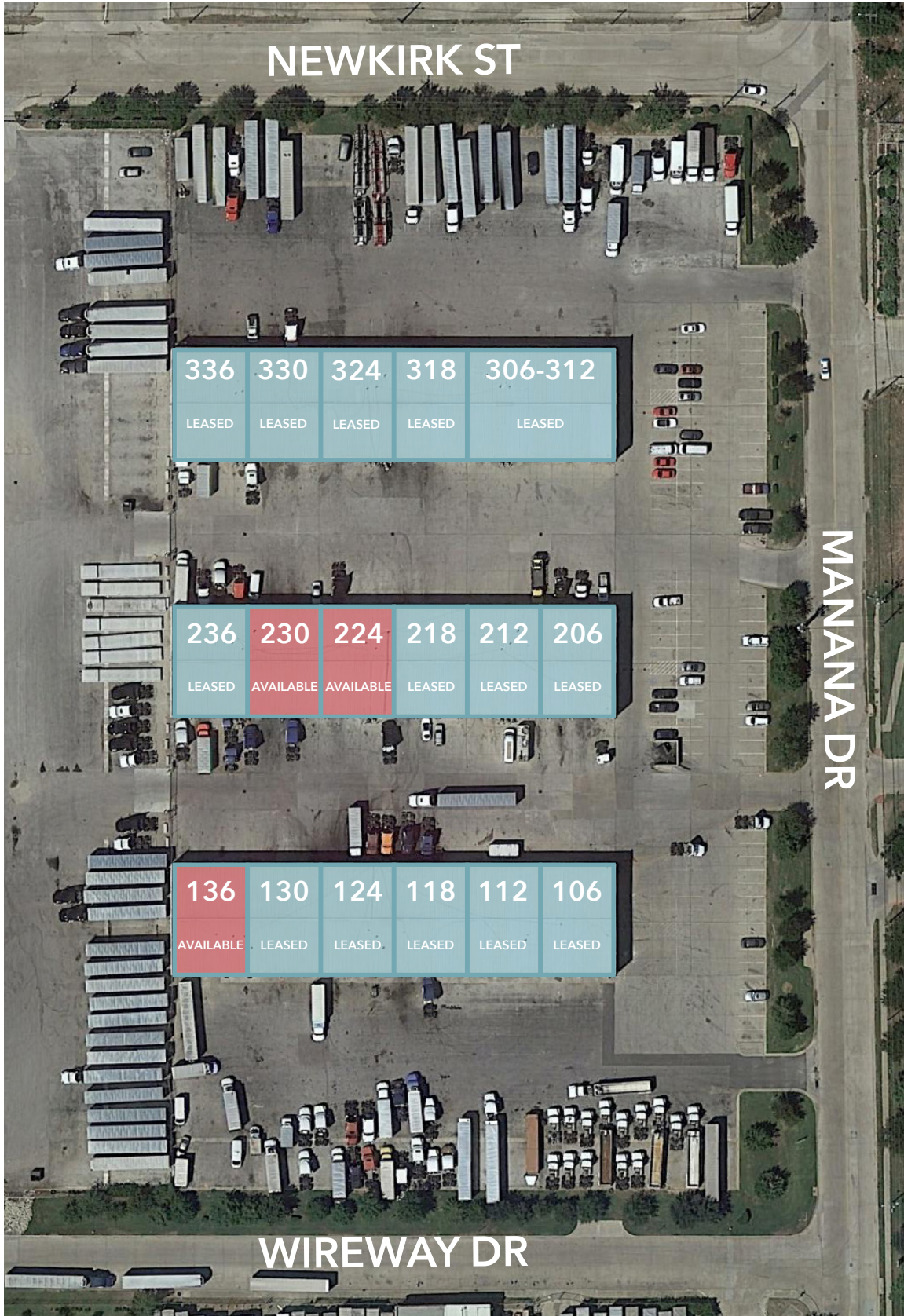

GIOVANNI SCARDINO
214.210.6607
giovanni.scardino@streamrealty.com

WILLIAM FAULHABER
214.560.5189
william.faulhaber@streamrealty.com



SUITE 136

3,375 SF

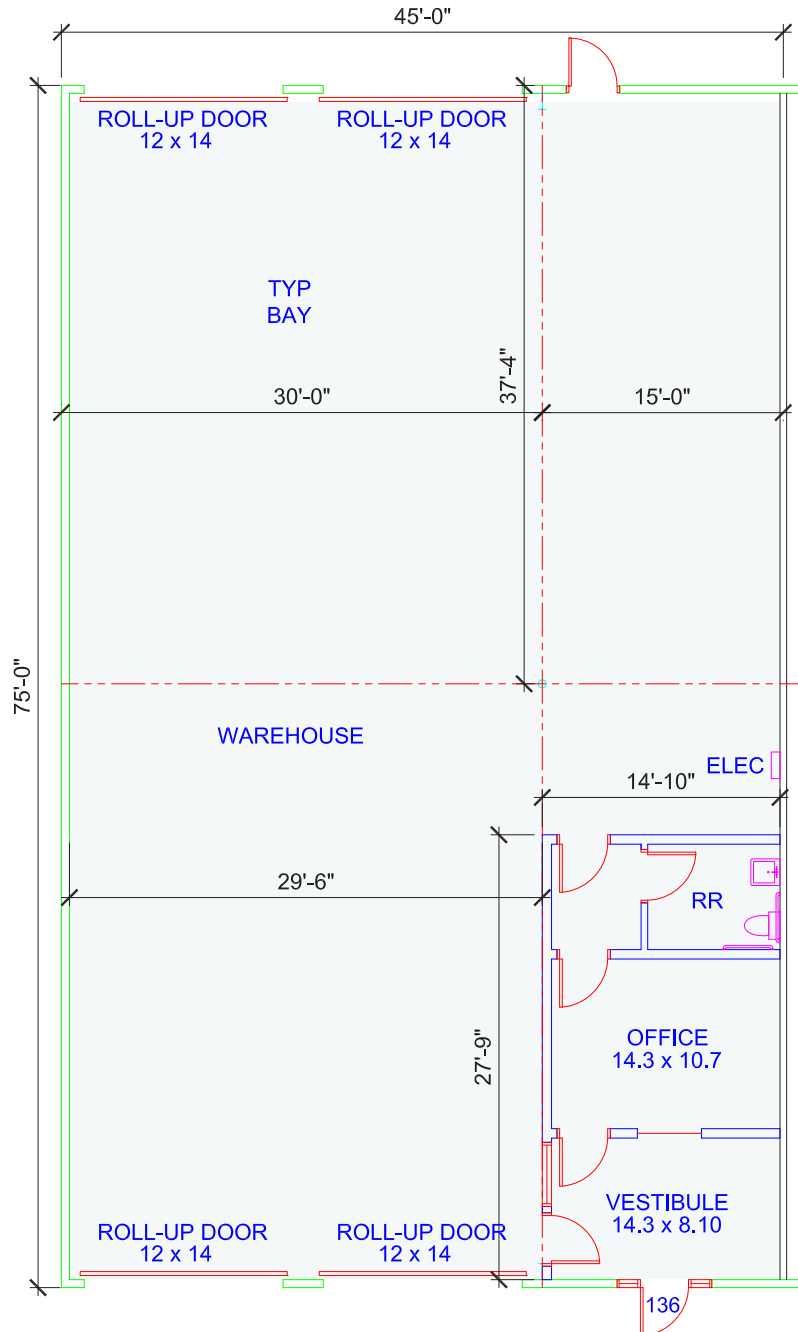

SUITE 224

3,375 SF

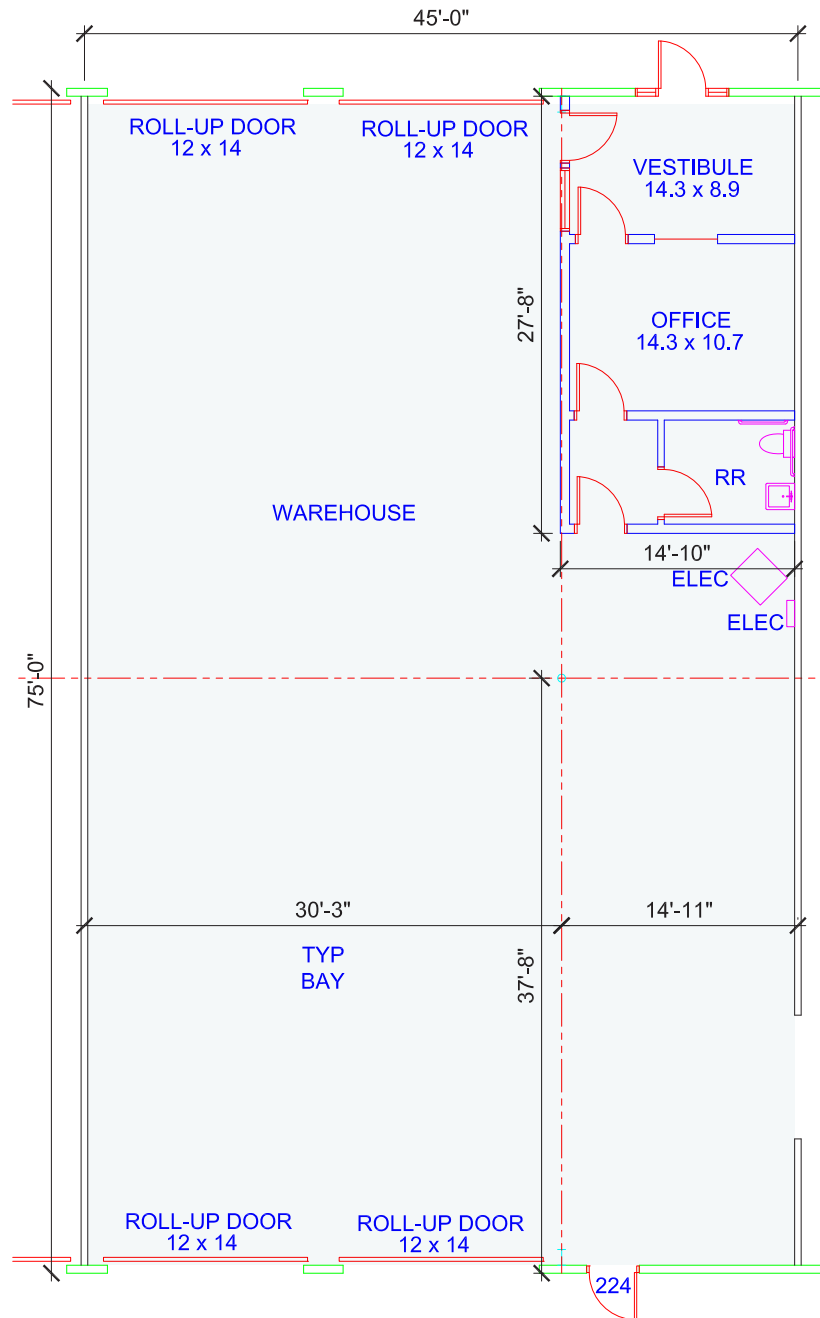

SUITE 230

3,375 SF

