

PLUG AND PLAY SUBLEASE OPPORTUNITY

**8801 LEAD MINE RD,
SUITE 117**
Raleigh, NC 27615

SUMMARY

**ASKING RATE
NEGOTIABLE**

**TERM
THRU
11/30/2028**

**AVAILABLE SPACE:
1,800 SF**

SUITE FEATURES

- Furniture included
- 1 huddle room
- 2 restrooms
- Kitchenette
- Vestibule
- Open and collaborative layout

PROPERTY FEATURES

- Robust co-tenant mix
- Signalized intersection
- 126 surface parking spaces

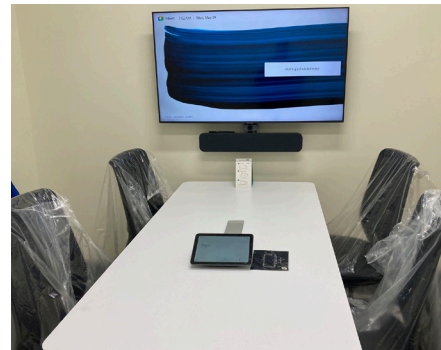
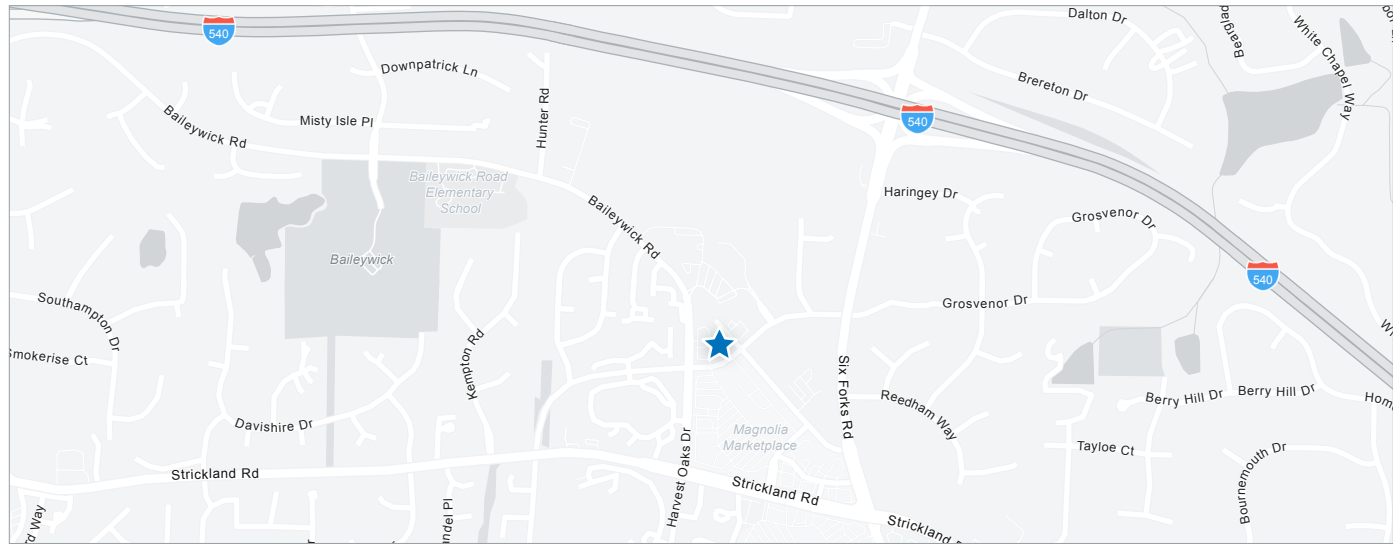

CONTACT INFORMATION

THOMAS SAVAGE
Managing Director
404.842.6594
thomas.savage@transwestern.com

The information provided herein was obtained from sources believed reliable; however, Transwestern makes no guarantees, warranties or representations as to the completeness of accuracy thereof. The presentation of this property is submitted subject to errors, omissions, change of price or conditions, prior to sale or lease, or withdrawal without notice. Copyright © 2025 Transwestern.

8801 LEAD MINE RD, SUITE 117

Raleigh, NC 27615

FLOOR PLAN

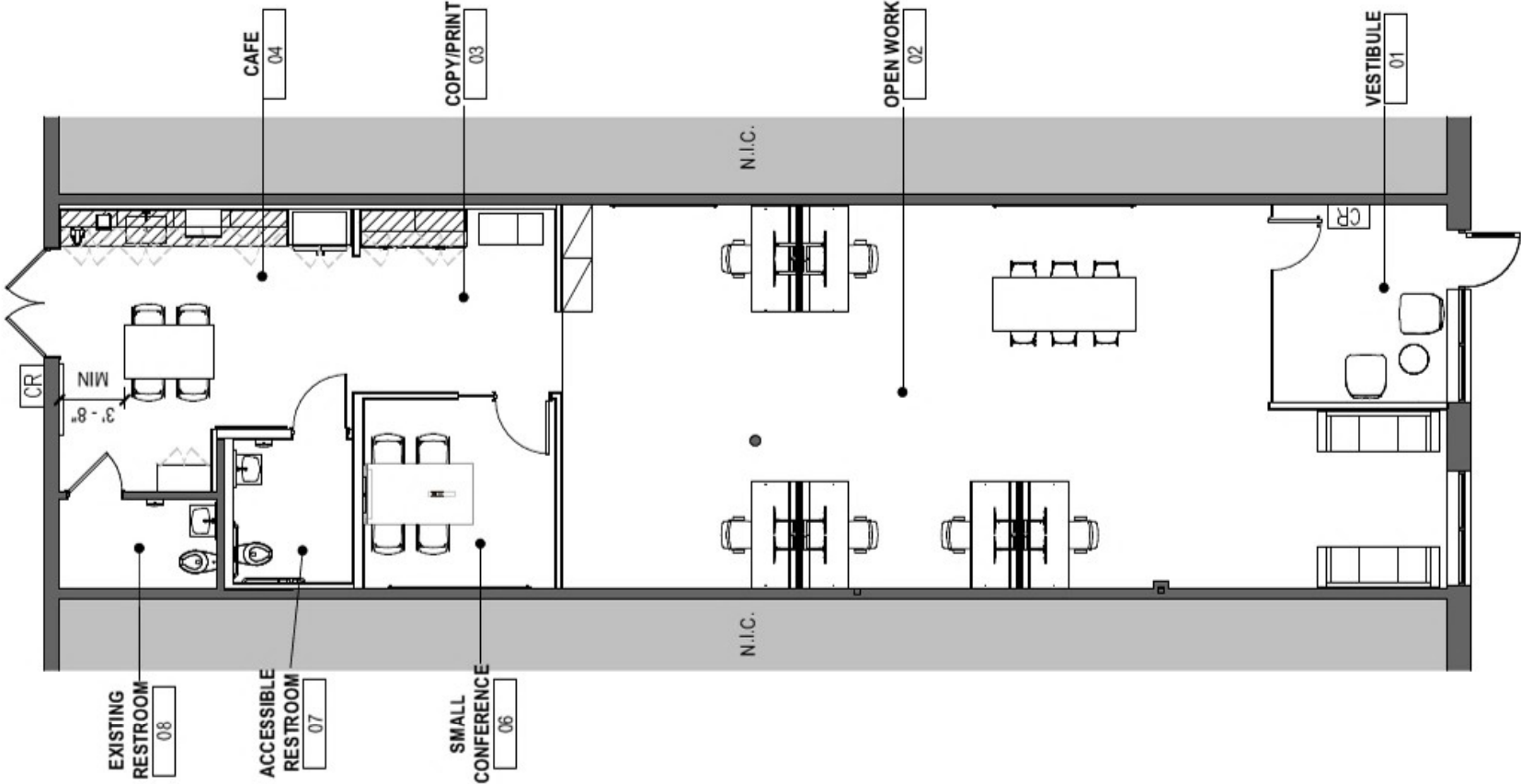

CONTACT INFORMATION

THOMAS SAVAGE
Managing Director
404.842.6594
thomas.savage@transwestern.com

The information provided herein was obtained from sources believed reliable; however, Transwestern makes no guarantees, warranties or representations as to the completeness of accuracy thereof. The presentation of this property is submitted subject to errors, omissions, change of price or conditions, prior to sale or lease, or withdrawal without notice. Copyright © 2025 Transwestern.