

CLEMATIS ST

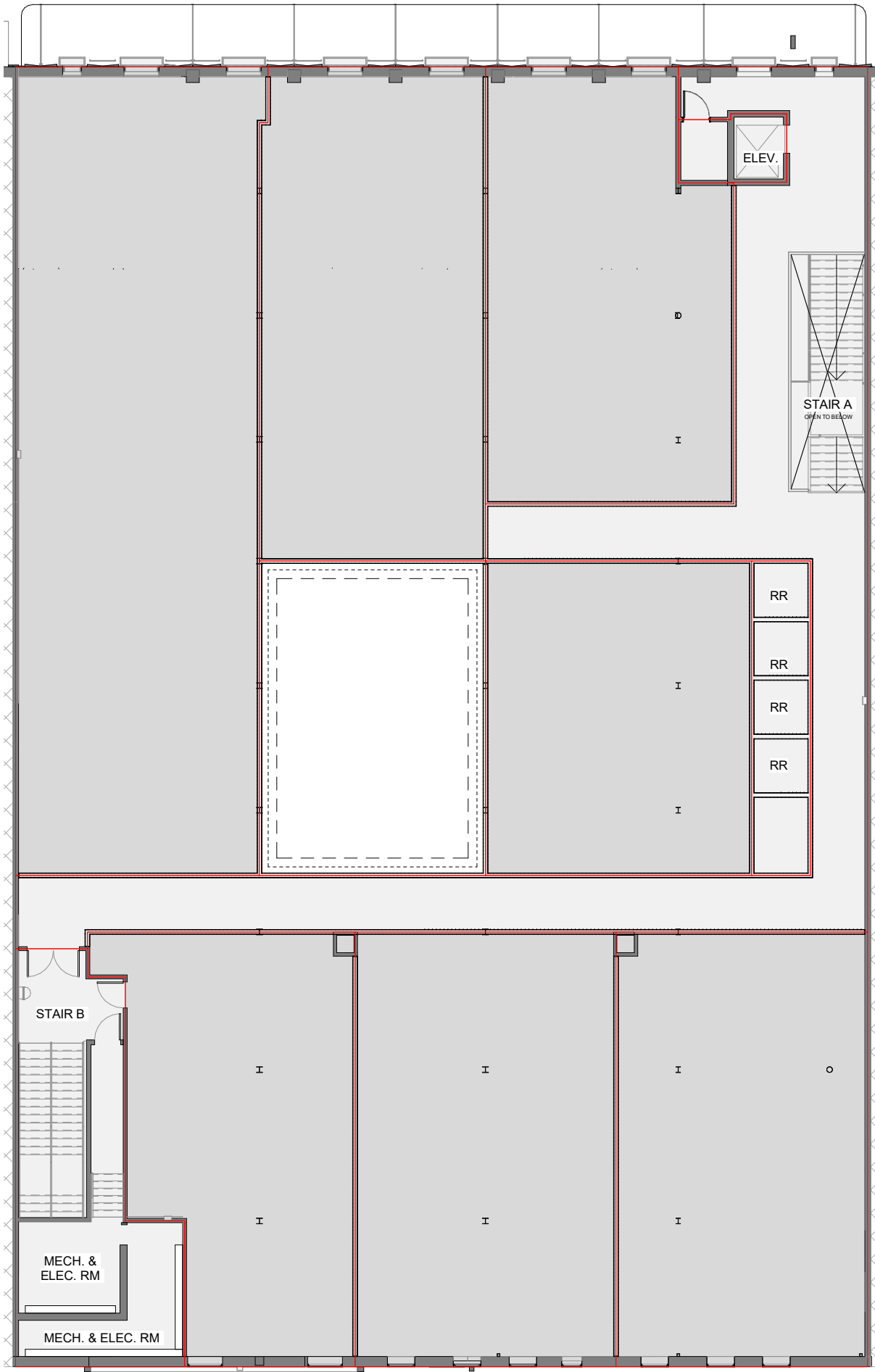

14' ALLEYWAY

**CEILING HEIGHTS:**  
HIGH POINT:  
B.O. STRUCT.- 12'-0"  
B.O. OF DECK- 14'-0"

NOTE: DRAWING SHOWN ABOVE REFLECTS THE LATEST AS-BUILT CONDITIONS. RECIPIENT OF THIS FILE IS RESPONSIBLE FOR FIELD-VERIFYING THE EXISTING CONDITIONS. ALL DIMENSIONS ARE APPROXIMATE. LOCATIONS OF UTILITIES, STRUCTURE, STAIRS, WALLS TO BE FIELD VEIRIFED BY TENANT. LIFE-SAFETY TO BE VERIFIED BY TENANT ARCHITECT.



CLEMATIS ST

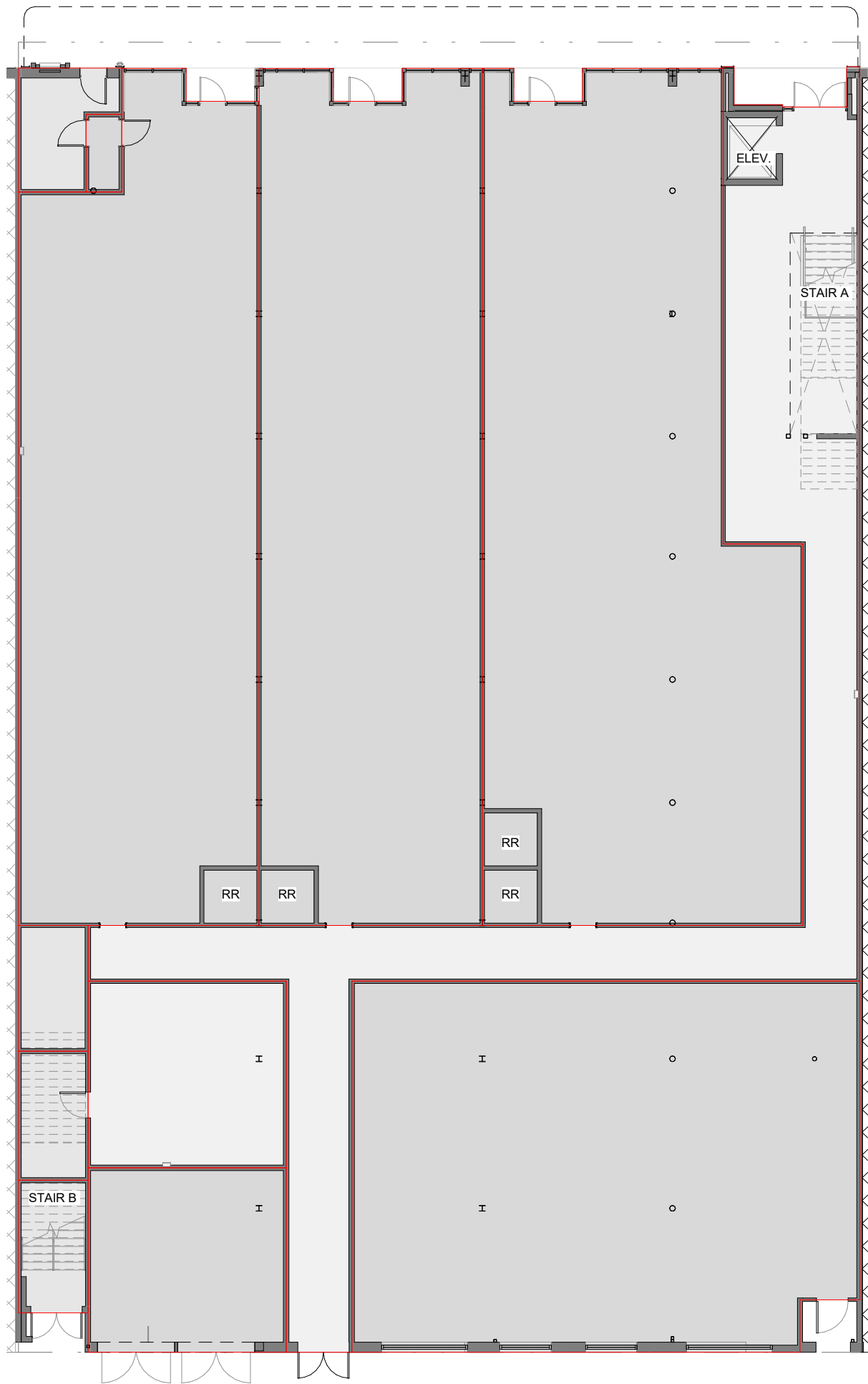

14' ALLEYWAY

NOTE: DRAWING SHOWN ABOVE REFLECTS THE LATEST AS-BUILT CONDITIONS. RECIPIENT OF THIS FILE IS RESPONSIBLE FOR FIELD-VERIFYING THE EXISTING CONDITIONS. ALL DIMENSIONS ARE APPROXIMATE. LOCATIONS OF UTILITIES, STRUCTURE, STAIRS, WALLS TO BE FIELD VEIRIFIED BY TENANT. LIFE-SAFETY TO BE VERIFIED BY TENANT ARCHITECT.

**CEILING HEIGHTS:**  
B.O. STRUCT.- 13'-11"  
B.O. OF DECK- 15'-5"

