



*Full frontage extensions shall be assumed as a project requirement per section 2.2.2 of the Design and Construction Standards for Wastewater Collection Systems for Southern Nevada, latest edition, unless otherwise indicated.*



October 28, 2025

RE: POINT OF CONNECTION REQUEST: MULTI-FAMILY RESIDENTIAL (304 UNITS)  
POC TRACKING NUMBER: (0220-2026)  
EXPIRATION DATE: 10/28/2026

The District's Development Services team reviewed the above request to identify a potential Point of Connection (POC) to the District's sanitary sewer system. As of the date of this letter, we've located a POC and determined there is capacity for the projected flows for the proposed Project, not to exceed 0.0532 MGD (213 ERU). Please note that this letter does not in any way suggest available capacity for the Project beyond the Project's current reported projected flows.

It is very important to note the identified POC location is not a guarantee or reservation of sanitary sewer system capacity for the above-referenced Project. Capacity in the sanitary sewer system is obtained for a project on a first come-first served basis and only after the payment of the applicable connection fee and meeting the conditions stated in Subsections 1.2.1 and 1.5.4 of the District's Service Rules. This applies to tenant improvements as well. The amount of the applicable connection fee will be determined when a System Development Approval is issued for the Project. Any capacity available to the Project as of the date of this POC will become unavailable to the Project if: 1) that capacity is obtained first by another project; or 2) upon expiration of this POC. In accordance with Section 1.1.20 of the District's Service Rules, if the Project should need additional capacity in the future beyond the current projected flows, and no such capacity exists, the developer must, at their expense, make improvements to the District's sanitary sewer system to create the capacity needed to serve the Project.

This POC is conditioned on the following: 8-INCH SS FRONTAGE REQUIRED IN WEST BOULDER LANE.

Please refer to the External POC Checklist / Summary and the POC Exhibit and include the POC Tracking Number with your initial plan review submittal.

Please contact our Development Services team with any questions. We can be reached at (702) 668-8160 and the email address: sewerlocation@cleanwaterteam.com.

Sincerely,

Leslie Long, P.E.  
Manager, Development Services

cc: File

Enclosures: External Point of Connection (POC) Checklist / Summary  
POC Exhibit (0220-2026)

BOARD OF TRUSTEES  
Tick Segerblom, *Chair* • Justin Jones, *Vice Chair*  
April Becker • James B. Gibson • Marilyn Kirkpatrick • William McCurdy II • Michael Naft  
Thomas A. Minwegen, *General Manager*

5857 East Flamingo Road • Las Vegas, Nevada 89122 • (702) 668-8888 • (800) 782-4324  
cleanwaterteam.com

**Development & Planning Services  
External Point of Connection (POC) Checklist / Summary**

POC Tracking Number	0220-2026
Engineer/Requester	Baughman & Turner, Inc.
Developer/Client	Indian Springs Investments LLC
Project Name/Description	Multi-Family Residential (304 Units)
APN(S)	059-08-701-059
Proposed Flow (As Provided by Engineer/Requester)	Q avg = 0.0532 MGD, 213 ERU
Zoning Request	<input type="radio"/> Yes <input checked="" type="radio"/> No

**Capacity Results**

POC Available	<input checked="" type="radio"/> Yes <input type="radio"/> Other (see Developer Notes)	<input type="radio"/> No
Proposed Point(s) of Connection	C47!	
Developer Notes	8-inch SS frontage required in West Boulder Lane.	

Performed By	 <b>Dominic Tucci</b>	Date	10/28/2025
--------------	-------------------------------------------------------------------------------------------------------------	------	------------

Note: The POC Checklist/Summary and POC Exhibit are valid for one (1) year after issue date (issue date being date shown on POC Approval Letter). POC tracking number MUST be submitted along with civil plans; otherwise they will be returned without review. All POC information provided herein is specific to the referenced project. For POCs processed during zoning: The information is for reference only. A new POC must be requested via the PIPES portal by the Engineer of Record (or their engineering firm) prior to the submittal of civil improvement plans for the zoning item.

C:\Documents and Settings\Deyan\Local Settings\Temp\BGPPlot\_1176\BGP\_Plan\_and\_Profiles.dwg - 23 - Feb 20, 2007 - 9:54am

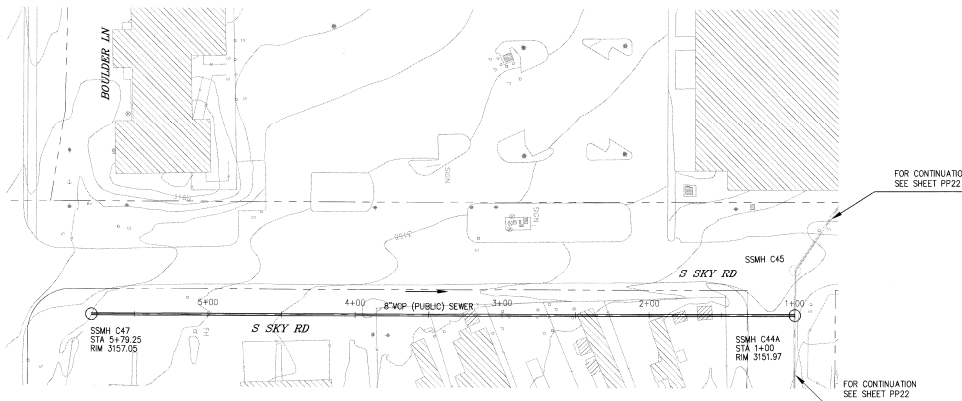

**SOUTH SKY ROAD (PUBLIC)**

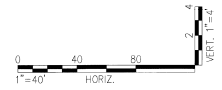
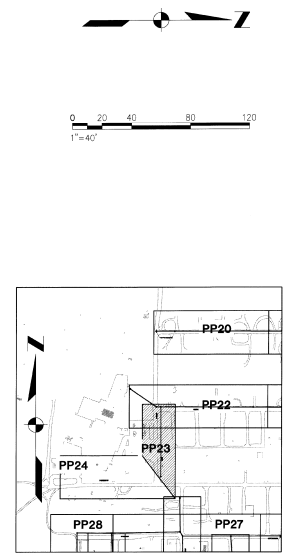
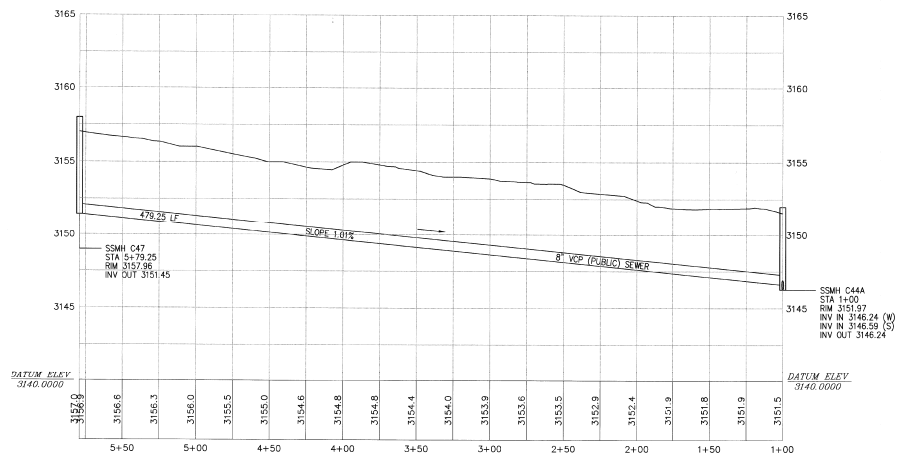

**RECORD DRAWINGS**

				<p>DESIGNED: DSI</p> <p>DRAWN: DSI</p> <p>CHECKED: REB</p>		<p>INDIAN SPRINGS CLARK COUNTY WATER RECLAMATION DISTRICT COLLECTION SYSTEM PROJECT #561-A</p> <p>Kennedy/Jenks Consultants 840 GREY DRIVE, SUITE 300, LAS VEGAS, NEVADA 89119 (702)770-3613</p>		<p>SOUTH SKY ROAD (PUBLIC) PLAN AND PROFILE STA 1+00 TO 5+79.25</p>		<p>FILE NAME: PLAN AND PROFILES</p> <p>JOB NO: 0594202.00</p> <p>DATE: FEB 20, 2006</p> <p>SHEET: PP23 OF 70</p>	
<p>NO. REVISION DATE BY</p>				<p>SCALES 1" = 40' 1" = 25mm</p> <p>IF THIS BAR IS NOT DIMENSION SHOWN, ADJUST SCALES ACCORDINGLY.</p>							