

**NORTHWOOD VILLAGE**  
1926 Highway 15 N., Laurel, MS



**AVAILABLE 11,000 SQ. FT  
JUNIOR ANCHOR END CAP**

ANCHORED BY:  
NATIONAL RETAILER TO BE  
ANNOUNCED/AARON RENTS/ CITI  
TRENDS/DOLLAR GENERAL/HARBOR  
FREIGHT TOOLS

**ACROSS THE STREET FROM SUPER WAL-MART**  
DEMOGRAPHICS:

	1 Mile	3 Miles	5 Miles
Total Daytime Population	5,443	29,532	43,073



**CAMPBELL**  
**REAL ESTATE, INC.**

For detailed information contact:  
Colin Campbell, Jr., CSM  
President/Broker  
813-661-0500  
813-661-0504 fax  
[campre@verizon.net](mailto:campre@verizon.net)  
[www.shoppingcentermgmt.com](http://www.shoppingcentermgmt.com)

# NORTHWOOD VILLAGE

## 1926 Highway 15 N., Laurel, MS

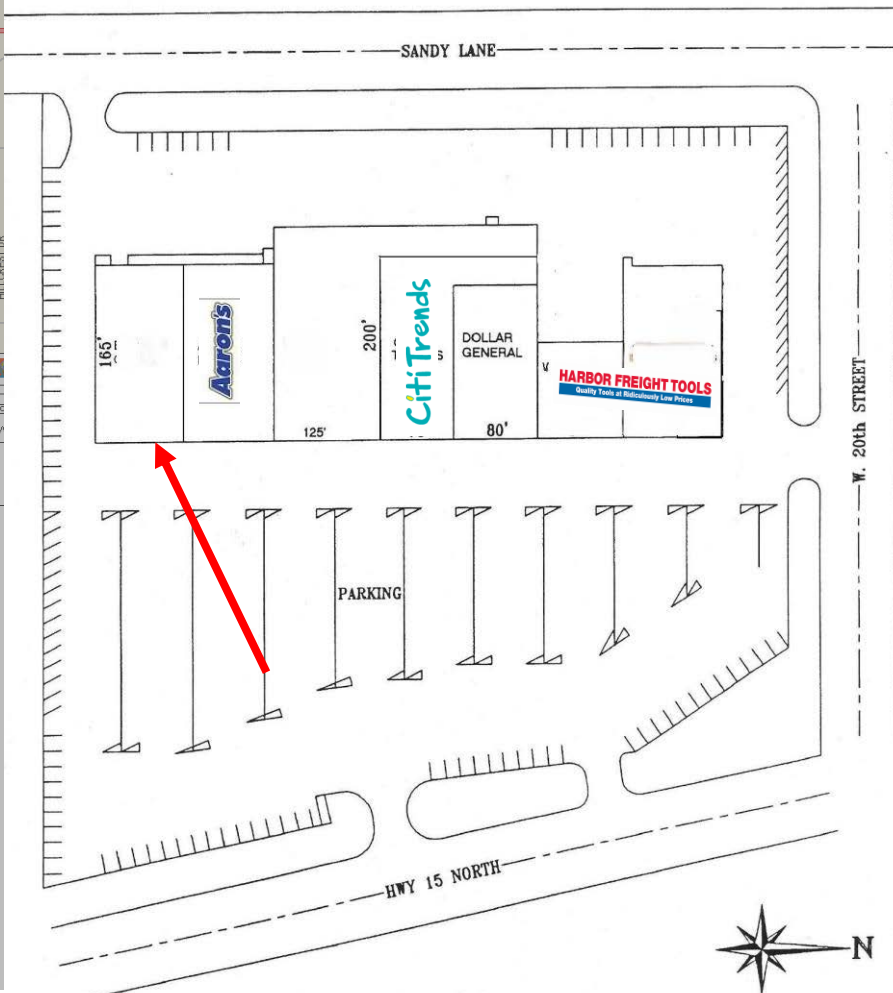

DELORME  
 Data use subject to license.  
 © 2004 DeLorme. Street Atlas USA® 2005.  
 www.delorme.com

