

Ocean Terminal Flex Building

Industrial Zoning | Heavy 3 Phase Power | Climate Controlled | Minutes to Downtown

AVAILABLE FOR
LEASE

±1,265 – 5,225 SF



151 E Lathrop Ave
Savannah, GA 31415

Zachary Zakas
Partner | Co-Founder
Elmwood & Company
912.417.0009
zachary.zakas@elmwood.co

Andrew Balch
Associate
Elmwood & Company
704.996.7924
andrew.balch@elmwood.co

Rick Ali
Owner Contact
912.441.3184
allpagecom@aol.com

**Elmwood
& Company**

PROPERTY DETAILS

ADDRESS	151 E Lathrop Ave
CITY, STATE, ZIP CODE	Savannah, GA 31415
PARCEL ID	20020 10012
COUNTY	Chatham
LEASE TYPE	NNN

ZONING	I-L Light Industrial Transition
AVAILABILITY	Immediate
TOTAL BUILDING SIZE	±5,225 SF
FIRST FLOOR	±3,960 SF
SECOND FLOOR	±1,265 SF

LOT SIZE	±1.15 AC
BUILDING HEIGHT	18'
OVERHEAD DOOR	1 (8' X 10')
PROPERTY USE	Flex / Industrial
POWER	Heavy 3 Phase Power

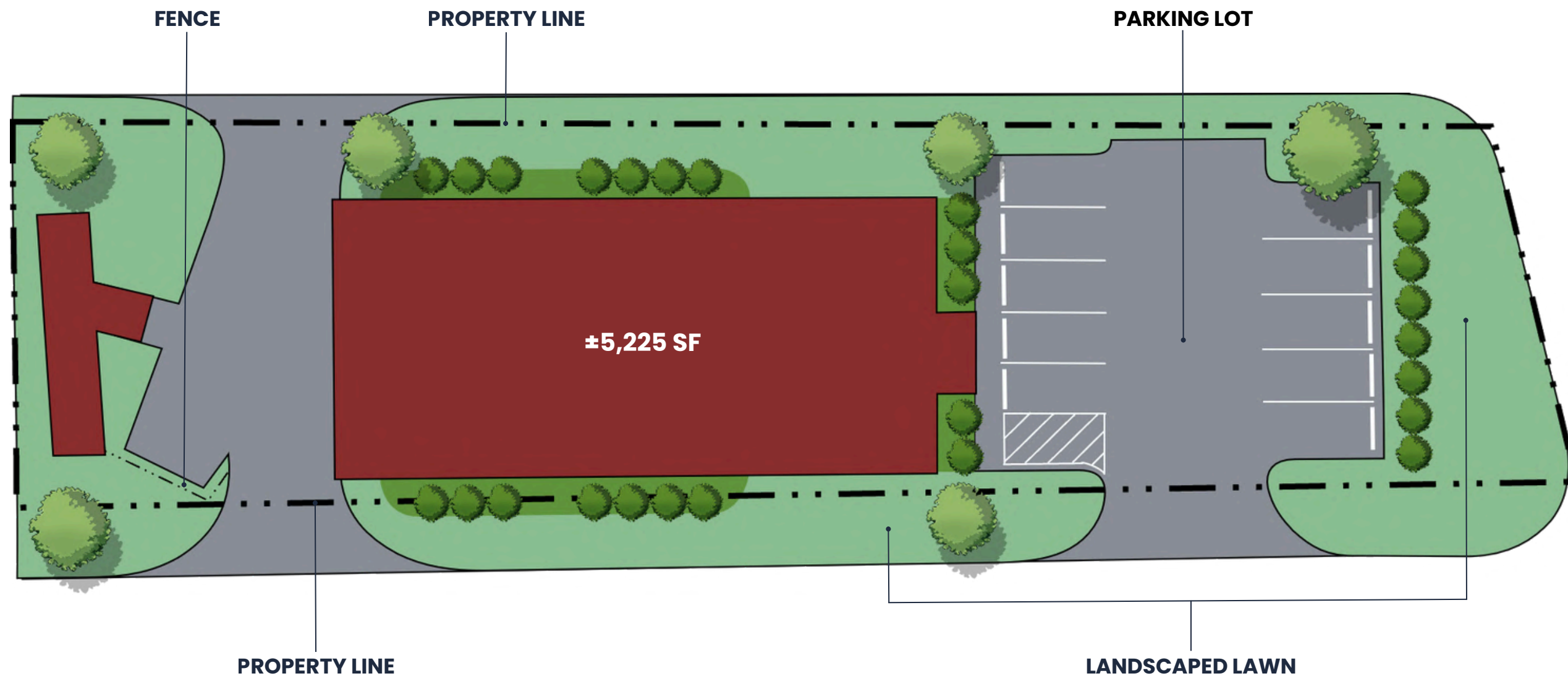

LEGEND:

-  - AVAILABLE FOR LEASE
-  - PROPERTY LINE

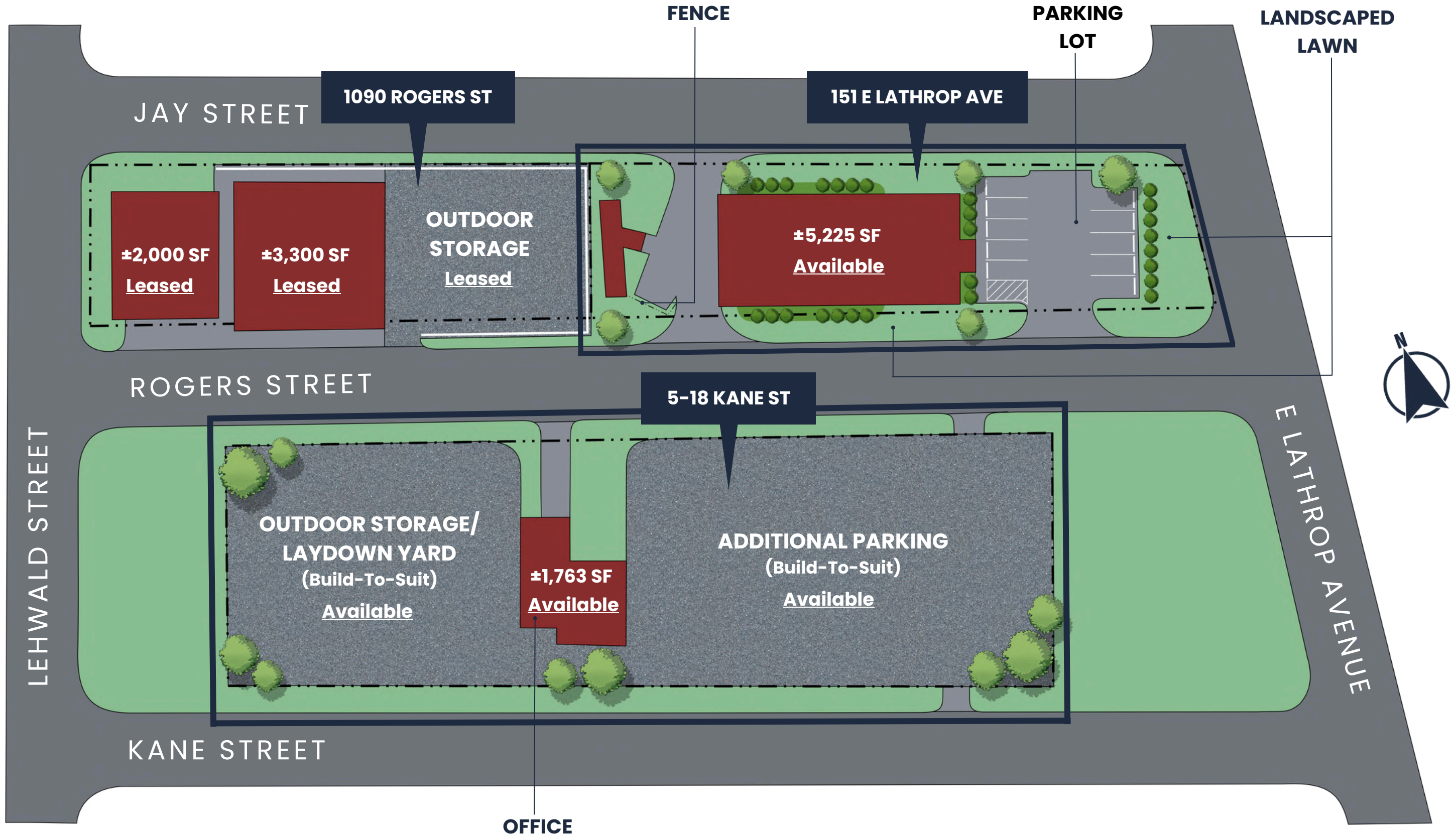

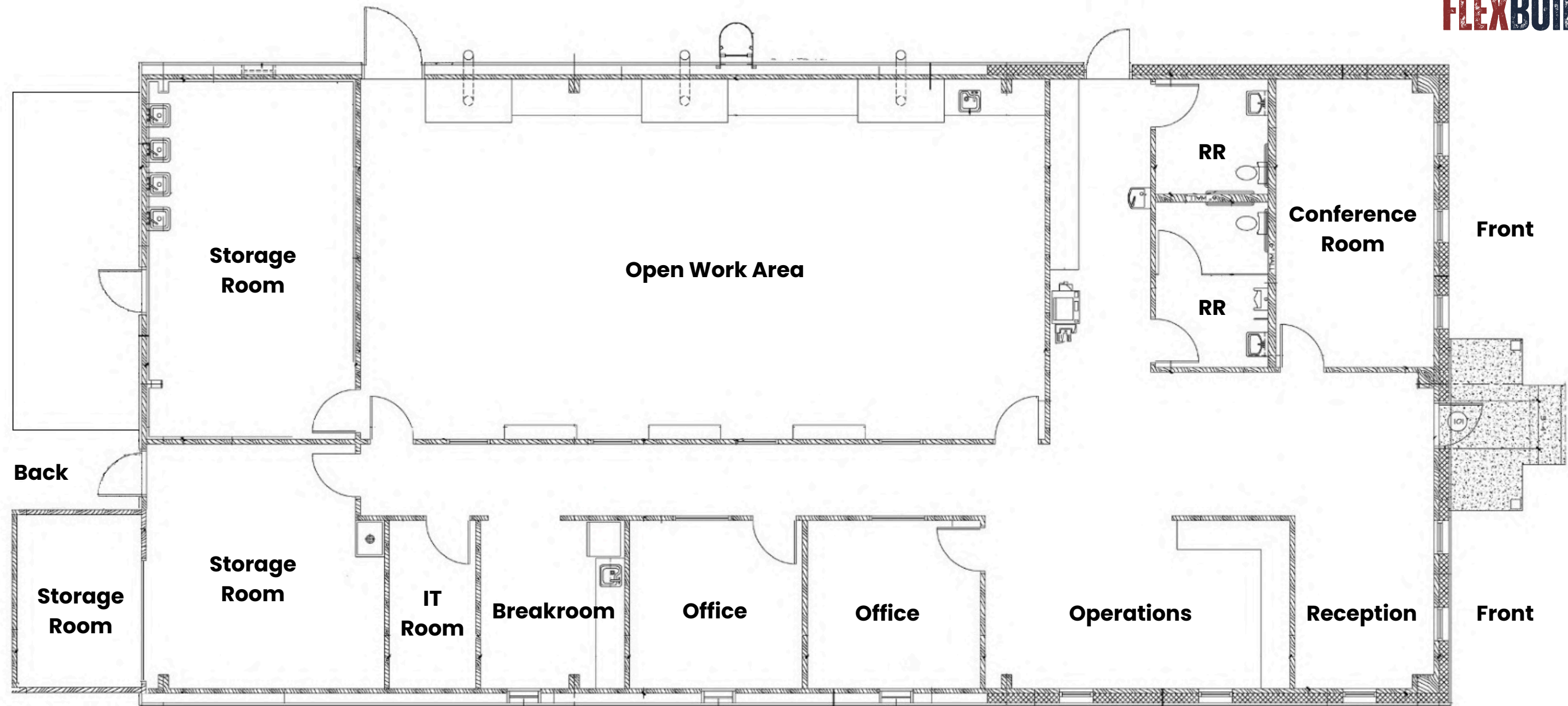

FIRST FLOOR

FLOOR SIZE ±3,960 SF

AVAILABILITY Immediate

FEATURES

- Two Offices
- Two Restrooms
- Open Work Area
- Conference Room
- Breakroom
- Reception

SECOND FLOOR

FLOOR SIZE ±1,265 SF

AVAILABILITY Immediate

FEATURES

Proposed Layout/
Cold Shell Condition

- Three Offices
- Open Work Area
- Breakroom
- Restroom

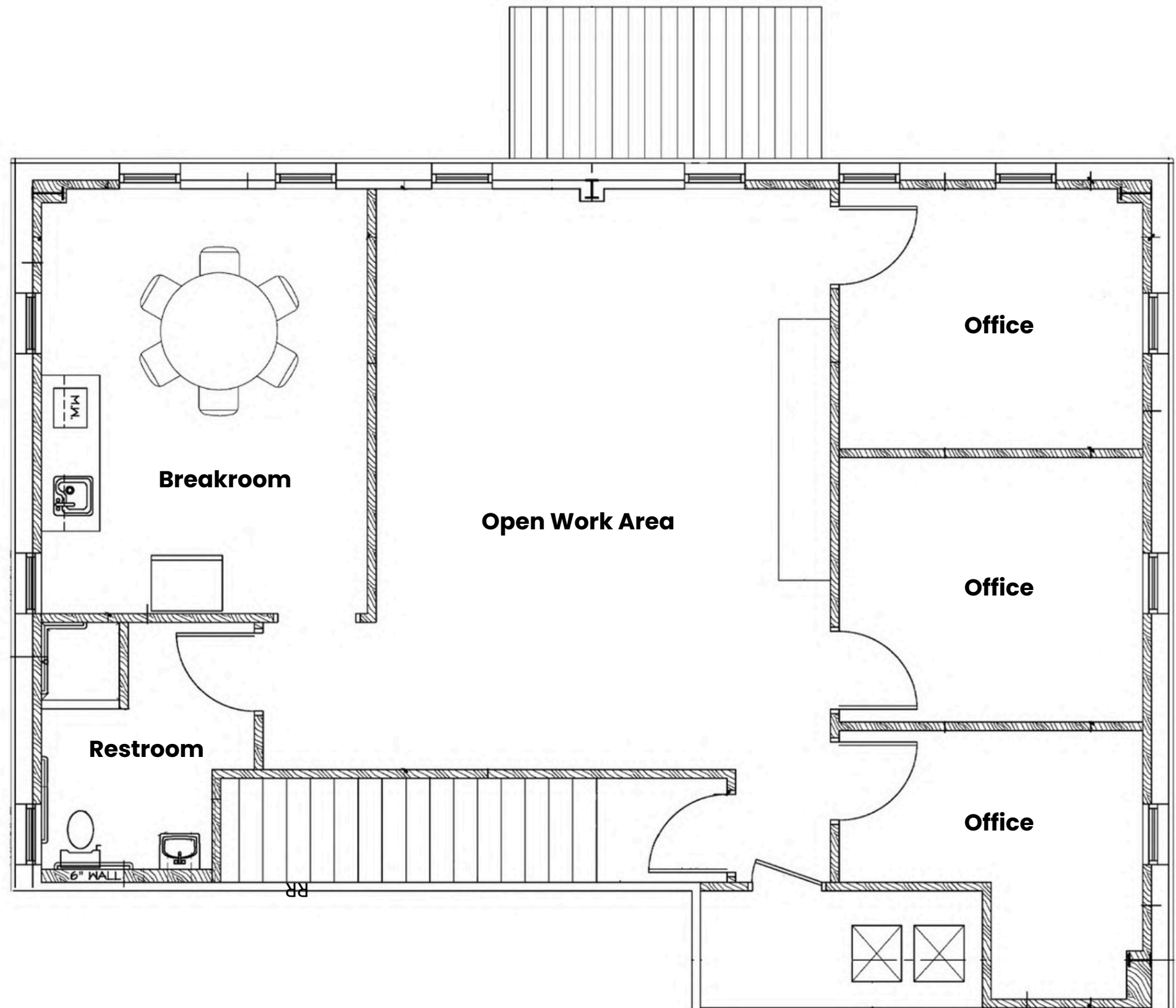

PROPERTY PHOTOS









LOCATION OVERVIEW



AERIAL MAP

Key Distances

 Ocean Terminal	1.0 Miles
 Garden City Terminal	3.1 Miles
 Savannah Downtown	1.0 Miles
 Savannah/HH Airport	9.0 Miles
 Interstate 516	1.4 Miles
 Interstate 16	1.6 Miles
 Interstate 95	8.5 Miles



151 E Lathrop Ave
Savannah, GA 31415

OCEAN TERMINAL
FLEXBUILDING

CONTACT

Zachary Zakas

Partner | Co-Founder
Elmwood & Company
912.417.0009
zachary.zakas@elmwood.co

Andrew Balch

Associate
Elmwood & Company
704.996.7924
andrew.balch@elmwood.co

Rick Ali

Owner Contact
912.441.3184
allpagecom@aol.com

Savannah:

2100 Bull Street
Savannah, GA 31401

Atlanta:

1447 Peachtree St NE
Atlanta, GA 30309

Los Angeles:

9460 Wilshire Blvd.
Beverly Hills, CA 90212

Confidentiality & Disclaimer: This marketing flyer has been prepared by Elmwood & Company LLC for informational purposes only and does not constitute an offer to lease or a solicitation to lease the property described herein (the "Property"). The information contained herein has been obtained from sources believed to be reliable; however, Elmwood & Company LLC, its affiliates, and their respective agents, employees, and representatives make no representation or warranty, express or implied, as to the accuracy or completeness of the information contained herein, and nothing contained herein shall be relied upon as a promise or representation of fact. All property information, including but not limited to property descriptions, site plans, dimensions, renderings, photographs, zoning references, financial information, and availability, is provided for illustrative purposes only and is subject to errors, omissions, changes in price or terms, prior lease or withdrawal without notice. Any projections, opinions, assumptions, or estimates contained herein are provided for example only and may not represent current or future performance of the Property. Prospective tenants and other interested parties are encouraged to conduct their own independent investigations and due diligence regarding the Property, including but not limited to verification of all physical, financial, legal, and zoning information. Elmwood & Company LLC expressly disclaims any and all liability for any loss or damage arising from reliance upon the information contained herein.

**Elmwood
& Company**