



24,345 SF AVAILABLE

2020 - 2022 Weems Road
Bldg. B, Suite 2020 - 2022
Tucker, GA 30084

OWNED BY:



FOR LEASE



PROPERTY INFORMATION

- Total Size:** 24,345 SF
- Office:** 5,280 SF
- Warehouse:** 19,074 SF
- Loading:** Six (6) Dock High Doors
- Clear Height:** 20'
- Available:** Immediately

- Features:** Equipped with Overhead Crane and Recessed Dock

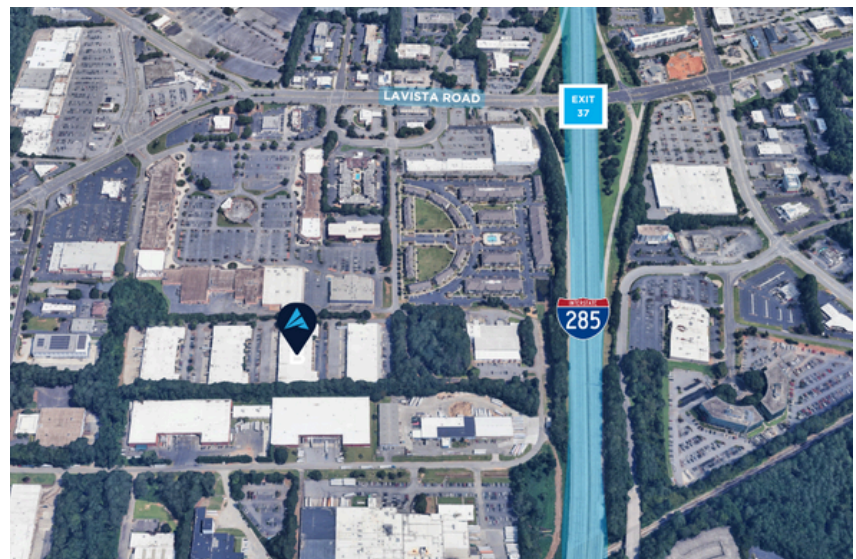

For more information, please contact:

CLARK OWEN

Office: (404) 595-1553
Cell: (706) 474-3727
cowen@apexindustrialre.com

MORGAN MCMENAMY

Office: (404) 806-6631
Cell: (404) 771-1199
mmcmenamy@apexindustrialre.com



Although the information contained therein was provided from sources believed to be reliable, Apex Industrial makes no representation, expressed or implied, as to its accuracy and said information is subject to errors, omissions or changes.



24,345 SF AVAILABLE

2020 - 2022 Weems Road
Bldg. B, Suite 2020 - 2022
Tucker, GA 30084

OWNED BY:



FLOOR PLAN

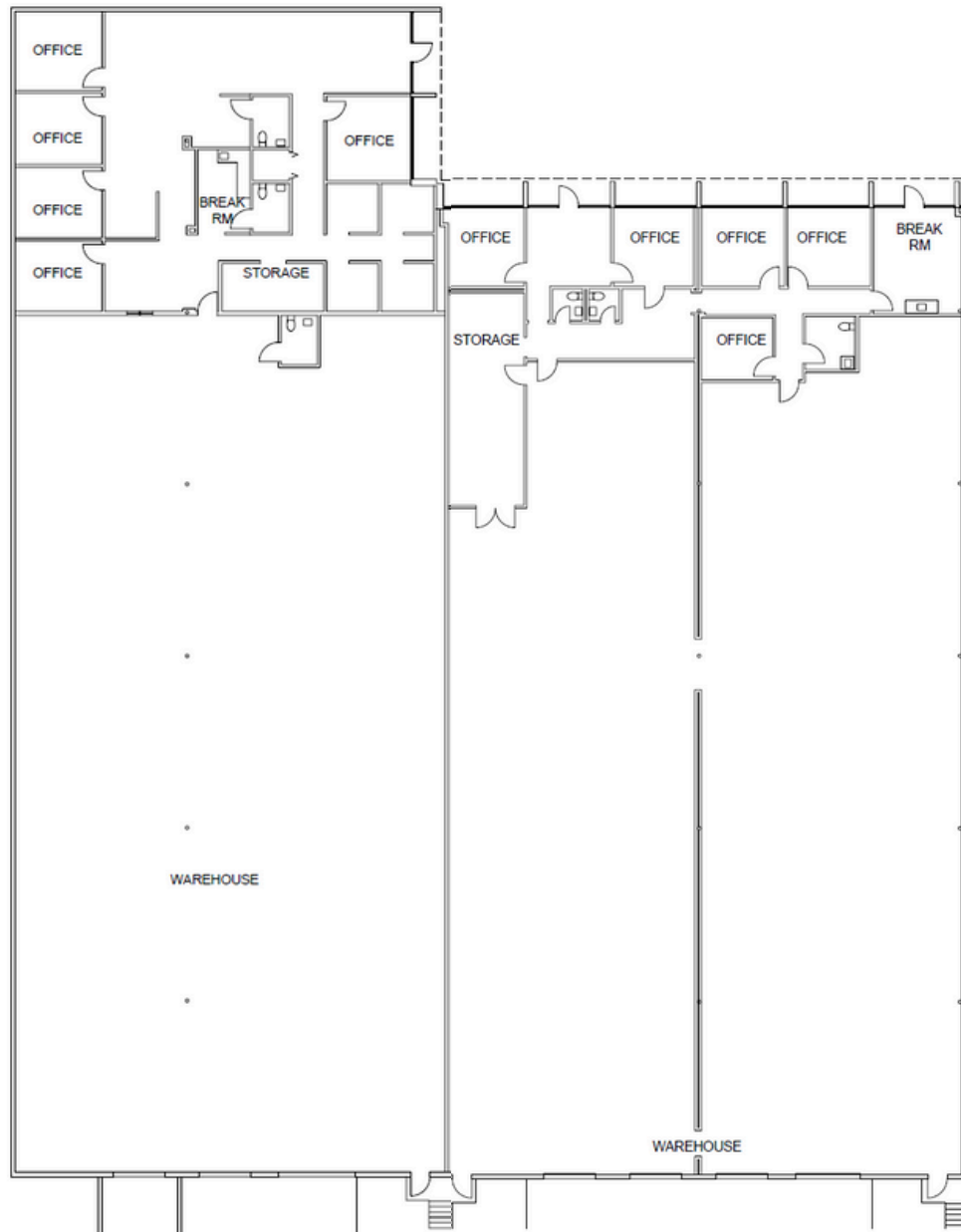

For more information, please contact:

CLARK OWEN

Office: (404) 595-1553
Cell: (706) 474-3727
cowen@apexindustrialre.com

MORGAN MCMENAMY

Office: (404) 806-6631
Cell: (404) 771-1199
mmcmenamy@apexindustrialre.com



Although the information contained therein was provided from sources believed to be reliable, Apex Industrial makes no representation, expressed or implied, as to its accuracy and said information is subject to errors, omissions or changes.