



Land & Development in HD1

Mark Street, Paddock, Huddersfield, West Yorkshire, HD1 4ST

£145,000 Starting Bid

Tenure

Leasehold

Driveway parking

Property features

- ✓ Large forecourt
- ✓ Enclosed area previously used for bodyshop work
- ✓ Leasehold property on 2 titles - see legal pack
- ✓ Conditional Outline PP granted to build 3 townhouses
- ✓ Commercial garage site

Arrange a viewing

Lisa Neil
Branch Manager
Commercial National

0191 737 1154
commercial@pattinson.co.uk

- ✓ Flexible viewing slots
- ✓ Accompanied viewings

Description

Being sold via Secure Sale online bidding. Terms & Conditions apply.

This property will be legally prepared enabling any interested buyer to secure the property immediately once their bid/offer has been accepted. Ultimately a transparent process which provides speed, security and certainty for all parties.

A commercial property located in Paddock, and area which is accessible to the A62 Manchester/Huddersfield Road, approximately 2 miles from Huddersfield Centre.

A large garage building previously used for car repairs and bodyshop works.

The property has a large enclosed forecourt at the front with high fencing.

Conditional Outline Planning Permission has been granted to build 3 townhouses.

To view the application visit the Kirklees Planning portal and search for the application number 2025/60/92223/W

This is a leasehold property on two titles within the boundary - around 900 years left on each lease and each ground rent being approximately £6.00 per annum.

Please refer to the legal pack for full details. Buyers are advised to speak with Kirklees Legal Department should they wish to pursue purchasing the Freehold to enable the development of the town houses.

VIEWINGS VIA OUR HONLEY OFFICE - MONDAY TO FRIDAY DURING WORKING HOURS ONLY

Mains electricity and water on site.

Price: Starting Bid £145,000

Property Type: Land & Development

Business Type: Garage

Parking: Driveway

Description

A large garage building previously used for car repairs and bodyshop works.

Location

located in Paddock, and area which is accessible to the A62 Manchester/Huddersfield Road, approximately 2 miles from Huddersfield Centre.

Tenure

Leasehold - Titles; WYK700865 + WYK454921

EPC

This property's energy rating is G.

Additional Information

For further information please contact our office directly on 0191 737 1154, or alternatively via email on commercial@pattinson.co.uk. With regards to viewing subject property, this is to be done strictly by appointment.

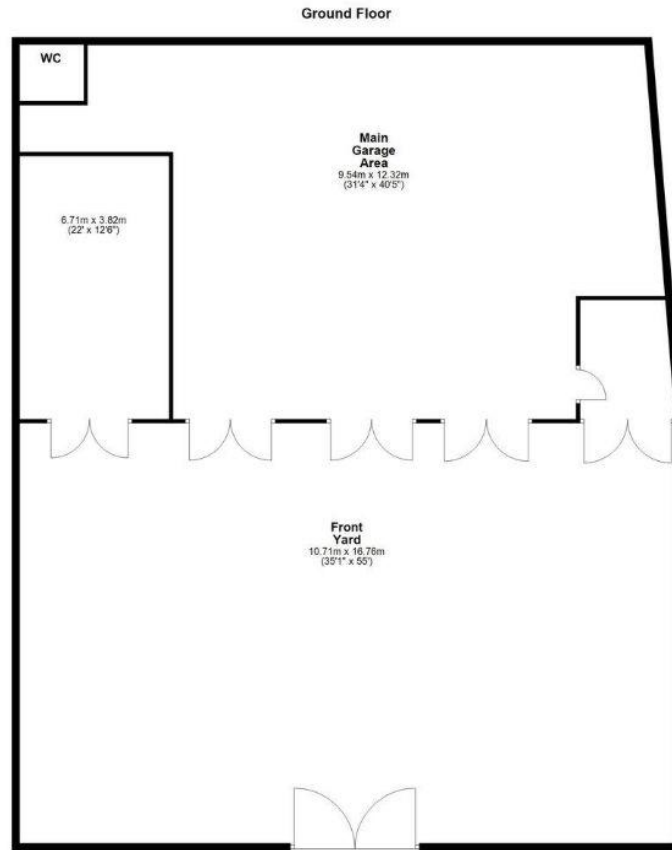

Mark Street, Paddock, Huddersfield, West Yorkshire, HD1 4ST

Contact your local branch today for more information on this property:

**Keith Pattinson Silverlink, Wallsend, Tyne and Wear, NE28 9NY, Tel: 0191 737 1154 ,
commercial@pattinson.co.uk, www.pattinson.co.uk**

These particulars, whilst believed to be accurate are set out as a general outline only for guidance and do not constitute any part of an offer or contract. Intending purchasers should not rely on them as statements of representation of fact, but must satisfy themselves by inspection or otherwise as to their accuracy. No person in this firm's employment has the authority to make or give any representation or warranty in respect of the property.

