

LANGSTON BLACK

REAL ESTATE, INC.

FLEX BUILDING FOR LEASE

JUST OFF VERNE SMITH PARKWAY (HWY 80)

1788 POPLAR DRIVE EXT., GREER

7,543+- SF FLEX BUILDING



1 DRIVE-IN DOOR AND 2 DOCK HIGH DOORS

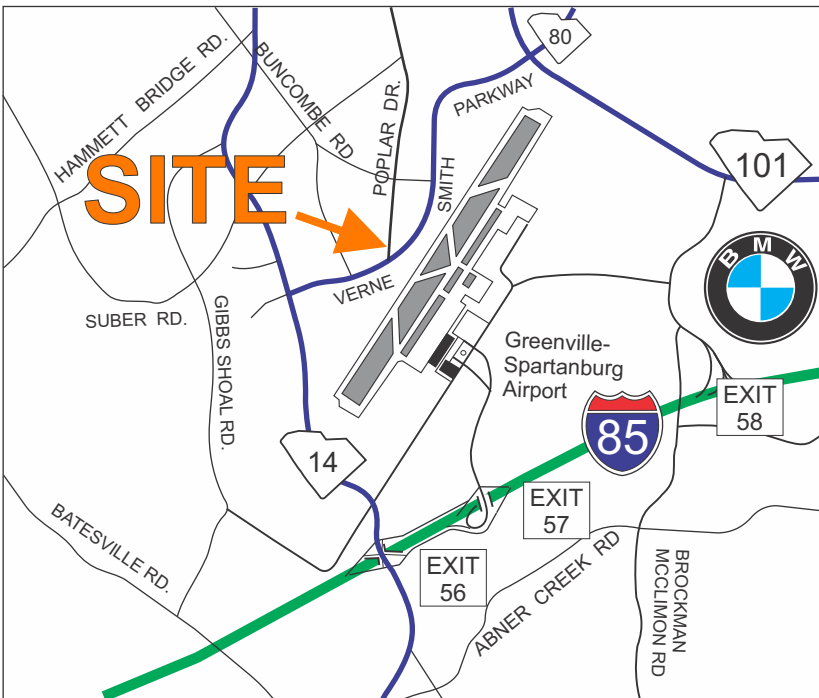

TAX MAP 0529.01-01-013.04

ZONED GREENVILLE COUNTY I1

FENCED YARD

PUBLIC WATER

LEASE RATE:

\$9.50/SF NNN

FOR MORE INFORMATION CONTACT
CHUCK LANGSTON AT 864-230-4302
clangston@langston-black.com

LANGSTON BLACK
REAL ESTATE, INC.

P.O. BOX 2167

GREER, S.C. 29652

BUS: 864-848-9070

416

www.langston-black.com

Every effort has been made to ensure the accuracy of the enclosed data, but we assume no responsibility for errors. All conditions and pricing subject to change without notice.
(LANGSTON-BLACK SITE #416)

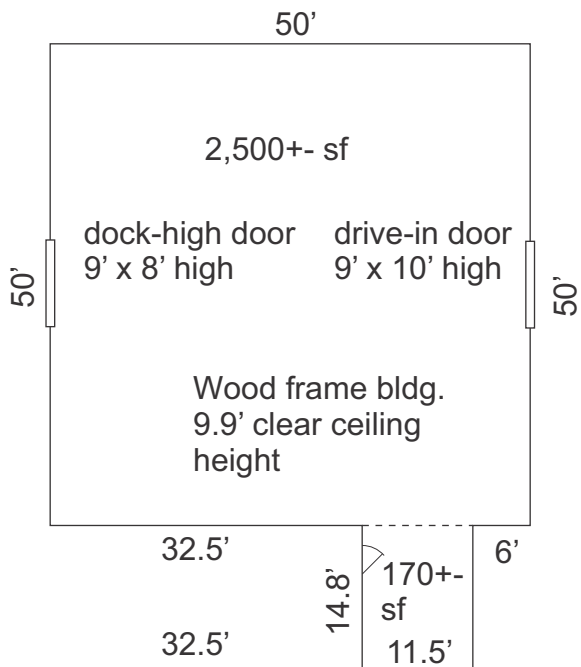

GREAT LOCATION!

- 0.8+- MILE FROM HWY 14
- 2.4+- MILES FROM I-85 (EXIT 57)
- 1.4+- MILES FROM HWY 101
- 3.0+- MILES FROM TRUCK ENTRANCE TO BMW MANUFACTURING

