



Colliers



Medical Office For Lease

Lease Rate:

\$24.00/sf

NNN

Contact:

Rusty Lugo

Vice President
+1 801 947 8377
rusty.lugo@colliers.com

Colliers

111 S. Main St., Suite 2200
Salt Lake City, UT 84111
Main: +1 801 947 8300
colliers.com

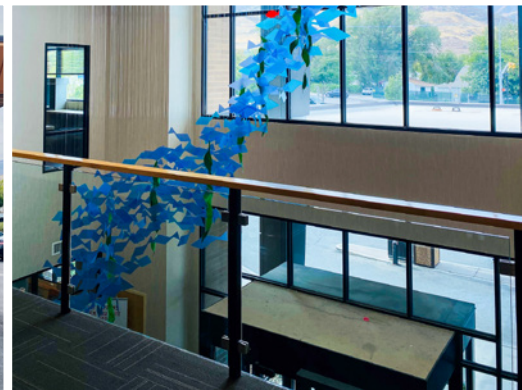

Magna Medical Center

3665 S. 8400 W. | Magna, UT 84044

Property Highlights

- Suite 200 - 1,883 SF
- Class B medical office space
- Modern interior finishes
- Covered patient drop-off
- Abundant parking
- On-site pharmacy
- Beautiful lobby
- Five minutes to SR-201
- **Current tenants include:**
 - Exodus Healthcare Network
 - Oquirrh Mountain Pharmacy
 - Magna Family Eyecare
 - Wasatch Hospice and Home Health
 - Advanced Motion Physical Therapy
 - Loyal Healthcare
 - Genesis Dental
 - Mountain View Sleep Center

Ready to Occupy!

Accelerating success.

Suite offers:

- Large reception with patient seating
- Large exam room with sink
- Small private office
- Two (2) internal restrooms
- Nursing desk
- Four (4) small exam rooms with sinks
- Small break room
- Small server room



Demographics

Within 3 miles

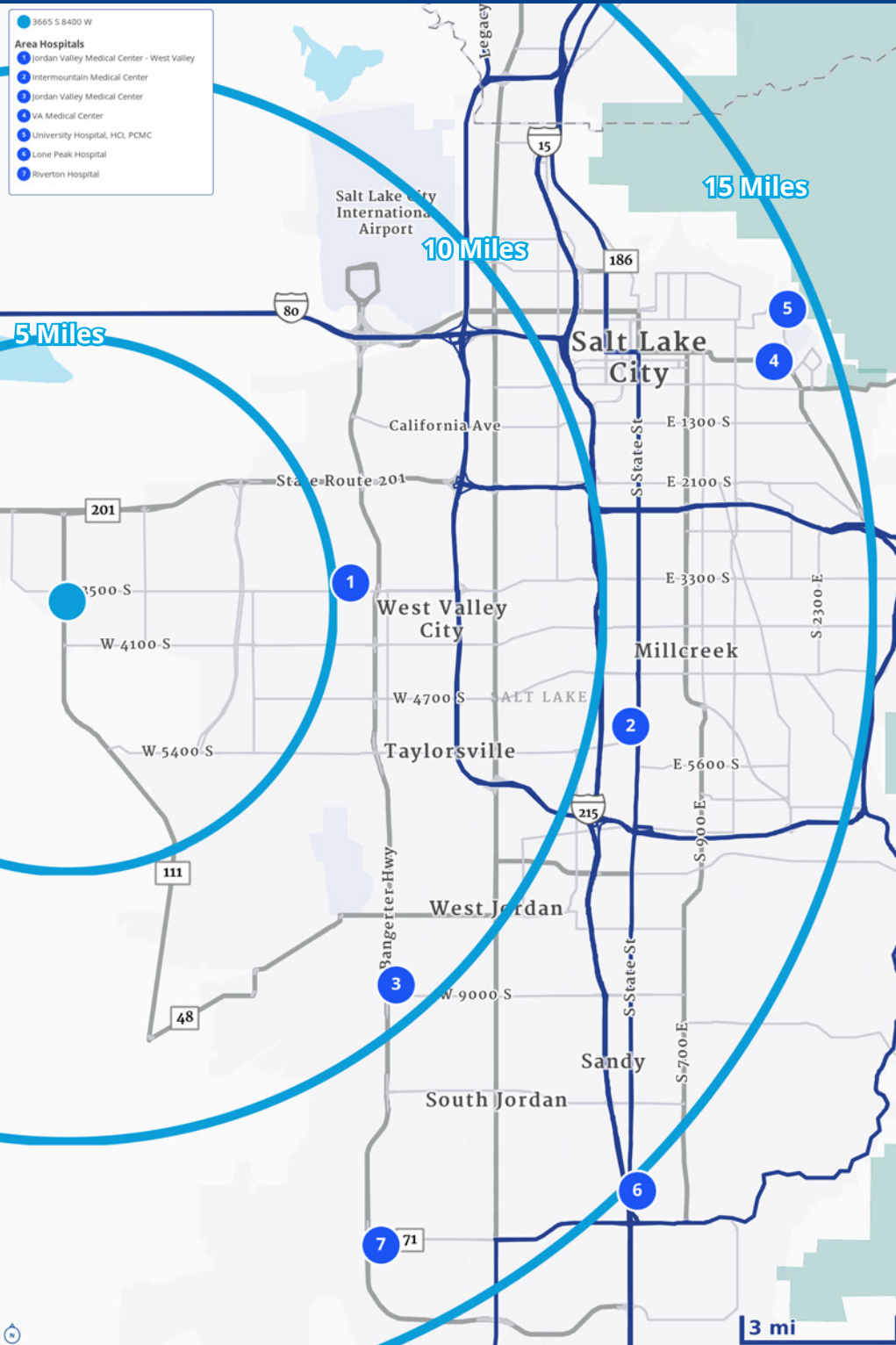

Population

55,184



Median Age

32.0



Average Household Income

\$107,387



Median Household Income

\$94,072



Average Household Size

3.76



Colliers

111 S. Main St., Suite 2200
Salt Lake City, UT 84111
Main: +1 801 947 8300
colliers.com

Rusty Lugo

Vice President
+1 801 947 8377
rusty.lugo@colliers.com