



MID-ATLANTIC
ACQUISITIONS LLC



14049-14083 CROWN COURT | WOODBRIDGE, VA
PRINCE WILLIAM COMMONS BUILDING 2



Property Features

- Rental Rate: Negotiable
- Space Type: Office | Flex | Retail | Warehouse
- Lease Type: NNN
- Date Available: Immediately
- Parking: 3.0 ratio
- Clear Ceiling Height: 24' Warehouse | 9-10' Office
- Column Spacing: 40' Wide x 40' Deep
- Drive In Docks: 10' wide x 12' high
- Amenities Close By
- Signage Available

Ideal location - close to:

- **NOW OPEN!** New State-of-the-Art Assisted Living Facility within Prince William Commons
- **NOW OPEN!!** Park Landing, a new 55+ Living Facility!
- I95 (1.4 miles)
- Prince William Parkway
- Ft. Belvoir
- MCB Quantico
- Sentara Hospital (2 miles)

2018 VDOT traffic volume at Prince William Parkway and Golansky Blvd is 110 K (55 K East & 55 K West).

Traci Morris Cole | 703.328.7884 | tmcole@midacq.com



NOW OPEN!
New State-of-the-Art
Assisted Living Facility



ARBOR TERRACE
prince william commons

NOW OPEN!
New 55+ Living Facility



PARK LANDING

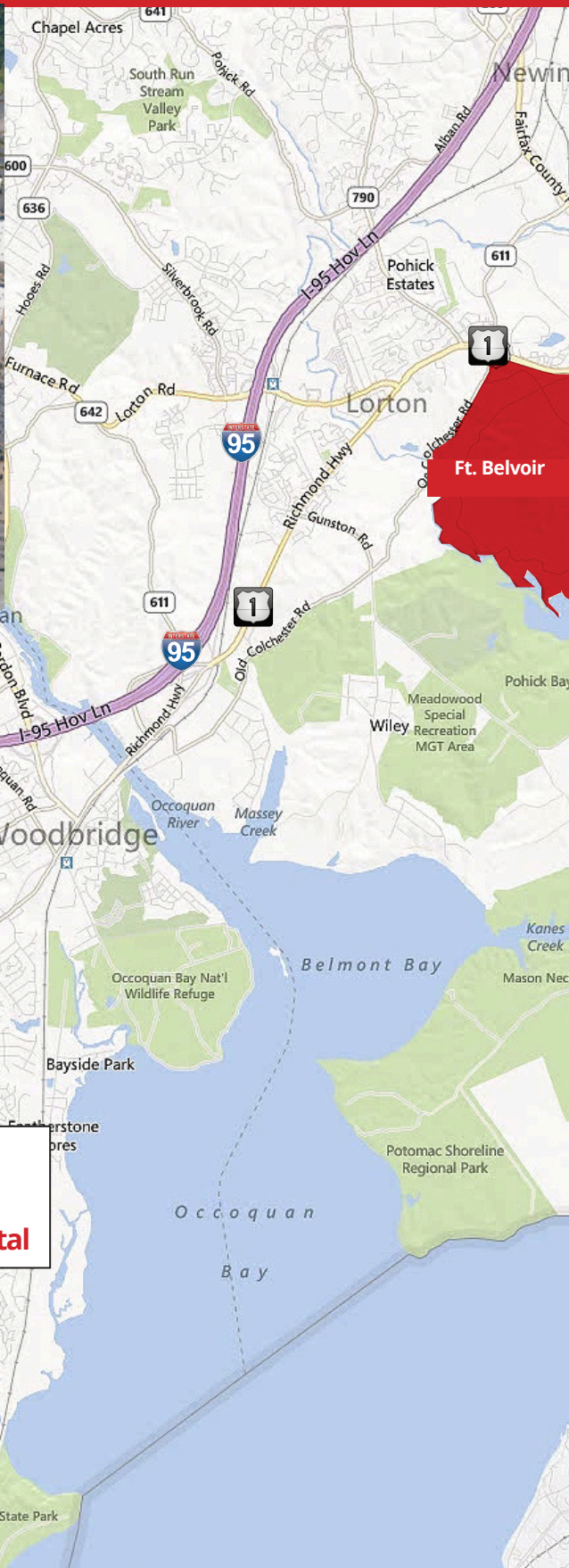

1409-14083 Crown Court



SENTARA
HEALTHCARE
Sentara Hospital



Traci Morris Cole | 703.328.7884 | tmcole@midacq.com

Mezzanine Level

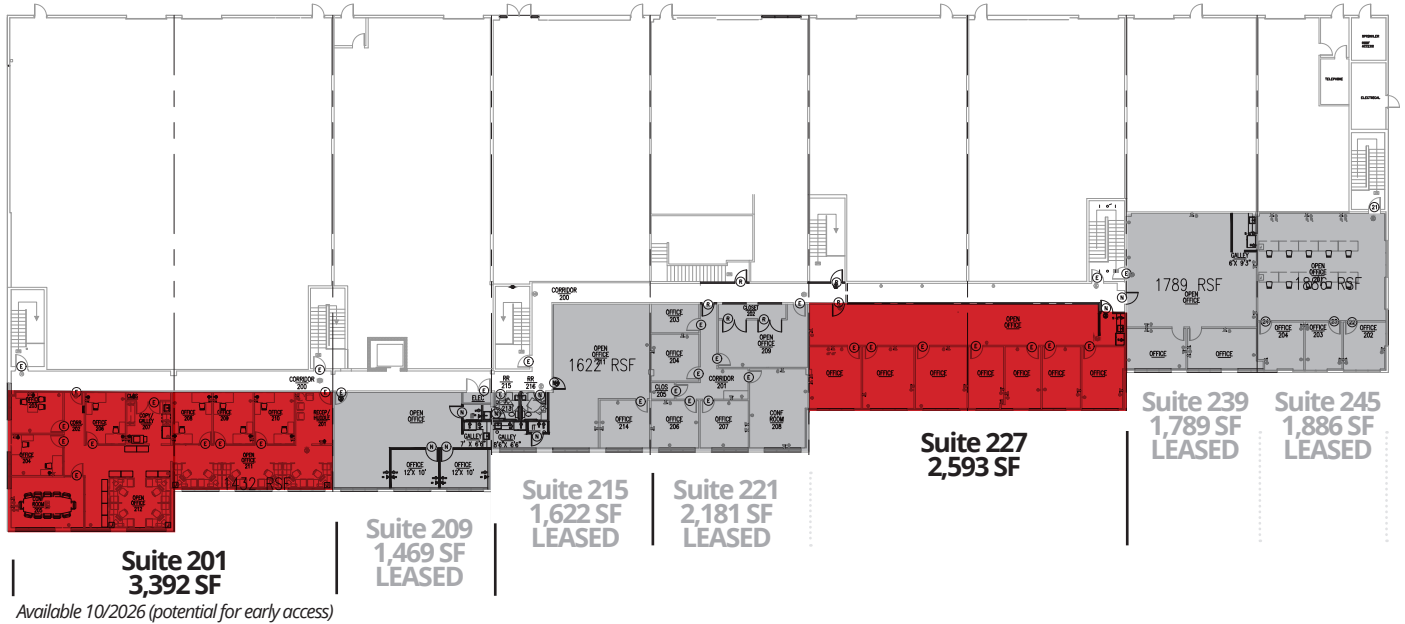

First Floor

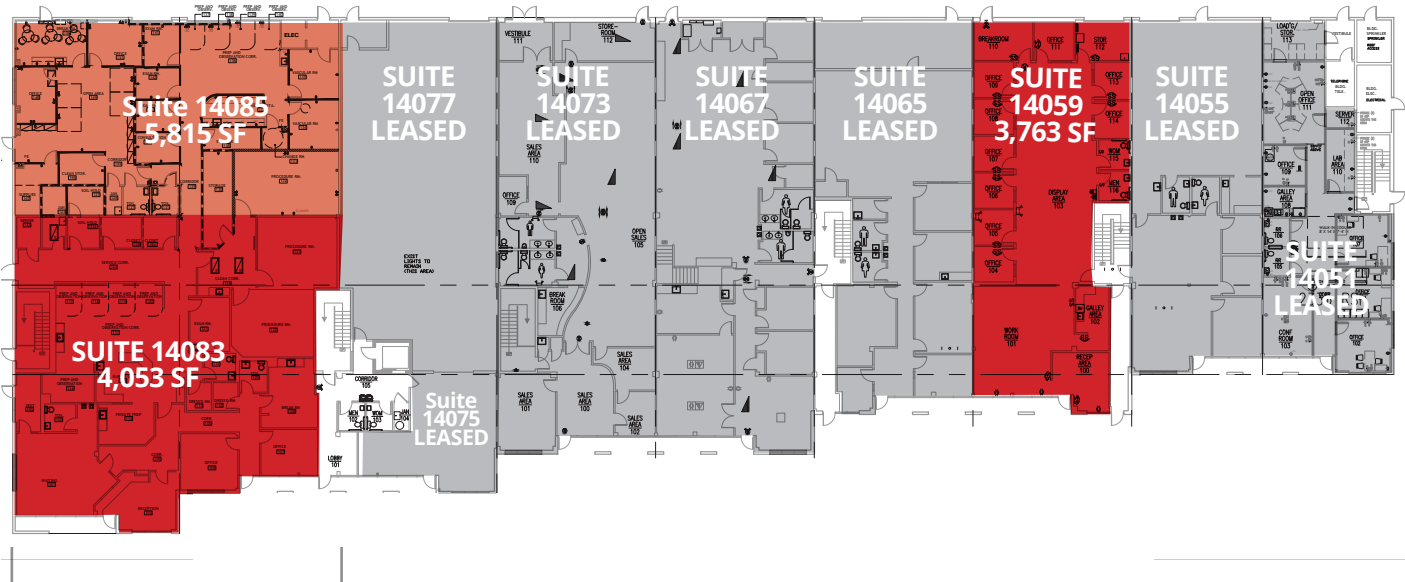

Current combined area is a fully built out medical/surgical space

9,868 SF

Available 10/2026 (potential for early access)

