

±137,700 SF INDUSTRIAL BUILDING AVAILABLE

16222 PHOEBE AVE | LA MIRADA, CA 90638

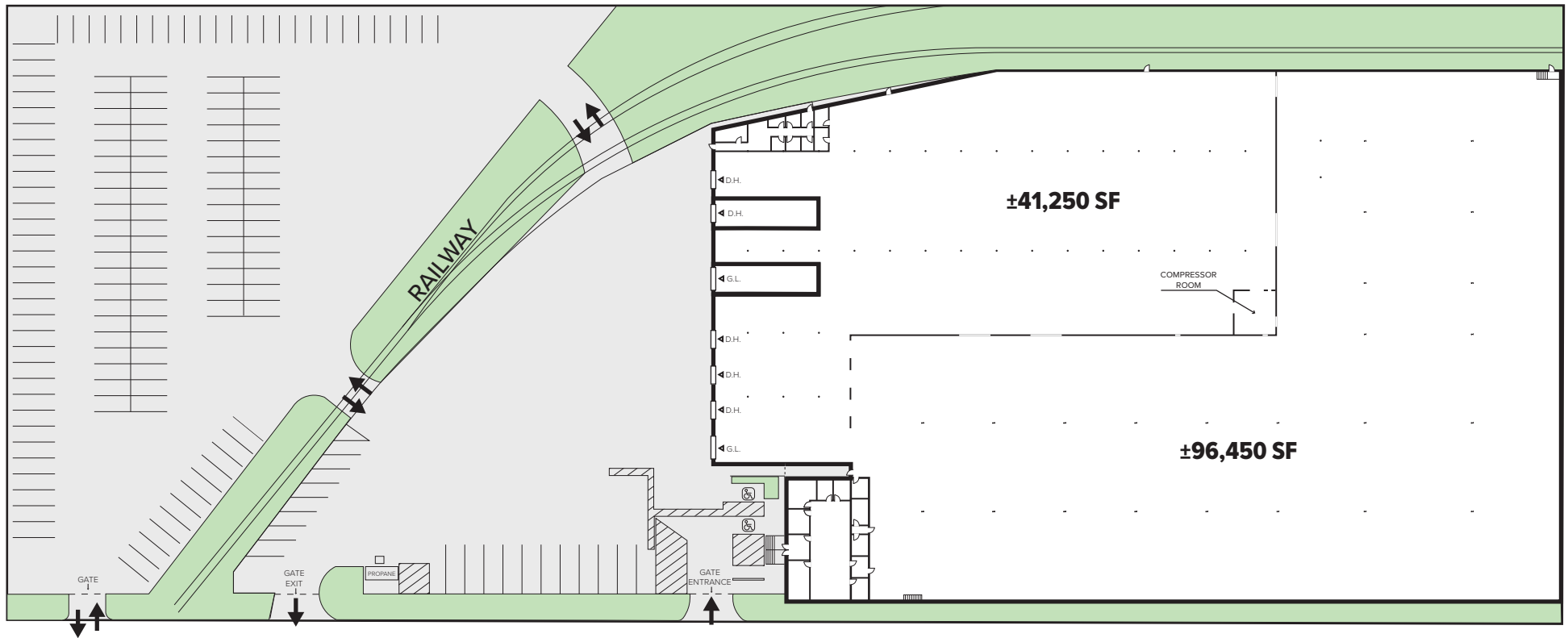

PHOEBE AVE



NOTE: Drawing not to scale. All measurements and sizes are approximate. Please Verify.

FOR MORE INFORMATION, PLEASE CONTACT

JAKE ARELLANO

Senior Vice President | LIC NO 02113094

e jarellano@lee-associates.com
o 562.568.2088

TIM CRONIN, SIOR

Senior Vice President | LIC NO 00916418

e tcronin@lee-associates.com
o 323.767.2088

JACK R. CLINE, JR.

President | LIC NO 00854279

e jcline@lee-associates.com
c 213.590.3512

Team-Cline.com

BRIAN FORSTER

President | LIC NO 01093508

e brian@pacificpartnerscre.com
o 818.862.2774

