

FOR LEASE

23031 ARROYO VISTA
Rancho Santa Margarita, CA 92688

±12,913 SQUARE FEET WITH SHARED YARD



Suite A: ±12,913 SF with ±4,500 SF of Office

PROPERTY FEATURES:

- Large Shared Yard
- Ample Glass Line
- 3:1000 Parking Ratio
- 24' Clearance
- 1 Ground Level loading Door
- 1,200 Amps
- Year Built: 1990
- Adjacent to the 241 Foothill Transportation Corridor

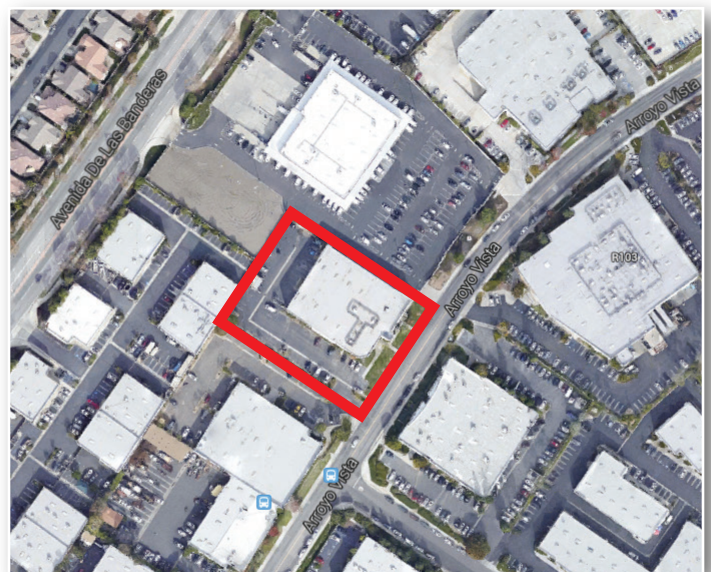

Exclusively Listed By:



MARK JERUE
Senior Vice President
License ID# 01073399
949.790.3121
mjerue@leeirvine.com

CRAIG FITTERER
Senior Vice President
License ID# 01246929
949.790.3123
cfitterer@leeirvine.com

BJ FELL
Senior Vice President
License ID# 01929179
949.790.3144
bfell@leeirvine.com

FOR LEASE

23031 ARROYO VISTA

Rancho Santa Margarita, CA 92688

±12,913 SQUARE FEET WITH SHARED YARD

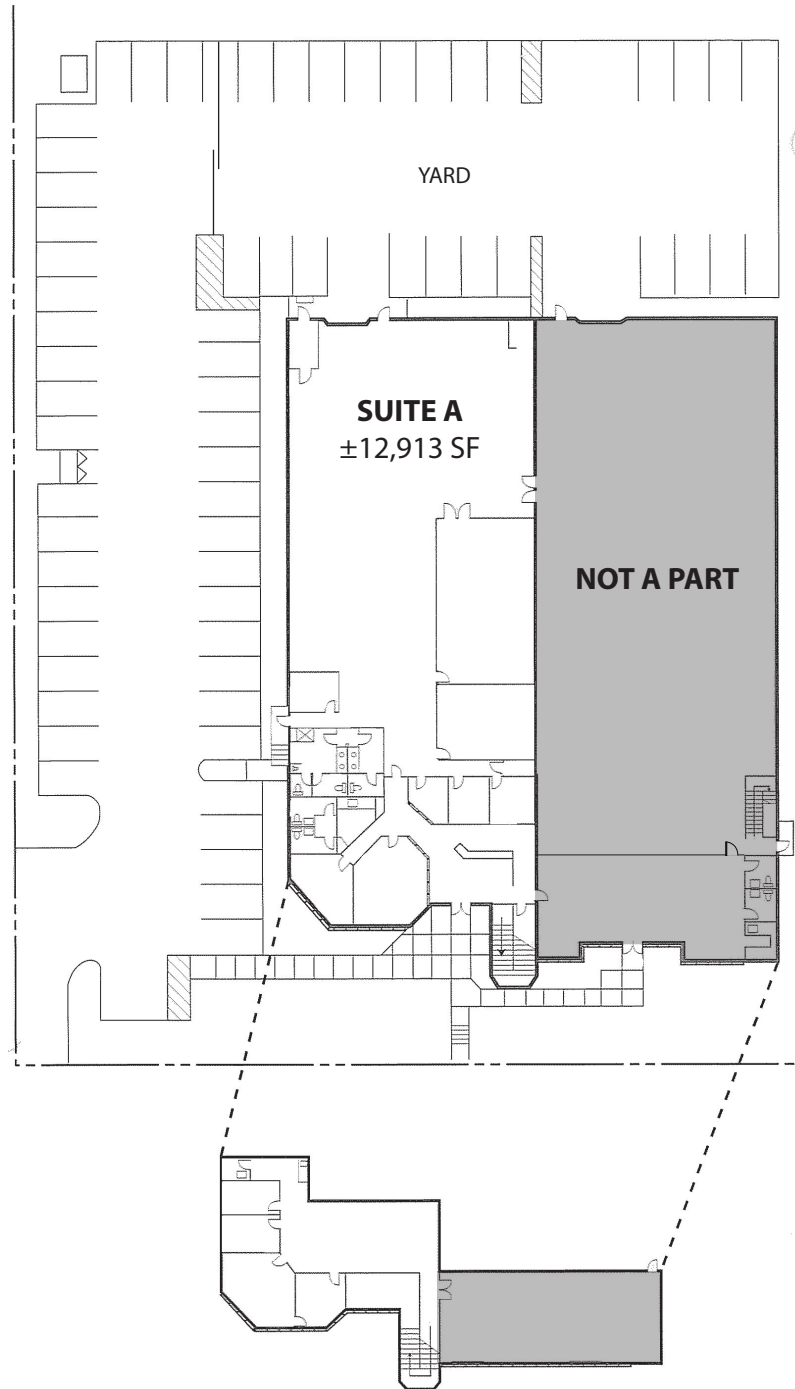

Exclusively Listed By:



MARK JERUE
Senior Vice President
License ID# 01073399
949.790.3121
mjerue@leeirvine.com

CRAIG FITTERER
Senior Vice President
License ID# 01246929
949.790.3123
cfitterer@leeirvine.com

BJ FELL
Senior Vice President
License ID# 01929179
949.790.3144
bfell@leeirvine.com